

FEATURE RECORD

Curles Plantation

44He388

Feature # 55

RECORDED BY B Hyde

DATES _____

Begun _____

Completed _____

TYPE OF FEATURE: Possible base of H shaped fire place

DIMENSIONS:

DEPTHS: Top _____ Bottom _____ BELOW _____

ASSOCIATED E.U. #'s: 2045/46

2045 Description screened gd SW (170N - 162.5E)

2046 Description not screened SE-NE-NW (170N 162.5E)

_____ Description _____

_____ Description _____

_____ Description _____

_____ Description _____

_____ Description _____

_____ Description _____

_____ Description _____

_____ Description _____

_____ Description _____

_____ Description _____

COMMENTS:

Extending from East wall of preience 170N 162.5E
is brick & mortar rubble approx 1 1/2 feet wide,
2 feet long. If cross wae had fire place
this could be part of base

170N
162.5E

GN
↑

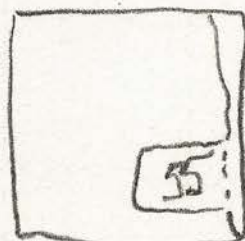

Attach appropriate profile drawings.

FEATURE RECORD

Curles Plantation

44He388

Feature # 5L

RECORDED BY Blyse

DATES _____

TYPE OF FEATURE: Possible pit w/ clay fill intruding on feature 59

DIMENSIONS:

DEPTHS: Top _____ Bottom _____ BELOW _____

ASSOCIATED E.U. #'s: 2009, 2010

<u>2009</u>	Description	<u>sw gd screened (170 N 160 E)</u>
<u>2010</u>	Description	<u>not screened SE, NE, NW (170 N 160 E)</u>
_____	Description	_____
_____	Description	_____
_____	Description	_____
_____	Description	_____
_____	Description	_____
_____	Description	_____
_____	Description	_____
_____	Description	_____
_____	Description	_____
_____	Description	_____
_____	Description	_____
_____	Description	_____

COMMENTS:

Very defined smooth circle in SW corner of provenience. Rest of sq is filled with cobbles and robbers trench - Pit fill is hard packed yellow/brown clay -

170 N 160 E

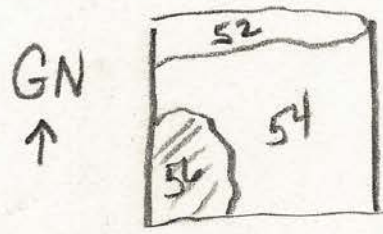

Attach appropriate profile drawings.

FEATURE RECORD

Curles Plantation

44He388

Feature # 57

RECORDED BY Blyde

DATES _____

Begun _____ Completed _____

TYPE OF FEATURE: Possible cross wae of kitchen

DIMENSIONS:

DEPTHS: Top _____ Bottom _____ BELOW _____

ASSOCIATED E.U. #'s: _____

<u>2045</u>	Description	<u>sw gd screened (170N 165E)</u>
<u>2046</u>	Description	<u>not screened SE-NE-NW (170N 165E)</u>
_____	Description	_____
_____	Description	_____
_____	Description	_____
_____	Description	_____
_____	Description	_____
_____	Description	_____
_____	Description	_____
_____	Description	_____
_____	Description	_____
_____	Description	_____
_____	Description	_____
_____	Description	_____

COMMENTS:

West wall of proemene 170N 162.5E is possible cross wae of kitchen - brick, mortar & plaster, rubble

170N
165E

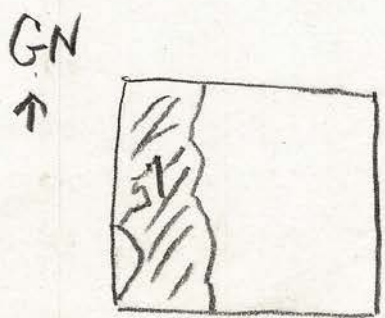

Attach appropriate profile drawings.

FEATURE RECORD

Curles Plantation

44He388

Feature # 58

RECORDED BY Blyde

DATES _____

TYPE OF FEATURE: Possible base of fireplace

Begun _____

Completed _____

DIMENSIONS:

DEPTHS: Top _____ Bottom _____ BELOW _____

ASSOCIATED E.U. #'s:

- 2045 Description sw gd screened (170N-165E)
- 2046 Description not screened SE, NE, NW (170N-165E)
- _____ Description _____
- _____ Description _____
- _____ Description _____
- _____ Description _____
- _____ Description _____
- _____ Description _____
- _____ Description _____
- _____ Description _____
- _____ Description _____
- _____ Description _____
- _____ Description _____
- _____ Description _____

COMMENTS:

Extending from west wall is a pile of bricks
Could be opposite side of fireplace base.

170N
165EE

GN ↑

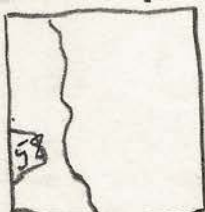

Attach appropriate profile drawings.

FEATURE RECORD

Curles Plantation

44He388

Feature # 59

RECORDED BY Stelly Drummond

DATES 7/27/87
Begun

7/27/87
Completed

TYPE OF FEATURE: BUILDER'S TRENCH

DIMENSIONS: 47 x 20 x 51

DEPTHS: Top _____ Bottom _____ BELOW _____

ASSOCIATED E.U. #'s:

<u>2073</u>	Description	<u>TOP OF FEATURE 5cm BELOW PZ 170N 170E</u>
_____	Description	_____
_____	Description	_____
_____	Description	_____
_____	Description	_____
_____	Description	_____
_____	Description	_____
_____	Description	_____
_____	Description	_____
_____	Description	_____
_____	Description	_____
_____	Description	_____
_____	Description	_____

COMMENTS: THE TOP OF TRENCH CONTAINED THICK MORTAR RUBBLE IN VERY CRUMBLED STATE. DIRT/CLAY FILL BELOW THAT. COFFIN SHARDS LOCATED IN DIRT FILL CREAMWARE SHARD. I DUG AS FAR AS MY ARM COULD REACH. BRICK WALL CONTINUES TO GO DOWN

Attach appropriate profile drawings.

EXCAVATION UNIT RECORD

Curles Plantation

44He388

E.U. # 2073

RECORDED BY SHELLY DRUMMOND

DATES 7/27/87
BEGUN

7/27/87
COMPLETED

TYPE OF UNIT:

- Test pit (no. _____) (attach to Test Pit Record)
- Square (size _____) (attach to Square Record)
- Trench (no. _____) (attach to Trench Record)
- Feature (no. 59) (attach to Feature Record)
- Post hole (no. _____) (attach to Pier/Post Record)
- Post mold (no. _____) (attach to Pier/Post Record)
- Pier (no. _____) (attach to Pier/Post Record)
- Small find (no. _____) (attach to Small Finds Record)

PROVENIENCE: (skip if feature) Exact Square

(SW corner) 170 N 170 E

DEPTHS: Top _____ Bottom _____ BELOW _____

STRATUM _____ LEVEL _____

SOIL DESCRIPTION: MORTAR FILL W/ BRICK PIECES, CRUMBLY AND GRADUALLY, BECOMING A DIRT FILL DEEPER DOWN. CLAY

EXCAVATED BY: Trowel Shovel Screened

SAMPLES TAKEN:

- Soil (no. _____)
- Constant Volume (no. _____)

COMMENTS:

BORDER TRENCH
 FEATURE 59 FILL IN 170N170E TAKEN OUT
 AS A UNIT WITHOUT DIFFERENTIATED STRATIGRAPHY
 UNIT BEGINS 5CM BELOW P2

Attach appropriate level drawings.

FEATURE RECORD

Curles Plantation

44He388

Feature # 600

RECORDED BY Blyde

DATES _____ Begun _____ Completed _____

TYPE OF FEATURE: Brick foundation wall of Kitchen East/South section

DIMENSIONS:

DEPTHS: Top _____ Bottom _____ BELOW _____

ASSOCIATED E.U. #'s: 2021/16 - 2021/15 - 2021/14 - 2021/12 - 2031/12

<u>2029</u>	Description	<u>sw qd screened</u>	<u>(170 N - 170E)</u>
<u>2030</u>	Description	<u>not screened SE, NE, NW</u>	
<u>2051</u>	Description	<u>sw qd screened</u>	<u>(167.5 N - 170E)</u>
<u>2052</u>	Description	<u>not screened SE, NE, NW</u>	
<u>2033</u>	Description	<u>sw qd screened</u>	<u>(165 N - 170E)</u>
<u>2034</u>	Description	<u>not screened SE, NE, NW</u>	
<u>2021</u>	Description	<u>sw qd screened SE, NE, NW</u>	<u>(165 N - 165E)</u>
<u>2022</u>	Description	<u>not screened SE, NE, NW</u>	
<u>2031</u>	Description	<u>sw qd screened</u>	<u>(165 N - 162.5E)</u>
<u>2032</u>	Description	<u>not screened SE, NE, NW</u>	
_____	Description	<u>sw qd screened</u>	
_____	Description	<u>not screened SE, NE, NW</u>	

COMMENTS:

170N 170E

167.5N 170E

165 N 170E

165 N 165E

165 N 162.5E

This feature continues thru 5 provenienses corner (SE) in 165N - 170E. As it passes thru 165N - 165E (East - west direction) it has gaps in upper level of brickwork - In proveniense 165N 162.5E wall becomes Robber trench and disappears from view.

GN ↑

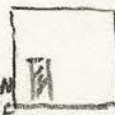

Attach appropriate profile drawings.



X

FEATURE RECORD

Curles Plantation

44He388

Feature # 61

RECORDED BY Bhyde

DATES _____

TYPE OF FEATURE: distruction rubble Begun _____ Completed _____

DIMENSIONS:

DEPTHS: Top _____ Bottom _____ BELOW _____

ASSOCIATED E.U. #'s: 2051/52

2051 Description sw gd screened (167.5N 170E)

2052 Description not screened SE-NE-NW (167.5N 170E)

_____ Description _____

_____ Description _____

_____ Description _____

_____ Description _____

_____ Description _____

_____ Description _____

_____ Description _____

_____ Description _____

_____ Description _____

_____ Description _____

COMMENTS:

167.5 N 170 E North wall of ground filled with packed rubble, brick, stone -



Attach appropriate profile drawings.

FEATURE RECORD

Curles Plantation

44He388

Feature # 62

RECORDED BY Blyde DATES _____

Begun _____ Completed _____

TYPE OF FEATURE: Curved area of stones - possible post hole - or path

DIMENSIONS:

DEPTHS: Top _____ Bottom _____ BELOW _____

ASSOCIATED E.U. #'s: 2033/4

2033 Description swgd screened (165N 170E)

2034 Description not screened SE, NE, NW (165N 170E)

_____ Description _____

_____ Description _____

_____ Description _____

_____ Description _____

_____ Description _____

_____ Description _____

_____ Description _____

_____ Description _____

_____ Description _____

_____ Description _____

COMMENTS:

165N-170E

Slightly circular formation of large stones
off corner of basement wall,
Form curve around possible post hole
or could be a path

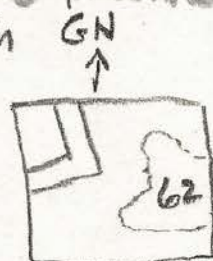

Attach appropriate profile drawings.

FEATURE RECORD

Curles Plantation

44He388

Feature # 63

RECORDED BY Blythe

DATES _____

Begun _____ Completed _____

TYPE OF FEATURE:

DIMENSIONS:

DEPTHS: Top _____ Bottom _____ BELOW _____

ASSOCIATED E.U. #'s: 2033/34

2033 Description sw qd screened (160N-170E)

2034 Description not screened SE-NE-NW (160N-170E)

_____ Description _____

_____ Description _____

_____ Description _____

_____ Description _____

_____ Description _____

_____ Description _____

_____ Description _____

_____ Description _____

_____ Description _____

_____ Description _____

COMMENTS:

160 N 170E

Mound of rubble-brick, mortar - from
distraction of kitchen wares?

GN ↑



Attach appropriate profile drawings.

FEATURE RECORD

Curles Plantation

44He388

Feature # 64

RECORDED BY Blyde

DATES _____

Begun _____

Completed _____

TYPE OF FEATURE: Possible rubble from robbers trench in sq 2035/36 - Providence 160N-170E

DIMENSIONS:

DEPTHS: Top _____ Bottom _____ BELOW _____

ASSOCIATED E.U. #'s: 2033/34

2033 Description sw gd screened (165N/170E)

2034 Description not screened SE-NE-NW (165N/170E)

_____ Description _____

_____ Description _____

_____ Description _____

_____ Description _____

_____ Description _____

_____ Description _____

_____ Description _____

_____ Description _____

_____ Description _____

_____ Description _____

COMMENTS:

165N 170E Possible continuation of rubble from robbers trench in sq 2035/36, Providence 160N 170E
Ground slopes downward, has deposits of rubble-hard clay.



Attach appropriate profile drawings.

FEATURE RECORD

Curles Plantation

44He388

Feature # 65

RECORDED BY Blythe

DATES _____

TYPE OF FEATURE: Distruaction rubble from kitchen wace?
Begun _____ Completed _____

DIMENSIONS:

DEPTHS: Top _____ Bottom _____ BELOW _____

ASSOCIATED E.U. #'s: 2021/22

- 2021 Description sw gd screened (165N/165E)
- 2022 Description Not screened SE, NE, NW (165N/165E)
- _____ Description _____
- _____ Description _____
- _____ Description _____
- _____ Description _____
- _____ Description _____
- _____ Description _____
- _____ Description _____
- _____ Description _____
- _____ Description _____
- _____ Description _____
- _____ Description _____

COMMENTS:

165N 165E On south side of basement wace is a distruaction pile of brick, mortar & compact clay from kitchen wace
Possible rubble GN



Attach appropriate profile drawings.

FEATURE RECORD

Curles Plantation

44He388

Feature #

66

RECORDED BY Bob Book

DATES July 28 '87

Begun

Completed

TYPE OF FEATURE: Possible trench - dark stain

DIMENSIONS:

DEPTHS: Top

Bottom

BELOW PZ

ASSOCIATED E.U. #'s:

<u>2065</u>	Description	<u>SW quad - screened</u>
<u>2066</u>	Description	<u>SE NE NW quads - unscreened</u>
<u>F82</u>	Description	<u>Dark organic soil (base) with brick pieces</u>
	Description	
	Description	
	Description	
	Description	
	Description	
	Description	
	Description	
	Description	
	Description	
	Description	

COMMENTS:

North/South oriented - possibly parallel to kitchen end wall.
 ~50cm wide 1.5m long (possibly longer - bank intrudes into the square)
 a few fragments of brick scattered throughout. Large brick pieces at north end. (from F82?)
 Soil is dark, organic - depth unknown

Attach appropriate profile drawings.

FEATURE RECORD

Curles Plantation

44He388

Feature # 67

RECORDED BY Blythe DATES _____

Begun _____ Completed _____

TYPE OF FEATURE: DISTRIBUTION rubble from cross wall of Kitchen

DIMENSIONS:

DEPTHS: Top _____ Bottom _____ BELOW _____

ASSOCIATED E.U. #'s: 2031/32

2031 Description 3w gd screened (165 N/162.5E)

2032 Description not screened SE, NE, NW (165 N/162.5E)

_____ Description _____

_____ Description _____

_____ Description _____

_____ Description _____

_____ Description _____

_____ Description _____

_____ Description _____

_____ Description _____

_____ Description _____

_____ Description _____

COMMENTS:

On SE corner of sq pile of brick, stone-fire brick leaning on basement wall & extending to edge of sq distribution from cross wall

165 N 162.5E



Attach appropriate profile drawings.

FEATURE RECORD

Curles Plantation

44He388

Feature # 68

RECORDED BY Blyde

DATES _____

TYPE OF FEATURE: lg area of mortar, brick over basement wace
Robbers trench?

Begun _____

Completed _____

DIMENSIONS:

DEPTHS: Top _____ Bottom _____ BELOW _____

ASSOCIATED E.U. #'s: 2013/14

<u>2013</u>	Description	<u>sw gd screened</u>	<u>(165 N / 162.5 E)</u>
<u>2014</u>	Description	<u>not screened SE, NE, NW</u>	<u>(165 N / 162.5 E)</u>
_____	Description	_____	_____
_____	Description	_____	_____
_____	Description	_____	_____
_____	Description	_____	_____
_____	Description	_____	_____
_____	Description	_____	_____
_____	Description	_____	_____
_____	Description	_____	_____
_____	Description	_____	_____
_____	Description	_____	_____
_____	Description	_____	_____
_____	Description	_____	_____

COMMENTS:

165 N 162.5 E Large area (1/3 of sq) filled w/ mortar & brick.
Concentration of brick at south wace of sq
Possible Robbers trench

GNA

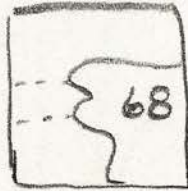

Attach appropriate profile drawings.

FEATURE RECORD

Curles Plantation

44He388

Feature # 69

RECORDED BY Bhyde

DATES _____

TYPE OF FEATURE:

Robbers Trench to old celler wall - continues into T 87A 157.5N/160 N

Begun _____

Completed _____

DIMENSIONS:

DEPTHS: Top _____ Bottom _____ BELOW _____

ASSOCIATED E.U. #'s: 2035/36

2035 Description SW qd SCREENED (160N 170E)

2036 Description NOT SCREENED SE, NW, NE (160N 170E)

_____ Description _____

_____ Description _____

_____ Description _____

_____ Description _____

_____ Description _____

_____ Description _____

_____ Description _____

_____ Description _____

_____ Description _____

_____ Description _____

COMMENTS:

160N 170E

Trench with path thru middle - breaks thru brick wall
Continues in T 87A.

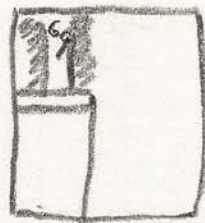

GN
↑

Attach appropriate profile drawings.

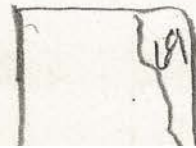

FEATURE RECORD

Curles Plantation

44He388

Feature # 70

RECORDED BY Blythe DATES _____

TYPE OF FEATURE: Brick Wall of old celler Begun _____ Completed _____

DIMENSIONS:

DEPTHS: Top _____ Bottom _____ BELOW _____

ASSOCIATED E.U. #'s: 2035/36

2035 Description sw qd screened (160N 170E)

2036 Description not screened SE NE NW (160N-170E)

_____ Description _____

_____ Description _____

_____ Description _____

_____ Description _____

_____ Description _____

_____ Description _____

_____ Description _____

_____ Description _____

_____ Description _____

_____ Description _____

COMMENTS:

160N 170E

Brick wall - broken at top by robbers trench
appx 12 bricks in height.

Attach appropriate profile drawings.

FEATURE RECORD

Curles Plantation

44He388

Feature # 71

RECORDED BY Blyde

DATES _____

TYPE OF FEATURE: Dark stain on clay floor of old celler Begun _____ Completed _____

DIMENSIONS:

DEPTHS: Top _____ Bottom _____ BELOW _____

ASSOCIATED E.U. #'s: 2035/36

- 2035 Description sw qt screened (160N 170E)
- 2036 Description not screened SE, NE, NW (160N 170E)
- _____ Description _____
- _____ Description _____
- _____ Description _____
- _____ Description _____
- _____ Description _____
- _____ Description _____
- _____ Description _____
- _____ Description _____
- _____ Description _____
- _____ Description _____
- _____ Description _____

COMMENTS:

160N 170E Circle dark stain on floor of old celler

Attach appropriate profile drawings.

FEATURE RECORD

Curles Plantation

44He388

Feature # 72

RECORDED BY Blyde DATES _____

TYPE OF FEATURE: _____ Begun _____ Completed _____

Brick wall - EAST section of old cellar
Includes Trench 87B - 172.5E / 175E

DIMENSIONS:

DEPTHS: Top _____ Bottom _____ BELOW _____

ASSOCIATED E.U. #'s: 2054/55

- 2054 Description Sw gd screened (155N 170E)
- 2056 Description not screened SE, NE, NW (155N 170E)
- 2078 Description not screened SW, SE, NE, NW
- _____ Description _____
- _____ Description _____
- _____ Description _____
- _____ Description _____
- _____ Description _____
- _____ Description _____
- _____ Description _____
- _____ Description _____
- _____ Description _____

COMMENTS:

155N 170E
Brick wall - approx 10 bricks high - wall to old cellar?
Includes trench 87B 172.5E - 175E - Brick wall east end of cellar

FEATURE RECORD

Curles Plantation

44He388

Feature # 73

RECORDED BY Bhyde DATES _____

Begun _____ Completed _____

TYPE OF FEATURE: Tile Floor - old cellar

DIMENSIONS:

DEPTHS: Top _____ Bottom _____ BELOW _____

ASSOCIATED E.U. #'s: 2054/55

2054 Description sw gd screened (155 N 170 E)

2055 Description not screened SE, NE, NW (155 N 170 E)

_____ Description _____

_____ Description _____

_____ Description _____

_____ Description _____

_____ Description _____

_____ Description _____

_____ Description _____

_____ Description _____

_____ Description _____

_____ Description _____

COMMENTS:

155 N 170 E Beautiful tile floor

Attach appropriate profile drawings.

FEATURE RECORD

Curles Plantation

44He388

Feature # 74

RECORDED BY Bluyde

DATES _____

TYPE OF FEATURE: Possible pit line across SE corner of EU 2023/34
Begun _____ Completed _____

DIMENSIONS:

DEPTHS: Top _____ Bottom _____ BELOW _____

ASSOCIATED E.U. #'s:

- 2023 Description swgd screened (160N 165E)
- 2024 Description not screened SE, NE, NW (160N 165E)
- _____ Description _____
- _____ Description _____
- _____ Description _____
- _____ Description _____
- _____ Description _____
- _____ Description _____
- _____ Description _____
- _____ Description _____
- _____ Description _____
- _____ Description _____
- _____ Description _____

COMMENTS:

Rubble below plow zone in clay - dark stain - brick mortar etc possible pit

GN↑

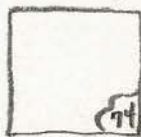

Attach appropriate profile drawings.