

FEATURE RECORD

Curles Plantation

44He388

Feature # 88-62

RECORDED BY Shelly

DATES JULY 1988  
Begun \_\_\_\_\_ Completed \_\_\_\_\_

TYPE OF FEATURE: p-hole

DIMENSIONS:

DEPTHS: Top \_\_\_\_\_ Bottom \_\_\_\_\_ BELOW \_\_\_\_\_

ASSOCIATED E.U. #'s:

- 3113<sup>e</sup> Description SMALL POST HOLE IN PROFILE OF F88-21
- \_\_\_\_\_ Description \_\_\_\_\_
- \_\_\_\_\_ Description \_\_\_\_\_
- \_\_\_\_\_ Description \_\_\_\_\_
- \_\_\_\_\_ Description \_\_\_\_\_
- \_\_\_\_\_ Description \_\_\_\_\_
- \_\_\_\_\_ Description \_\_\_\_\_
- \_\_\_\_\_ Description \_\_\_\_\_
- \_\_\_\_\_ Description \_\_\_\_\_
- \_\_\_\_\_ Description \_\_\_\_\_
- \_\_\_\_\_ Description \_\_\_\_\_
- \_\_\_\_\_ Description \_\_\_\_\_
- \_\_\_\_\_ Description \_\_\_\_\_
- \_\_\_\_\_ Description \_\_\_\_\_

COMMENTS:

THE POSTHOLE WAS SMALL AND FILLED W/ LIGHTER GRANGE BRICK AND MORTAR. IT WAS FIRST NOTICED IN THE PROFILE BEING DIFFICULT TO SPOT FROM SURFACE. NEVER EXCAVATED, THIS FEATURE HAS PROBABLY BEEN ANNIHILATED THROUGH EROSION. THE P-HOLE IS POSSIBLY FROM SCAFFOLDING IN <sup>THE</sup> CONSTRUCTION OF KITCHEN

Attach appropriate profile drawings.

FEATURE RECORD

Curles Plantation

44He388

Feature # 88-63

RECORDED BY Shelly

DATES \_\_\_\_\_  
Begun \_\_\_\_\_ Completed \_\_\_\_\_

TYPE OF FEATURE: top clay fill in kitchen

DIMENSIONS:

DEPTHS: Top \_\_\_\_\_ Bottom \_\_\_\_\_ BELOW \_\_\_\_\_

ASSOCIATED E.U. #'s:

- 3114 Description \_\_\_\_\_
- \_\_\_\_\_ Description \_\_\_\_\_
- \_\_\_\_\_ Description \_\_\_\_\_
- \_\_\_\_\_ Description \_\_\_\_\_
- \_\_\_\_\_ Description \_\_\_\_\_
- \_\_\_\_\_ Description \_\_\_\_\_
- \_\_\_\_\_ Description \_\_\_\_\_
- \_\_\_\_\_ Description \_\_\_\_\_
- \_\_\_\_\_ Description \_\_\_\_\_
- \_\_\_\_\_ Description \_\_\_\_\_
- \_\_\_\_\_ Description \_\_\_\_\_
- \_\_\_\_\_ Description \_\_\_\_\_
- \_\_\_\_\_ Description \_\_\_\_\_

COMMENTS:

THE PROFILE IN F 88-21 REVEALS A CLAY FILL EVENLY LAID IN THE EASTERN HALF OF THE KITCHEN AND IS PROBABLY A CLAY FLOOR

Attach appropriate profile drawings.

FEATURE RECORD

Curles Plantation

44He388

Feature # 88-64

RECORDED BY Shelly

DATES \_\_\_\_\_ Begun \_\_\_\_\_ Completed \_\_\_\_\_

TYPE OF FEATURE: ~~Subsoil layer~~ FARWER SURFACE LAYER (SUBSOIL?) TOPPED W/ A THIN CHARCOAL LAYER

DIMENSIONS: ~~1.5m x 1.5m x 1.5m~~

DEPTHS: Top \_\_\_\_\_ Bottom \_\_\_\_\_ BELOW \_\_\_\_\_

ASSOCIATED E.U. #'s:

- 3115 Description \_\_\_\_\_
- \_\_\_\_\_ Description \_\_\_\_\_
- \_\_\_\_\_ Description \_\_\_\_\_
- \_\_\_\_\_ Description \_\_\_\_\_
- \_\_\_\_\_ Description \_\_\_\_\_
- \_\_\_\_\_ Description \_\_\_\_\_
- \_\_\_\_\_ Description \_\_\_\_\_
- \_\_\_\_\_ Description \_\_\_\_\_
- \_\_\_\_\_ Description \_\_\_\_\_
- \_\_\_\_\_ Description \_\_\_\_\_
- \_\_\_\_\_ Description \_\_\_\_\_
- \_\_\_\_\_ Description \_\_\_\_\_
- \_\_\_\_\_ Description \_\_\_\_\_
- \_\_\_\_\_ Description \_\_\_\_\_

COMMENTS:

POSSIBLY FARWER SURFACE LAYER TOPPED W/ A THIN CHARCOAL LAYER UNDERNEATH THE CLAY FILL (FLOOR?) OF HUTCHES, VISIBLE IN PROFILE F 88-21

Attach appropriate profile drawings.

EXCAVATION UNIT RECORD

Curles Plantation

44He388

E.U. # 3081

RECORDED BY Becky Wirt, Lenore DATES 6-27

BEGUN

COMPLETED

TYPE OF UNIT:

\_\_\_ Test pit (no. \_\_\_\_\_) (attach to Test Pit Record)

\_\_\_ Square (size \_\_\_\_\_) (attach to Square Record)

\_\_\_ Trench (no. \_\_\_\_\_) (attach to Trench Record)

Feature (no. F65) (attach to Feature Record)

\_\_\_ Post hole (no. \_\_\_\_\_) (attach to Pier/Post Record)

\_\_\_ Post mold (no. \_\_\_\_\_) (attach to Pier/Post Record)

\_\_\_ Pier (no. \_\_\_\_\_) (attach to Pier/Post Record)

(old series)

PROVENIENCE: (skip if feature) \_\_\_ Exact \_\_\_ Square

(SW corner) 165 N 167.5 E

DEPTHS: Top \_\_\_\_\_ Bottom \_\_\_\_\_ BELOW \_\_\_\_\_

STRATUM \_\_\_\_\_ LEVEL \_\_\_\_\_

E.U.s ABOVE \_\_\_\_\_

E.U.s BELOW 3099

CORRELATED E.U.s \_\_\_\_\_

SOIL DESCRIPTION: yellow + black mottled clay containing brick + mortar rubble. Gray mortar + rubble layer. yellow clay layer 1-2". Gravel + ceramics in dark brown soil.

EXCAVATED BY:  Trowel  Shovel \_\_\_ Screened

SAMPLES TAKEN:

\_\_\_ Soil (no. \_\_\_\_\_)

\_\_\_ Constant Volume (no. \_\_\_\_\_)

COMMENTS: Brick + mortar rubble along F65 wall contains ash, charcoal, bone, teeth. Unusual amount of wood all at depth of base of 2nd brick. Many nails. Pulled: wood, clinched nails, brick with wood attached and metal lid with handle, rim and #10.

Attach appropriate level drawings.

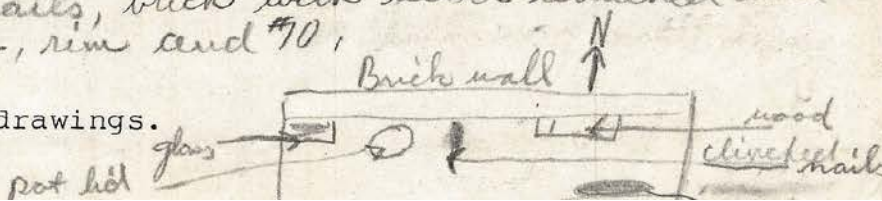

EXCAVATION UNIT RECORD

Curles Plantation

44He388

E.U. # 3081

RECORDED BY John + Kirk

DATES 5/20

BEGUN

COMPLETED

TYPE OF UNIT: see comments

     Test pit (no.         ) (attach to Test Pit Record)

     Square (size         ) (attach to Square Record)

     Trench (no.         ) (attach to Trench Record)

Feature (no. 65) (attach to Feature Record)

     Post hole (no.         ) (attach to Pier/Post Record)

     Post mold (no.         ) (attach to Pier/Post Record)

     Pier (no.         ) (attach to Pier/Post Record)

PROVENIENCE: (skip if feature)      Exact      Square

(SW corner)          N          E

DEPTHS: Top          Bottom          BELOW         

STRATUM          LEVEL         

E.U.s ABOVE                                                               

E.U.s BELOW                                                               

CORRELATED E.U.s                                                               

SOIL DESCRIPTION:

EXCAVATED BY:      Trowel      Shovel      Screened

SAMPLES TAKEN:

     Soil (no.         )

     Constant Volume (no.         )

COMMENTS: That portion of F65 in sq 165N 167.5E (approx)

Attach appropriate level drawings.

EXCAVATION UNIT RECORD

Curles Plantation

44He388

E.U. # 3099

RECORDED BY Betsy Wirt, Lenoir

DATES June 29, 1988 July 1, 1988  
BEGUN COMPLETED

TYPE OF UNIT:

- Test pit (no. \_\_\_\_\_) (attach to Test Pit Record)
- Square (size \_\_\_\_\_) (attach to Square Record)
- Trench (no. \_\_\_\_\_) (attach to Trench Record)
- Feature (no. ~~\_\_\_\_\_~~) (attach to Feature Record)
- Post hole (no. \_\_\_\_\_) (attach to Pier/Post Record)
- Post mold (no. \_\_\_\_\_) (attach to Pier/Post Record)
- Pier (no. \_\_\_\_\_) (attach to Pier/Post Record)

actually  
3" or 18cm  
lower  
along F-65  
to bottom  
of 5th  
brick

3cm arbitrary level under F-65 165N 167.5E

PROVENIENCE: (skip if feature)  Exact  Square

(SW corner) \_\_\_\_\_ N \_\_\_\_\_ E

DEPTHS: Top \_\_\_\_\_ Bottom \_\_\_\_\_ BELOW \_\_\_\_\_

STRATUM \_\_\_\_\_ LEVEL \_\_\_\_\_

E.U.s ABOVE 3081 \_\_\_\_\_

E.U.s BELOW \_\_\_\_\_

CORRELATED E.U.s \_\_\_\_\_

SOIL DESCRIPTION: Dark brown mottled with some rubble.

EXCAVATED BY:  Trowel  Shovel  Screened

SAMPLES TAKEN:

Soil (no. \_\_\_\_\_)

Constant Volume (no. \_\_\_\_\_)

COMMENTS:

Six post molds seen in floor along south wall of the squares (165N 165E) (165N 167.5E).

Pulled: metal comb or tool + copper button

Attach appropriate level drawings.  
Other artifacts: piece Ralph Shaw (?) fine red ware, overlaid porcelain, local river stone, ...

wine bottle sherds, pearlware, annular pearlware,  
hand painted pearlware, debased scratch blue, Benish  
salt glazed stoneware, creamware, nails, tiles,  
window glass, bones + teeth, whole oyster shells,  
plaster + mortar.

37 cm down

↑ Grid north

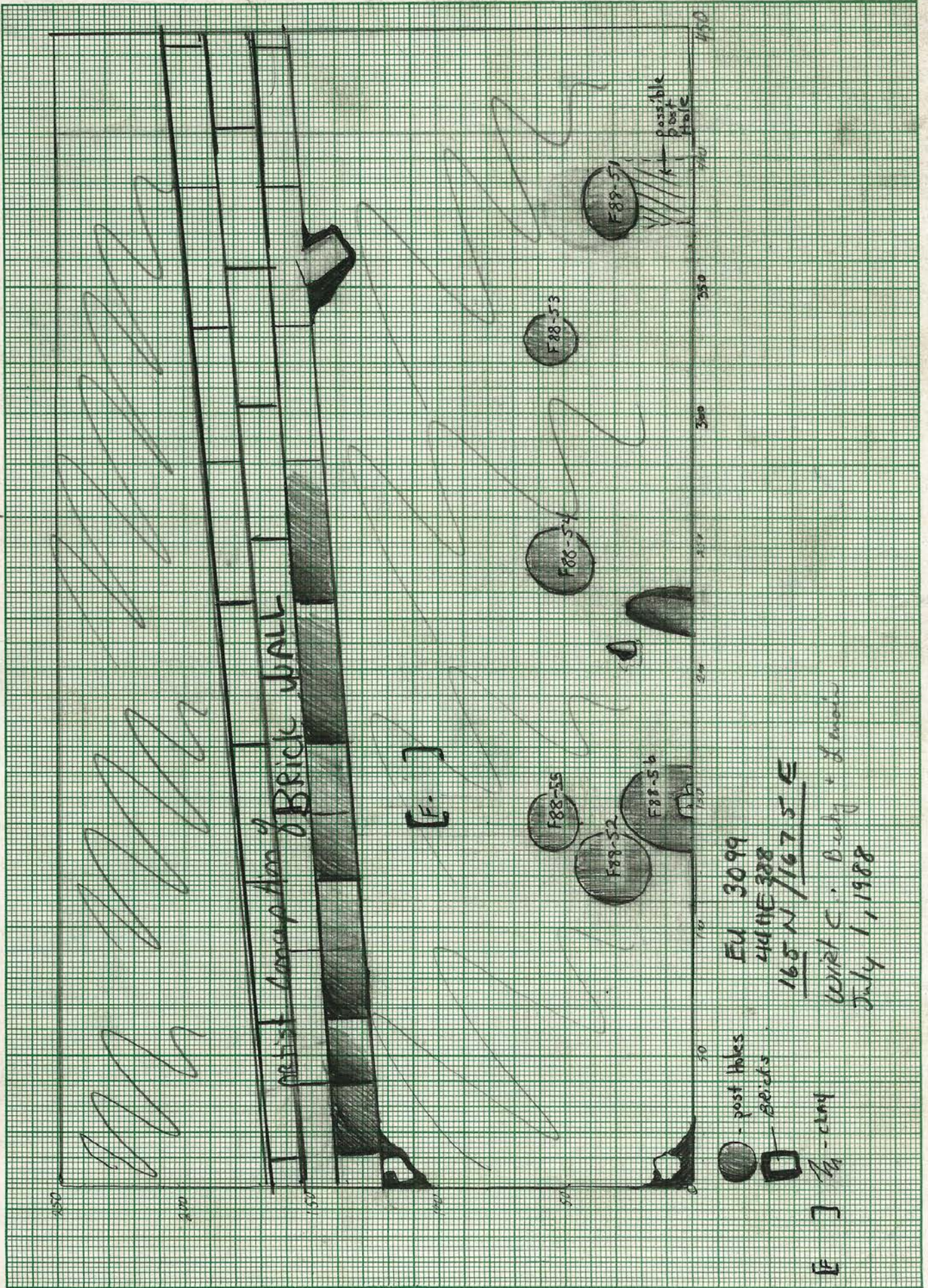

○ - post holes  
 □ - bricks  
 ▭ - clay

EU 3099  
 444E308  
 165 N / 167 S E

WRETC, Derry, Lomaha  
 July 1, 1988



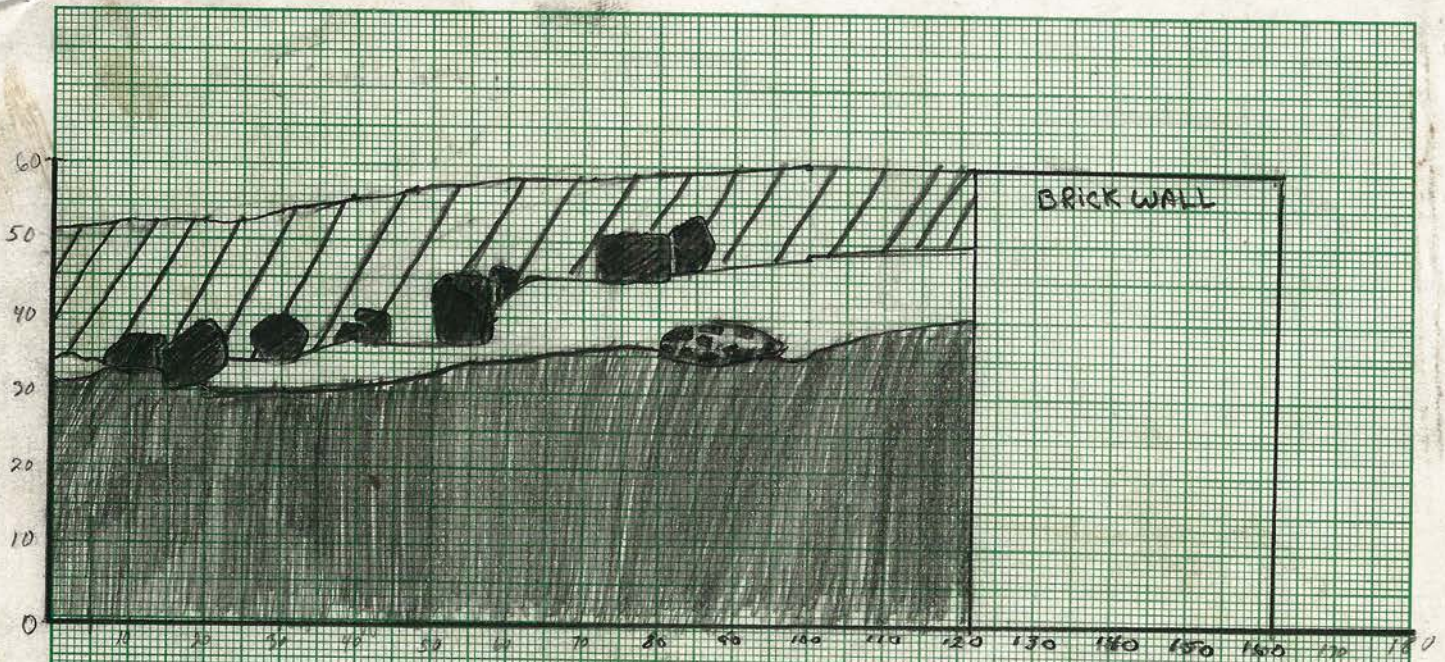





EU 3102

7/5/84

Nat. Linn. Bldg

-  - Topsoil / Brick Rubble
-  - Bricks
-  - (white) plaster
-  - brick pocket
-  - clay (some mottling)

EXCAVATION UNIT RECORD

*Not Complete this Year!*

Curles Plantation

44He388

E.U. # 3102

RECORDED BY Witt, Lenoir, Becky

DATES June 30, 1988  
BEGUN

*not complete this year*  
COMPLETED

TYPE OF UNIT:

- Test pit (no. \_\_\_\_\_) (attach to Test Pit Record)
- Square (size \_\_\_\_\_) (attach to Square Record)
- Trench (no. \_\_\_\_\_) (attach to Trench Record)
- Feature (no. \_\_\_\_\_) (attach to Feature Record)
- Post hole (no. \_\_\_\_\_) (attach to Pier/Post Record)
- Post mold (no. \_\_\_\_\_) (attach to Pier/Post Record)
- Pier (no. \_\_\_\_\_) (attach to Pier/Post Record)

PROVENIENCE: (skip if feature) 165 N 167.5 E arbitrary level to find Muller's trench Exact  Square

(SW corner) 165 N 167.5 E

DEPTHS: Top \_\_\_\_\_ Bottom \_\_\_\_\_ BELOW \_\_\_\_\_

STRATUM \_\_\_\_\_ LEVEL \_\_\_\_\_

E.U.s ABOVE 3099 3081 \_\_\_\_\_

E.U.s BELOW \_\_\_\_\_

CORRELATED E.U.s \_\_\_\_\_

SOIL DESCRIPTION:

EXCAVATED BY:  Trowel  Shovel  Screened PICK

SAMPLES TAKEN:

Soil (no. \_\_\_\_\_)

Constant Volume (no. \_\_\_\_\_)

COMMENTS:

*Not Complete this year - At the level of 7 bricks (56 cm) soil is clay with large cobbles + large bricks on floor of this area. One nail, 1 bone. On map looks like sterile soil below plaster level but large bricks + cobbles actually on floor and most removed. Attach appropriate level drawings.*

FEATURE RECORD

Curles Plantation

44He388

Feature # 88-65

RECORDED BY Ragan

DATES 5 July 7 July  
Begun Completed

TYPE OF FEATURE: levelling of silt & bricks & mortar blocks

DIMENSIONS: (first seen in T88A)

DEPTHS: Top \_\_\_\_\_ Bottom \_\_\_\_\_ BELOW \_\_\_\_\_

ASSOCIATED E.U. #'s:

- 3112 Description \_\_\_\_\_
- \_\_\_\_\_ Description \_\_\_\_\_
- \_\_\_\_\_ Description \_\_\_\_\_
- \_\_\_\_\_ Description \_\_\_\_\_
- \_\_\_\_\_ Description \_\_\_\_\_
- \_\_\_\_\_ Description \_\_\_\_\_
- \_\_\_\_\_ Description \_\_\_\_\_
- \_\_\_\_\_ Description \_\_\_\_\_
- \_\_\_\_\_ Description \_\_\_\_\_
- \_\_\_\_\_ Description \_\_\_\_\_
- \_\_\_\_\_ Description \_\_\_\_\_
- \_\_\_\_\_ Description \_\_\_\_\_
- \_\_\_\_\_ Description \_\_\_\_\_

COMMENTS:

STOPPED WHEN FOUND LAYER OF SHAL  
BELIEVED TO BE A POSSIBLE FLOOR  
COATING OR ETC.

Attach appropriate profile drawings.

EXCAVATION UNIT RECORD

Curles Plantation

44He388

E.U. # 3112

RECORDED BY Rogers

DATES 5 July  
BEGUN

7/30/44  
COMPLETED

TYPE OF UNIT:

Test pit (no. \_\_\_\_\_) (attach to Test Pit Record)

Square (size \_\_\_\_\_) (attach to Square Record)

Trench (no. 88A) (attach to Trench Record)

Feature (no. 88-65) (attach to Feature Record)

Post hole (no. \_\_\_\_\_) (attach to Pier/Post Record)

Post mold (no. \_\_\_\_\_) (attach to Pier/Post Record)

Pier (no. \_\_\_\_\_) (attach to Pier/Post Record)

PROVENIENCE: (skip if feature)  Exact  Square

(SW corner) \_\_\_\_\_ N \_\_\_\_\_ E

DEPTHS: Top \_\_\_\_\_ Bottom \_\_\_\_\_ BELOW \_\_\_\_\_

STRATUM \_\_\_\_\_ LEVEL \_\_\_\_\_

E.U.s ABOVE 3107 3100 \_\_\_\_\_

E.U.s BELOW \_\_\_\_\_

CORRELATED E.U.s \_\_\_\_\_

SOIL DESCRIPTION:

EXCAVATED BY:  Trowel  Shovel  Screened

SAMPLES TAKEN:

Soil (no. \_\_\_\_\_)

Constant Volume (no. \_\_\_\_\_)

COMMENTS:

Attach appropriate level drawings.

FEATURE RECORD

Curles Plantation

44He388

Feature # 88-66

RECORDED BY KJ

DATES 5 July  
Begun

5 JULY  
Completed

TYPE OF FEATURE: roofing tile Cell

DIMENSIONS:

DEPTHS: Top \_\_\_\_\_ Bottom \_\_\_\_\_ BELOW \_\_\_\_\_

ASSOCIATED E.U. #'s:

<u>3116</u>	Description	<u>roofing tiles</u>	<u>E 1/2</u>
<u>3117</u>	Description	<u>" "</u>	<u>W 1/2</u>
_____	Description	_____	_____
_____	Description	_____	_____
_____	Description	_____	_____
_____	Description	_____	_____
_____	Description	_____	_____
_____	Description	_____	_____
_____	Description	_____	_____
_____	Description	_____	_____
_____	Description	_____	_____
_____	Description	_____	_____
_____	Description	_____	_____

COMMENTS: PRIMARY DESTRUCTION LEVEL OF ROOF TILE, FOUND IN THIS EU. W/ W NAILS, SOME IN ASSOCIATION WITH ROOF TILE. ONE BRICK, ONE PIECE OF LATH MARKED MORTAR, ONE PIECE OF ROOF TILE WITH NAIL REMNANTS. BELOW THIS LEVEL WAS THE TILE FLOOR. ALSO A CHECKED BRICK FOUND

Attach appropriate profile drawings.

EXCAVATION UNIT RECORD

Curles Plantation

44He388

E.U. # 3116

RECORDED BY KV

DATES 5 July  
BEGUN

5 JULY  
COMPLETED

TYPE OF UNIT:

\_\_\_ Test pit (no. \_\_\_\_\_) (attach to Test Pit Record)

\_\_\_ Square (size \_\_\_\_\_) (attach to Square Record)

\_\_\_ Trench (no. \_\_\_\_\_) (attach to Trench Record)

Feature (no. 88-66) (attach to Feature Record)

\_\_\_ Post hole (no. \_\_\_\_\_) (attach to Pier/Post Record)

\_\_\_ Post mold (no. \_\_\_\_\_) (attach to Pier/Post Record)

\_\_\_ Pier (no. \_\_\_\_\_) (attach to Pier/Post Record)

PROVENIENCE: (skip if feature) \_\_\_ Exact \_\_\_ Square

(SW corner) \_\_\_\_\_ N \_\_\_\_\_ E

DEPTHS: Top \_\_\_\_\_ Bottom \_\_\_\_\_ BELOW \_\_\_\_\_

STRATUM \_\_\_\_\_ LEVEL \_\_\_\_\_

E.U.s ABOVE \_\_\_\_\_

E.U.s BELOW \_\_\_\_\_

CORRELATED E.U.s \_\_\_\_\_

SOIL DESCRIPTION: ROOF TILE

EXCAVATED BY: \_\_\_ Trowel  Shovel \_\_\_ Screened

SAMPLES TAKEN:

\_\_\_ Soil (no. \_\_\_\_\_)

\_\_\_ Constant Volume (no. \_\_\_\_\_)

COMMENTS: PRIMARY DESTRUCTION LEVEL OF ROOF TILE FOUND IN THIS E.U. WERE NAILS, SOME IN ASSOCIATION WITH ROOF TILE, ONE BROWN BRICK, ONE PIECE OF LATH MARKED PLASTER, ONE PIECE OF ROOF TILE WITH NAIL REMNANTS, ALSO A BRICK WITH A CHUNK IN IT. BELOW THIS LEVEL WAS THE TILE FLOOR.

Attach appropriate level drawings.

EXCAVATION UNIT RECORD

Curles Plantation

44He388

E.U. # 3117

RECORDED BY Dagmar Vontea DATES 5 July  
BEGUN \_\_\_\_\_ COMPLETED \_\_\_\_\_

TYPE OF UNIT: West half of roofing tile destruction layer

- Test pit (no. \_\_\_\_\_) (attach to Test Pit Record)
- Square (size \_\_\_\_\_) (attach to Square Record)
- Trench (no. \_\_\_\_\_) (attach to Trench Record)
- Feature (no. 88-60) (attach to Feature Record)
- Post hole (no. \_\_\_\_\_) (attach to Pier/Post Record)
- Post mold (no. \_\_\_\_\_) (attach to Pier/Post Record)
- Pier (no. \_\_\_\_\_) (attach to Pier/Post Record)

PROVENIENCE: (skip if feature)  Exact  Square  
(SW corner) \_\_\_\_\_ N \_\_\_\_\_ E

DEPTHS: Top \_\_\_\_\_ Bottom \_\_\_\_\_ BELOW \_\_\_\_\_

STRATUM \_\_\_\_\_ LEVEL \_\_\_\_\_

E.U.s ABOVE \_\_\_\_\_

E.U.s BELOW \_\_\_\_\_

CORRELATED E.U.s \_\_\_\_\_

SOIL DESCRIPTION: lays under F88-45, very dark loosely packed soil

EXCAVATED BY:  Trowel  Shovel  Screened

SAMPLES TAKEN:

- Soil (no. \_\_\_\_\_)
- Constant Volume (no. \_\_\_\_\_)

COMMENTS:

- Roofing Tile sealed off a layer of destruction that could be very helpful in dating the occupation of the building
- Soil had a lot of bricks + mortar

Attach appropriate level drawings.

- found a Colono-Indian pipe (around 1650) in

the lens of soil underneath the roofing tile.

West wall layer of washed in soil

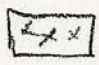

 charcoal bits

 brick dust

