

General Record

44HE388

Recorded by H. S. Date begun 6-19-89 completed _____

SQUARE	provenience _____ N _____ E Size _____
FEATURE	Feature # <u>89-46</u> Type of feature <u>Ind-est^{inck} /^{ove}</u> provenience first encountered <u>161.5 N 161.3 E</u> depth <u>-2.20</u>
TRENCH	Trench # _____ provenience _____ N _____ E dimensions _____ N-S _____ E-W

Associated EU's:

Number	Description
<u>4087</u>	<u>Gentle trowel off 160N160E</u>
<u>4086</u>	<u>" 157.5N 160E</u>
<u>4087</u>	<u>F-89-46 (Posthole?)</u>
<u>4095</u>	<u>F-89-58 Post mold</u>

Put comments and descriptions on back and attach all EU records and drawings.

Below 89-1 - Indistinct level, cannot tell subsoil from feature - probable 17th century level. Post hole/mold intrude into post hole/mold (F-89-56/F-89-57).

upon second thought, it appears as though they
don't touch each other.

This is distinctly fucked up as I don't remember
the "posthole" and have thought of 89-46 as the landscaping
clay we have been struggling to see through

9 Jul 89

TK

Suspect ERIC took 46 for his post and forgot to fill out
the feature catalog

TK 18 Jul 89

Posthole is now 89-139

44 HE388 CADILLAC ES
101.5N 161.3E

F 89-46 / E 89-58

Profile Hole Mold
E.V. > 4087, 4095

0 20 40 60 80

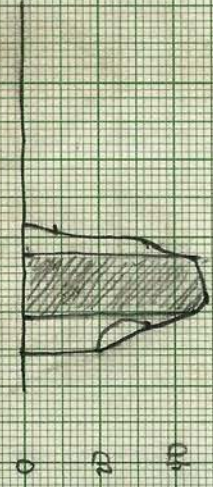

0 20 40 60 80 100 120 140 160 180 200 220 240 260 280 300



A*

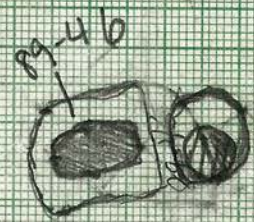

160W
B*
160E

cauties
44HE 388
Post hole 6 Mold
E. U. 4087
F 89-46
160N 160E
1CM = 20CM
6-19-89
K. Sharves
Yellowish Brown
Humous soil

General Record

44HE388

Recorded by LN Date begun 6/19 completed _____

SQUARE

provenience 157.5 N 160 E Size _____

FEATURE

Feature # 89-46 ? Type of feature _____

provenience first encountered _____ N _____ E

depth _____

TRENCH

Trench # _____ provenience _____ N _____ E

dimensions _____ N-S _____ E-W

Associated EU's:

Number	Description
<u>4086</u>	<u>89-46 "indistinct" level taken down</u>
_____	_____
_____	_____
_____	_____
_____	_____
_____	_____
_____	_____
_____	_____
_____	_____

Put comments and descriptions on back and attach all EU records and drawings.

?

(Ask Lynn)

General Record

44HE388

Recorded by REL Date begun 6/19 completed _____

SQUARE	provenience _____ N _____ E Size _____
FEATURE	Feature # <u>89-47</u> Type of feature <u>Hole (Post)</u> provenience first encountered <u>159.5</u> N <u>164.3</u> E depth <u>2.42</u>
TRENCH	Trench # _____ provenience _____ N _____ E dimensions _____ N-S _____ E-W

Associated EU's:

Eric

Number	Description
_____	_____
_____	_____
_____	_____
_____	_____
_____	_____
_____	_____
_____	_____
_____	_____
_____	_____
_____	_____

Put comments and descriptions on back and attach all EU records and drawings.

General Record

44HE388

Recorded by REL Date begun 6/19 completed _____

SQUARE	provenience _____ N _____ E Size <u>7</u>
FEATURE	Feature # <u>89-48</u> Type of feature <u>Mold (Post)</u> provenience first encountered <u>159.5</u> N <u>164.3</u> E depth <u>2.42</u>
TRENCH	Trench # _____ provenience _____ N _____ E dimensions _____ N-S _____ E-W

Associated EU's:

ERIC

Number	Description
_____	_____
_____	_____
_____	_____
_____	_____
_____	_____
_____	_____
_____	_____
_____	_____
_____	_____

Put comments and descriptions on back and attach all EU records and drawings.

General Record

44HE388

Recorded by TK Date begun 6 Jul completed _____

SQUARE	provenience _____ N _____ E Size _____
FEATURE	Feature # <u>89-50</u> Type of feature <u>ditch</u> provenience first encountered <u>1512</u> N <u>159.6</u> E depth _____
TRENCH	Trench # _____ provenience _____ N _____ E dimensions _____ N-S _____ E-W

Associated EU's:

Number	Description
<u>4160</u>	<u>cut through ditch to see if it matched 89-50 further to the north</u>
_____	_____
_____	_____
_____	_____
_____	_____
_____	_____
_____	_____
_____	_____

Put comments and descriptions on back and attach all EU records and drawings.

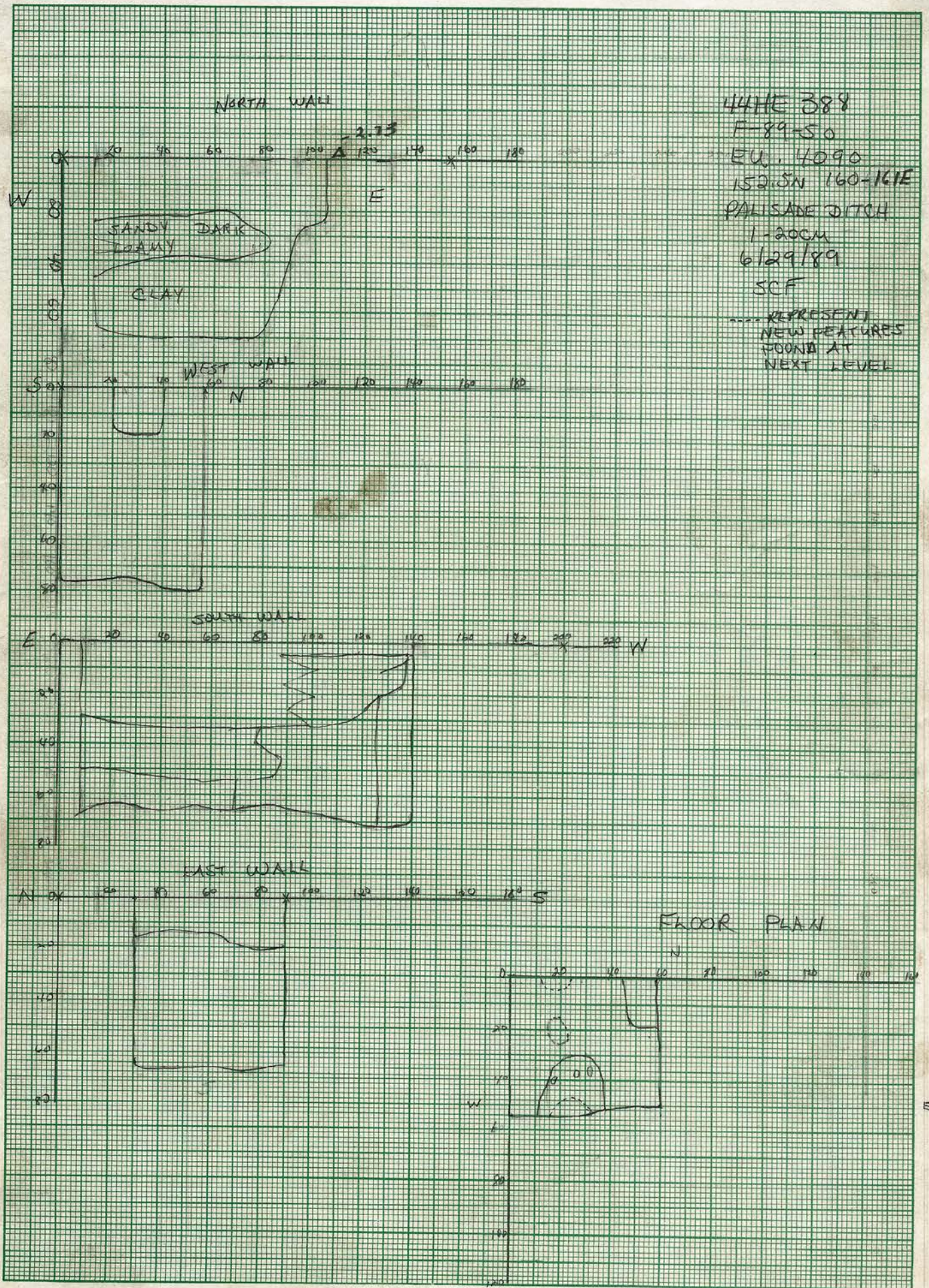

44HE 388
 F-89-50
 EU. 4090
 150.5N 160-161E
 PALISADE DITCH
 1-20CM
 6/29/89
 SCF
 --- REPRESENT
 NEW FEATURES
 FOUND AT
 NEXT LEVEL

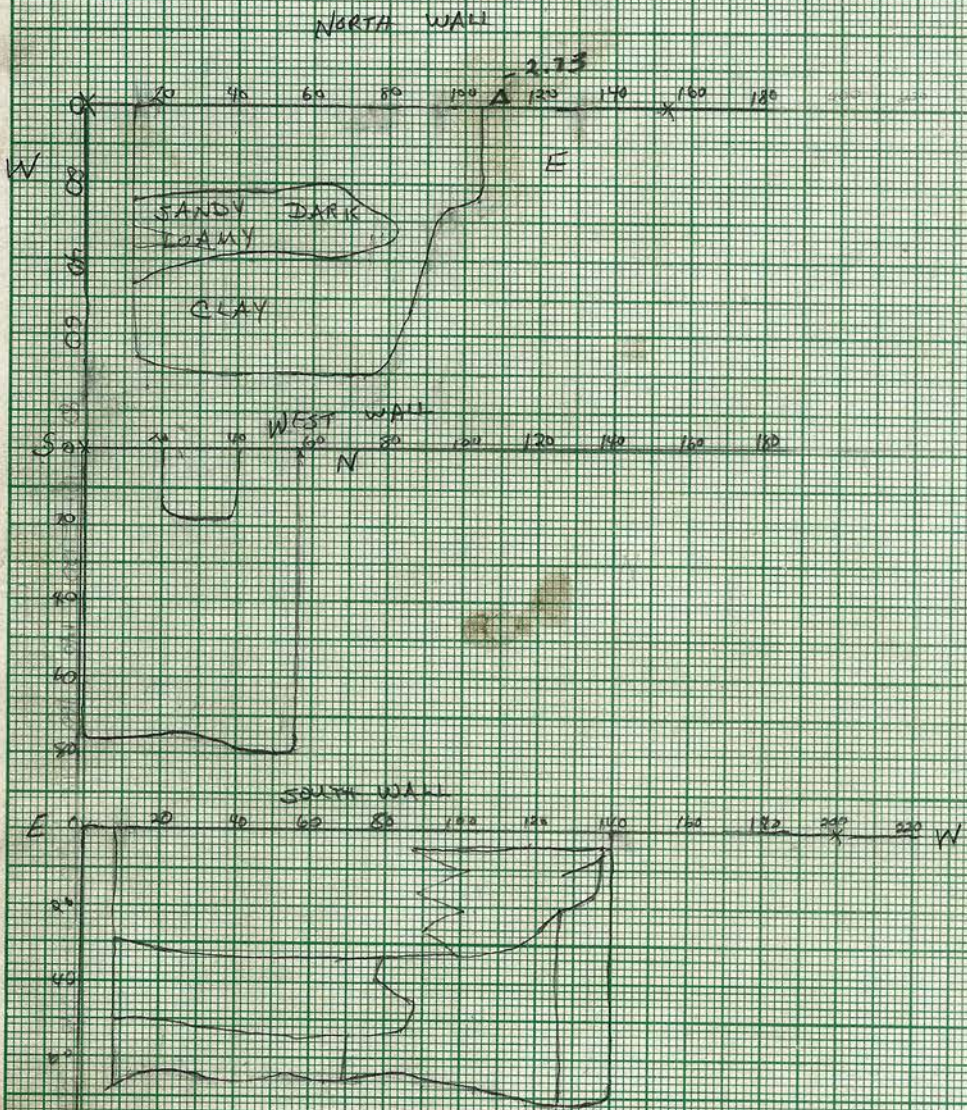

FLOOR PLAN

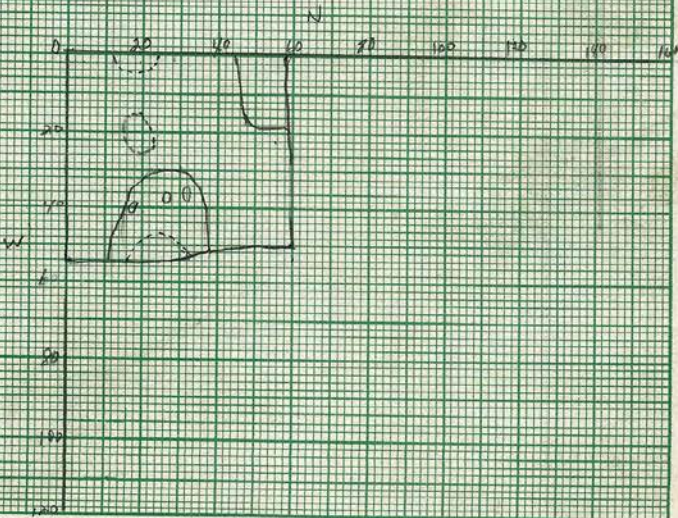

142.5N
160E
E4 4141

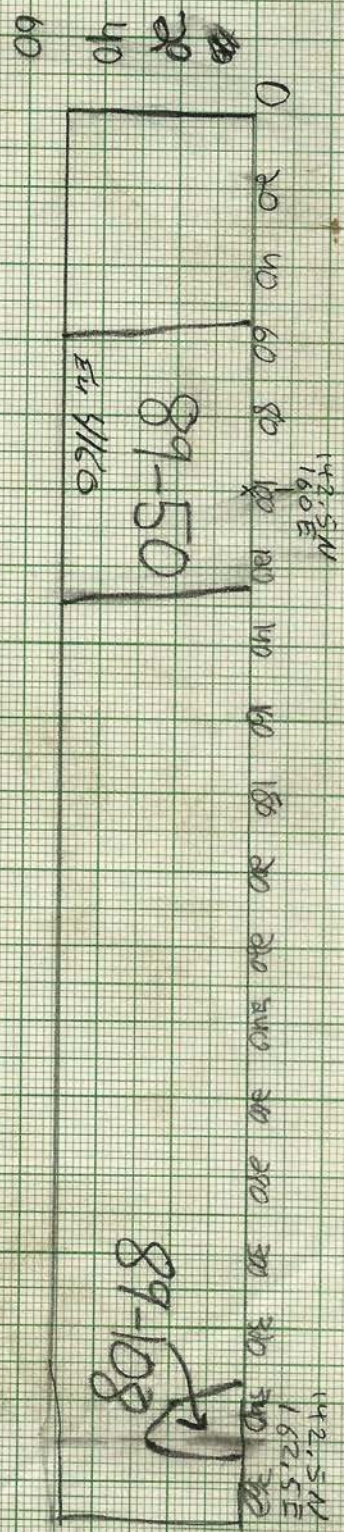

U Y H E 388

6/29/89

E4 4141

142.5 N 160E

1cm = 20cm

P. Cutlip

147N
160E
EY 9127
1 meter extension

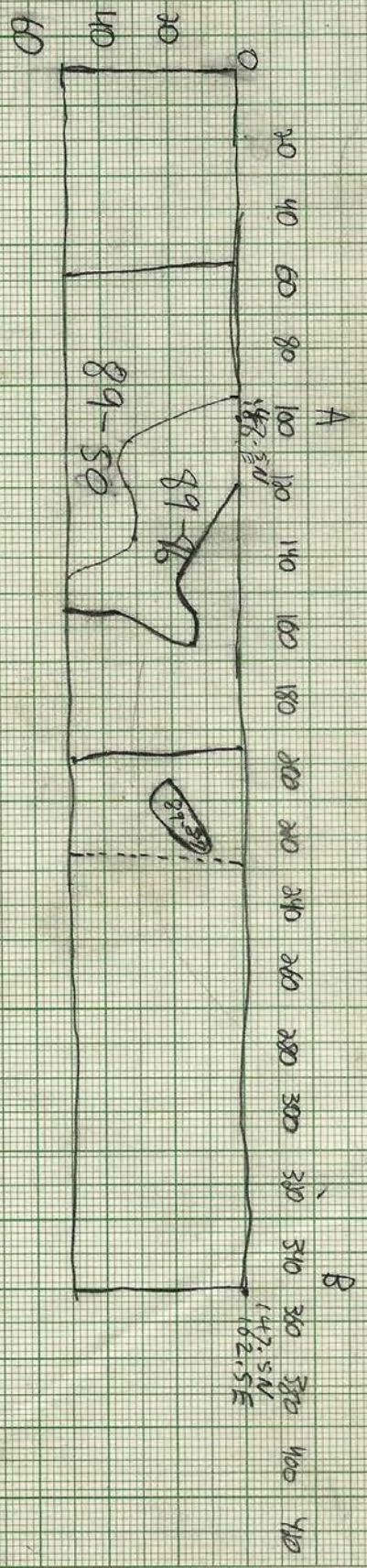

This 89-86 is actually 89-50. Row!
 double assigned 89-86. 89-86 is a row!
 in the small collar. This 89-86 is NOT
 89-86

44 HE 388
 6/29/89
 EY 9127
 147N 160E
 1 cm = 20 cm
 P. Catlip

44 HE 388

1 in = 1 m

GN

At the bottom of 87-15

160N
160E
A

Lt. Brown
Sandy loam

Heavy sand
Wash

Clay
Boulders
Trunks

Light Brown Clay loam

Wash

Test
Cut

2.70 m
8'10"

6.90 m
22'7 1/2"

Lt. Brown
Sandy loam

155N
160E
X

87-50



This drawing primarily to show shape and relationship. Sterile soil here is a tan sandy clay with particles of orange clay, and about 10% mottled w/ c. 5 mm Mn and Fe formation

TK 20 Jul 89

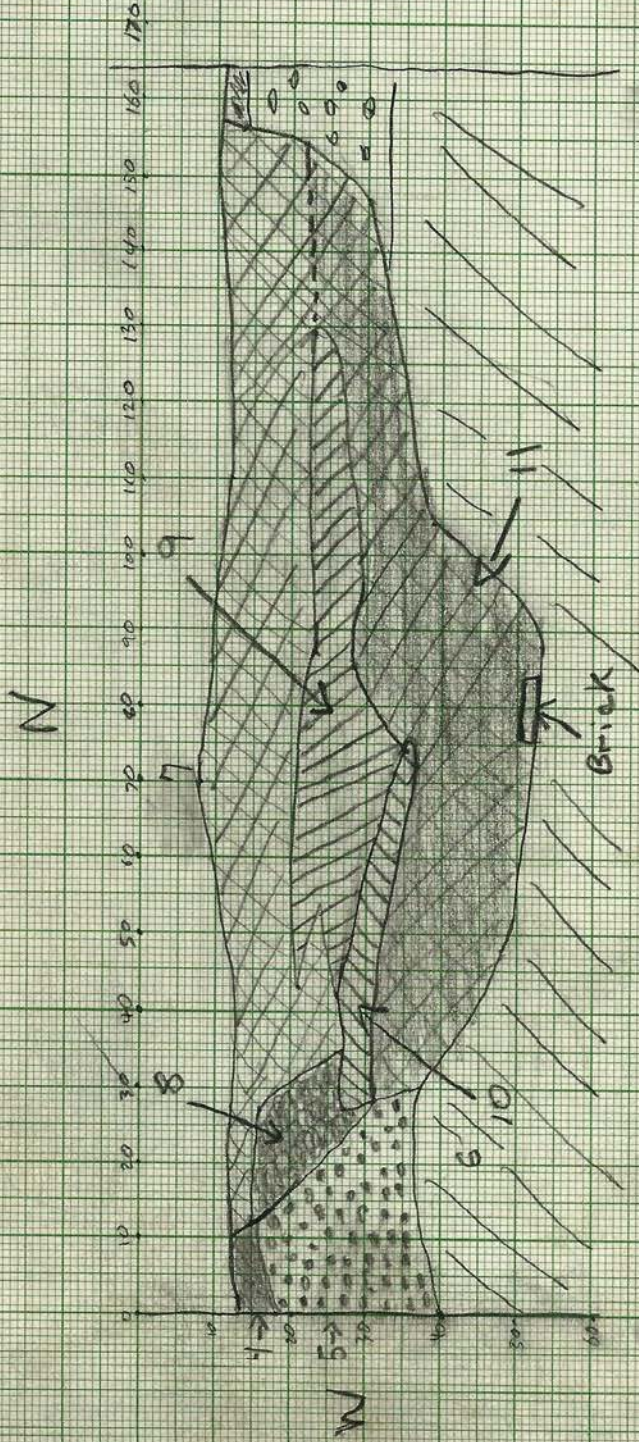

- 4 Tan heavily mottled w/ manganese & iron (40%) clay
Some charcoal & brick, probably last historic level
- 5 Sterile
- 7 Med brown Sandy loam lightly flecked w/ charcoal
& brick
- 8 Med brown Silt loam Brick & charcoal flecked
- 9 med brown w/ sand washed lenses Loam Brick & charcoal flecked
- 10 Orange Clay loam 50% mottled w/ med brown wash lens
- 11 Light Brown Clay loam 10% flecked w/ iron & manganese formation

44HF388
July 14, 1989
Profile of N wall of Trench 89-30
EU 4129
~~415 N 100 E~~ ~~140 W~~ 143 W 158 E
158.9 E

Don't, at this point know if I have a
 elevation for this drawing, but it is about
 45 cm above strike floor of slot trench
 Guestimate approx -3.00m TK 18/1/89

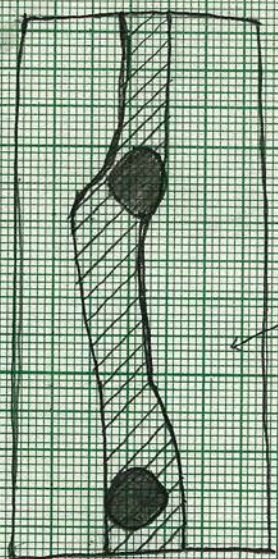

HARD PACKED
 SANDY LOAM w/ clay

F-89-50

GN
 ↑

152.5N
 160E

152.5N
 162.5E

44RE388
 E4155

10m x 20m
 July 6, 1989

■ Possible Postmold

▨ DK SANDY LOAM

□ YELLOW/BROWN SANDY LOAM

EV 4129

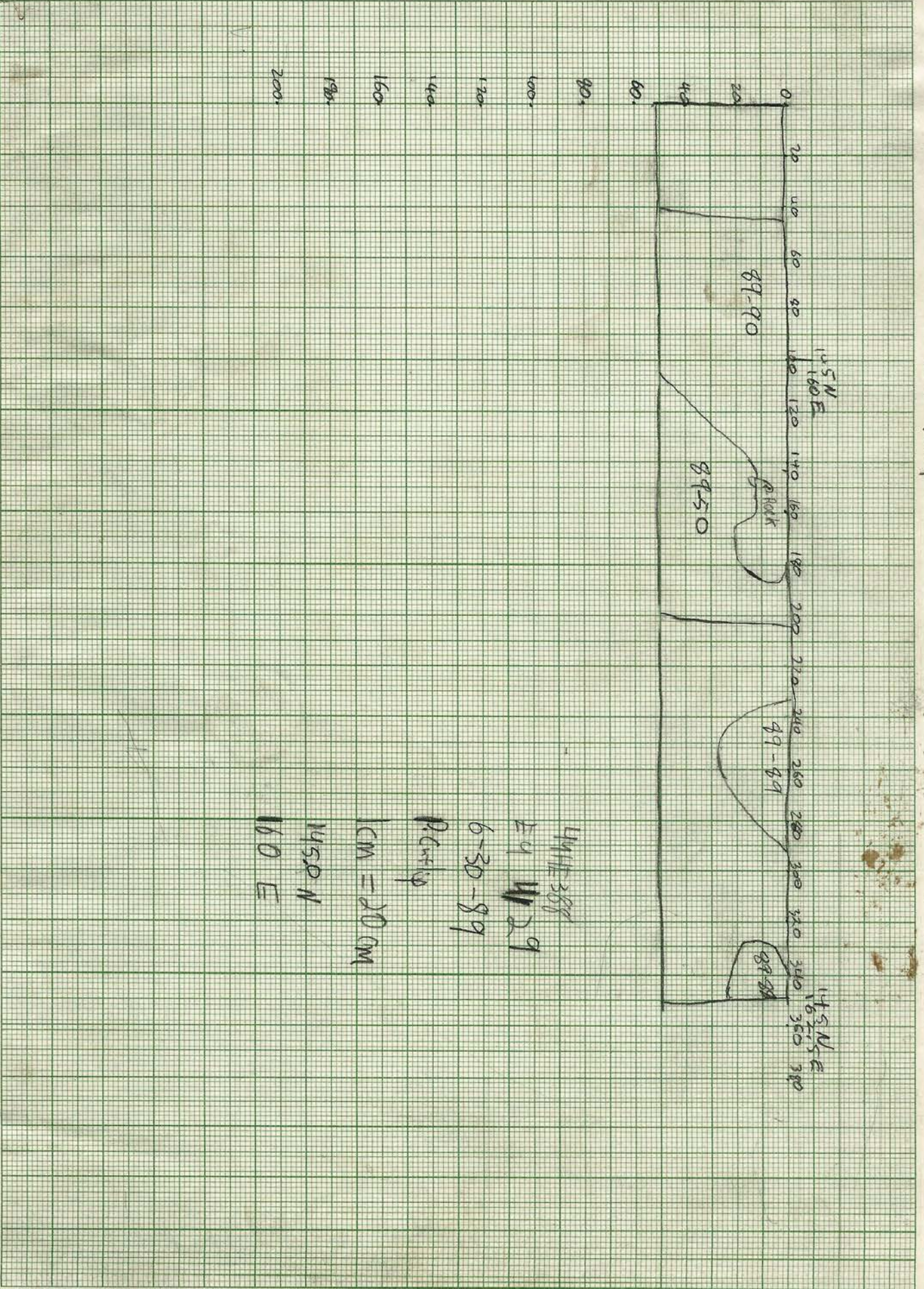

145°N
160E

89-90

89-50

89-89

145°N
160E

89-88

444E 389

EV 4129

6-30-89

RC-110

1CM = 200M

145°N

160E

0
20
40
60
80
100
120
140
160
180
200

461510

10 X 10 TO THE CENTIMETER
KEUFFEL & ESSER CO. MADE IN U.S.A.
K&E

