

FEATURE RECORD

(attach all drawings)

FEAT # 91-15

SITE # 44H6386 TYPE OF FEATURE Root cellar fill

PROVENIENCE(S) 170N 167.5E, 170N 165E, 167.5N 165E, 167.5N 167.5E

FEATURES OVERLYING: \_\_\_\_\_

FEATURES UNDERLYING: F 48 # 91-18

RELATED FEATURES: \_\_\_\_\_

Date Drawn: \_\_\_\_\_ Date Started: 6-20-91 Finished: 6/24/91

Description and Observations of Feature. INCLUDE Soil description.

This fill is almost entirely brick and mortar rubble. The soil is dark brown loam and charcoal and slag run all through it. A few oyster shells were found which were probably just part of the mortar or plaster. Quite a few bones were found along with a flake.

I found a few pieces of window pane glass, a kaolin pipe stem piece and a local pipe stem. Found a piece of polychrome hand-painted pearlware (1795-1815) and either a piece of annular pearlware or just another piece of the polychrome with a brown band.

EU's in this Feature: 6044



Recorded by C.S. Excavated By C.S.

ALL DRAWINGS MUST HAVE ELEVATIONS!

MUST HAVE ELEVATIONS

Found about 50 nails - some wrought nails, but mostly cut nails. Some of the cut nails don't seem used. The mortar shows imprints of wood beams and some have pieces of burnt wood still imbedded in them.

Found a few very interesting metal objects.

One large nut and bolt?   
a curved metal piece  or something  and a skewer

after removing the thick layer of brick I hit another layer of lighter soil which was still not as yellow and dense as the actual floor of the cellar. This layer is given EU # 6049 and F # 91-18.

The floor layer seems to be covered with cobblestones.

444HE 388  
(F-48)  
Eastview

1cm = 10cm  
9 July 91

profile of east wall of bisected roof cellar (F-48)

C.S. K.S.

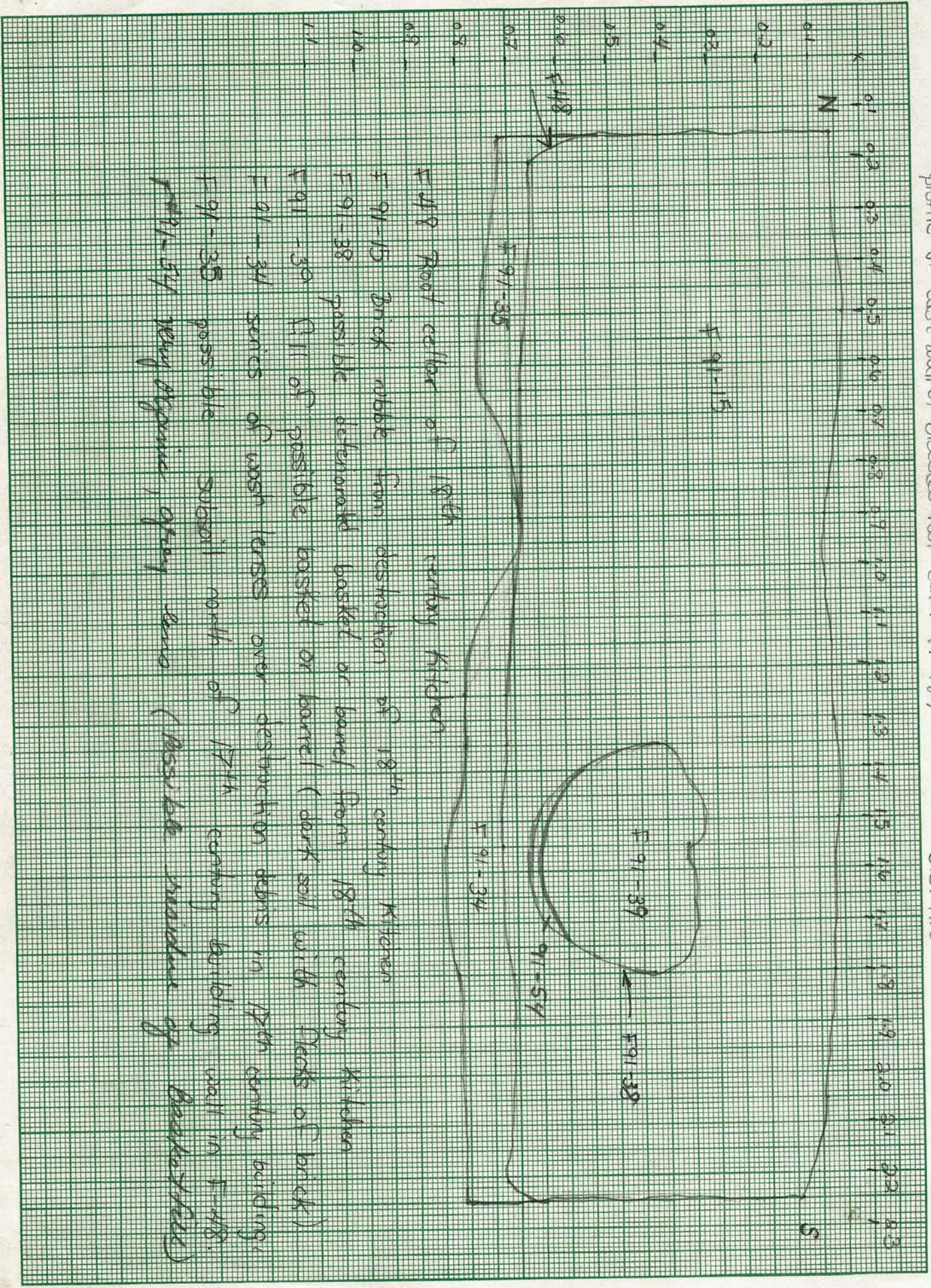

F-48 Roof cellar of 18th century kitchen

F-91-15 Brick rubble from destruction of 18th century kitchen

F-91-38 possible deteriorated basket or barrel from 18th century kitchen

F-91-39 All of possible basket or barrel (dark soil with flecks of brick)

F-91-34 series of wash troughs over destruction debris in 17th century building

F-91-35 possible subsoil north of 17th century building wall in F-48

F-91-54 very deep, gray and (possible residue of basket/rill)

FEATURE RECORD

(attach all drawings)

FEAT # 91-16

SITE # 44HE388

TYPE OF FEATURE

rebed wall

PROVENIANCE(S)

1st identified in sq 167.5N 170E

FEATURES OVERLYING:

P2

FEATURES UNDERLYING:

RELATED FEATURES:

F#60

Date Drawn:

Date Started:

Finished:

Description and Observations of Feature. INCLUDE Soil description.

rebed wall extending east from east wall of Rm 1400 (F#60) in an L shape. Believed to be a Patch.

EU's in this Feature:

Recorded by

Excavated By

ALL DRAWINGS MUST HAVE ELEVATIONS!

FEATURE RECORD

(attach all drawings)

FEAT # 91-17

SITE # 44H388

TYPE OF FEATURE Posthole

PROVENIENCE(S) 1675N 170E

FEATURES OVERTLYING: P2

91-28 91-29 91-19 91-87

FEATURES UNDERLYING:

RELATED FEATURES:

Date Drawn: \_\_\_\_\_ Date Started: \_\_\_\_\_ Finished: 7-10-91

Description and Observations of Feature. INCLUDE Soil description.

*readjusted post  
Fill is very dark brown with black  
spherules, charcoal, mortar,*

EU's in this Feature: \_\_\_\_\_

Recorded by \_\_\_\_\_

Excavated By \_\_\_\_\_

ALL DRAWINGS MUST HAVE ELEVATIONS!



brick  
shale

G. Hammer  
27 June 1991

len = 20 cm

post hole  
and mold

west garden  
of 91-17

F-91-19

F-91-19 in

60 6054

WHE 588

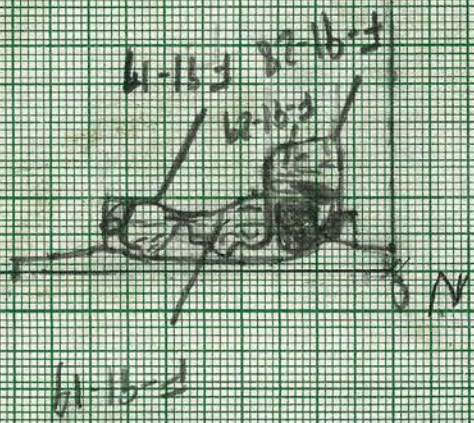

S

N

F-91-19