

Feature Form

Site # 44HE388

Feature # 54

from previous years

Exact Prov. 169N 169E

Type of Feature cobble floor inside hearth, main room only

Association _____

EU Numbers 8057

Dimensions portion excavated - 130 x 80cm, 10-15cm deep.

Excavation Notes: Include EU # used, portion excavated, soil conditions, artifacts recovered, other observations

Concentrated cobbles and gravel in medium-brown loam. Excavated floor extending into Western hearth between NW and SW cheeks. Cobble floor bottoms-out on heavy brick and mortar rubble probably from reconstruction of hearth. Rubble from reconstruction imbedded in burn layer-possibly floor of original hearth. 1 nail, 1 pc. petrified wood, 1 sherd English stoneware bagged.

Dated Started 6/21/93 Finished 6/22/93

Profiled _____ Plan Drawn _____ Photos _____

Samples Taken _____

Excavated by (All) G. LaBUDDE

Feature Form
Continuation Sheet
44PG302

Feature# 91-57

Block Prov. 1625E 160E

Finished - 7-8-93

Page 1 of 11

Excavation Notes:

EU 8085: Removed light, sandy wash layer from above brick layer (F#93-7) and plaster and mortar layer (F#93-37). Artifacts found were nails, small pieces of wine bottle glass and bone, ceramics dating to Bacon's time, piece of pipe stem, a sewing pin, a green Indian trading bead, and a tooth. Rocks and bricks in the feature near the north wall were removed as well.

Feature Form
Continuation Sheet
44PG302

Feature# 91-63

Block Prov. 1625N 165E

Page 2 of

Excavation Notes:

6125193 : Uncovered what originally appeared to be a a plow blade w/ the Mattox. However, a second, adjacent piece of the same material, fused to a brick, removed w/ that brick, must force a reassessment of my original (plow) assumption.

In addition a few nails (+3) were found as well as what appeared as rust stains. No diagnostic found. The soil was clay mottled w/ brick and sandy wash deposits. MM, KW

Uncovered dirt on top of robber's trench continued from 8072 in next square. Another indentation in the bricks indicate another possible post-hole equi-distant to possible post-holes in the other square indicating a possible post-built house with brick chinking.

Feature Form

Site # 44HE388

Feature # 93-1

Exact Prov. 166.7N 165E

Type of Feature builder's trench inside S. wall east wing of kitchen

Association F-60 (S. Wall of Kitchen)

EU Numbers (8015 in T93-1) (8021 from chimney wall east to 166 E. pass line)

Dimensions _____

Excavation Notes: Include EU # used, portion excavated, soil conditions, artifacts recovered, other observations

- builder's trench in trench T93-1 excavated. Soil was dark sandy organic fill, very loose. artifacts include local octagonal pipe bowl and other undiagnostic.

- GL-EU 8021 - dark brown sandy loam. Trench cut by builder's trench for cross-wall protruding from F-60 (S. Wall of Kitchen). Suggests trench for crosswall not created at same time, concentrated brick and mortar rubble found at bottom of trench near cross-wall not encountered to the east in trench.

Dated Started 6/9/93 Finished _____

Profiled _____ Plan Drawn _____ Photos _____

Samples Taken _____

Excavated by (All) STB, TC, GJK

J

Feature Form

Site # 44HE388

Feature # 93-2

Exact Prov. 167N 165.5E

Type of Feature probable rodent disturbance

Association culdes trench Small test wire pitaker

EU Numbers 8018

Dimensions 22cm ϕ 5cm deep

Excavation Notes: Include EU # used, portion excavated, soil conditions, artifacts recovered, other observations

This feature was found to be only 5 cms deep. Probably what was found was only the very bottom of a rodent disturbance. No artifacts recovered.

Dated Started 6/11/93 Finished 6/11/93

Profiled _____ Plan Drawn _____ Photos _____

Samples Taken _____

Excavated by (All) G. LABUDDE



Feature Form

Site # 44HE388

Feature # 93-3

Exact Prov. _____

Type of Feature clay stratum in main kitchen wing

Association compared to F 91-32 in E kitchen wing

EU Numbers 8019

Dimensions _____

Excavation Notes: Include EU # used, portion excavated, soil conditions, artifacts recovered, other observations

Feature defined by G. deBiddle in his independent study during 1993 Field School. Only given a feature number because artifacts were found in it during a profile cleanup. Compared to F91-32 in E. wing of kitchen by soil makeup and relative depth under kitchen cobble floor. Feature was not excavated, only touched on during cleaning.

Artifacts found were 2 or 3 pieces of English Beaman Tan ceramic type

Revised 7.16.93
SMB

Dated Started _____ Finished _____

Profiled _____ Plan Drawn _____ Photos _____

Samples Taken _____

Excavated by (All) G. deBiddle

* Form 1042 for F93-3
2013

Feature Form

Site # 44HE388

Feature # 93-3

Exact Prov. _____

Type of Feature clay stove fill in main wing of kitchen, compares to F91-32 in E. wing

Association kitchen

EU Numbers 9019,

Dimensions _____

Excavation Notes: Include EU # used, portion excavated, soil conditions, artifacts recovered, other observations

- EU 9019 excavated as part of Greg Tabuda's independent study to study kitchen hearth. Soil was light clay, very compact. Artifacts were several pieces of English Brown and Tan. Part taken out was between SW kitchen cheek and S wall under trench of kitchen.

Dated Started 6-11-93 Finished _____

Profiled _____ Plan Drawn _____ Photos _____

Samples Taken _____

Excavated by (All) _____

Feature Form

Site # 44HE388Feature # 93-4

Block

Exact Prov. 162.5N 162.5EType of Feature C-shaped hearth feature composed of bricks and cobbleAssociation undeterminedEU Numbers 8027, 8035Dimensions 1.12 N-S 1.50 E-W

Excavation Notes: Include EU # used, portion excavated, soil conditions, artifacts recovered, other observations

EU 8027 = Trench cutting across F 91-60, F 93-7, F 93-6, Exploratory Trench in 162.5N 162.5E to determine stratigraphy in front of F 93-4.

(SEE General RECORD FOR Trench 93-3). The bricks making up 'C' in hearth are whole, upright bricks. On the east side of the 'C' there are *two bricks in line running N-S. There are bricks in place (hearth floor) ca. 35mm beneath top of 91-60/91-6/93-7, running North from 'C' and beneath 'C'. The lines of brick run E-W lengthwise and extend ca. 24 to the North from 'C'. The bricks are burned.

(* These two bricks are overlying bricks in place) The hearth floor extends in to East and west wall of Trench 93-3

17 June 93 Trench extended .77 to the west. 7 more bricks of the 'C' were exposed. The hearth floor continued into this section of trench and may continue under W. wall of trench. The hearth floor is not fully intact, many bricks in mid section are broken or missing

Dated Started 16 June 93 Finished 17 June 93 Artifacts: unident. nails

Profiled _____ Plan Drawn 6.14.93 Photos 17 June 93

Samples Taken EU 8035, ASH LENSE ca. 2 liters

Excavated by (All) CP

scale of 100 cm
147e388
W. Ly + J. J. + C. Rig

K&E 10 X 10 TO THE CENTIMETER 18 X 25 CM
KEUFFEL & ESSER CO. MADE IN U.S.A.

46 1510

of 2

ground level to 73m hd
Shot 6-14-93

PLAN Drawing of F93-F1

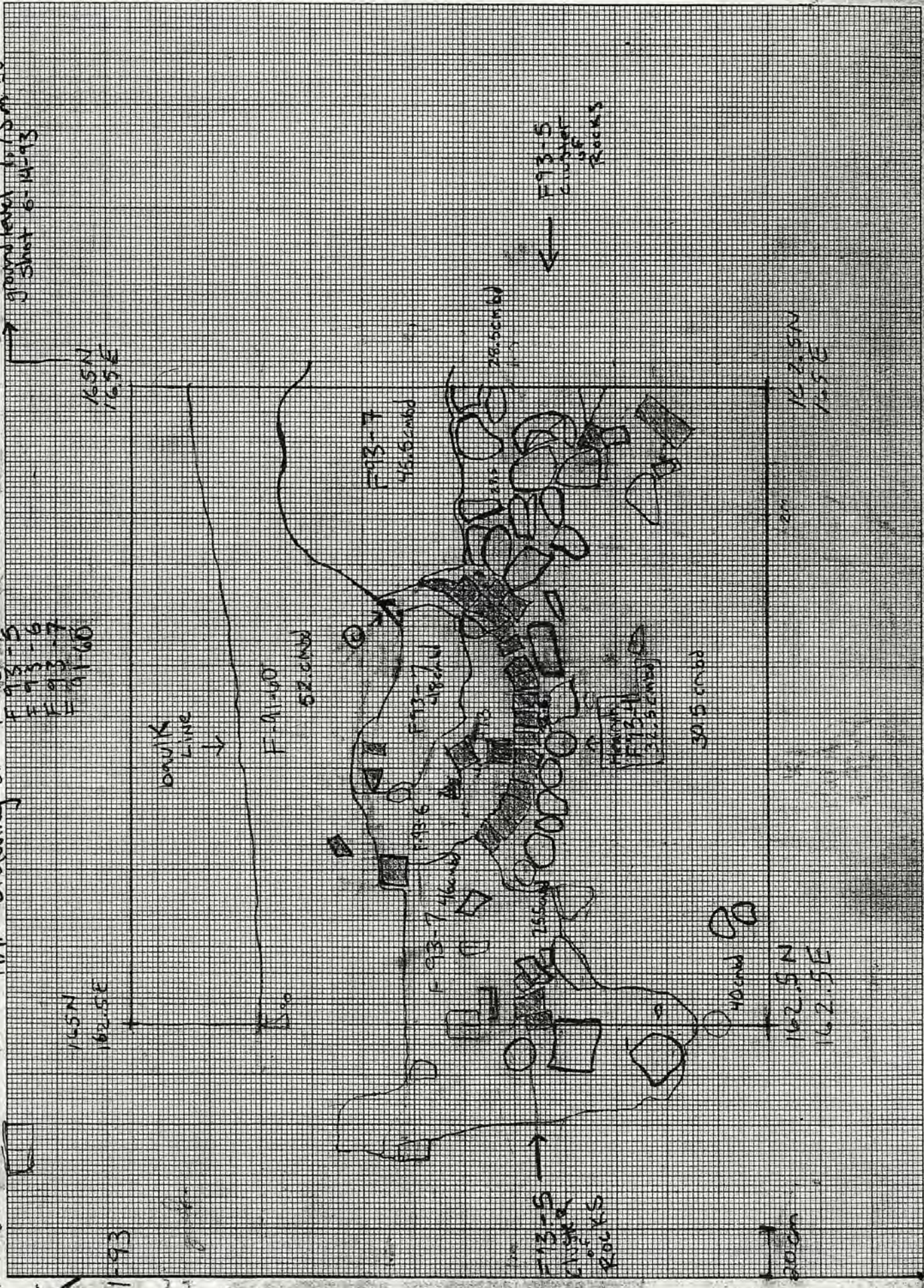

165N
162.5E

165N
165E

DRAIN
LINE

F-11-00
62cmhd

F93-7
45.5cmhd

26.5cmhd

F93-5
SHUTTER
ROCKS

F93-11
36.5cmhd

30.5 cmhd

40cmhd

162.5N
162.5E

162.5N
165E

-11-93

F93-5
SHUTTER
ROCKS

200m

Scale 7 to 1 cm
Carly + Joel + Craig
44 He 388

6-1-1983

KEY to Plan Drawing of F93-4, F93-5, F93-6, F93-7, F93-8

- - Bricks
- - Rocks - outlined
- F93-4 C shaped hearth feature composed of brick and cobbles
- F93-5 Disarticulated stones surrounding F93-4
- F93-6 Dark brown sandy loam stain adjacent to F93-4
- F93-7 Irregular stains surrounding hearth composed mostly of brick rubble
- F93-8 Irregular brown stains surrounding hearth, mainly reddish with brick charcoal and char.
- ⊙ - charred wood →

Curles Field School 6-23-93 44 HE 388

Katherine & Jeff
SW Quad: 162.5N 162.5E (20m)
1mb F 2cm
F 93.4
5
7

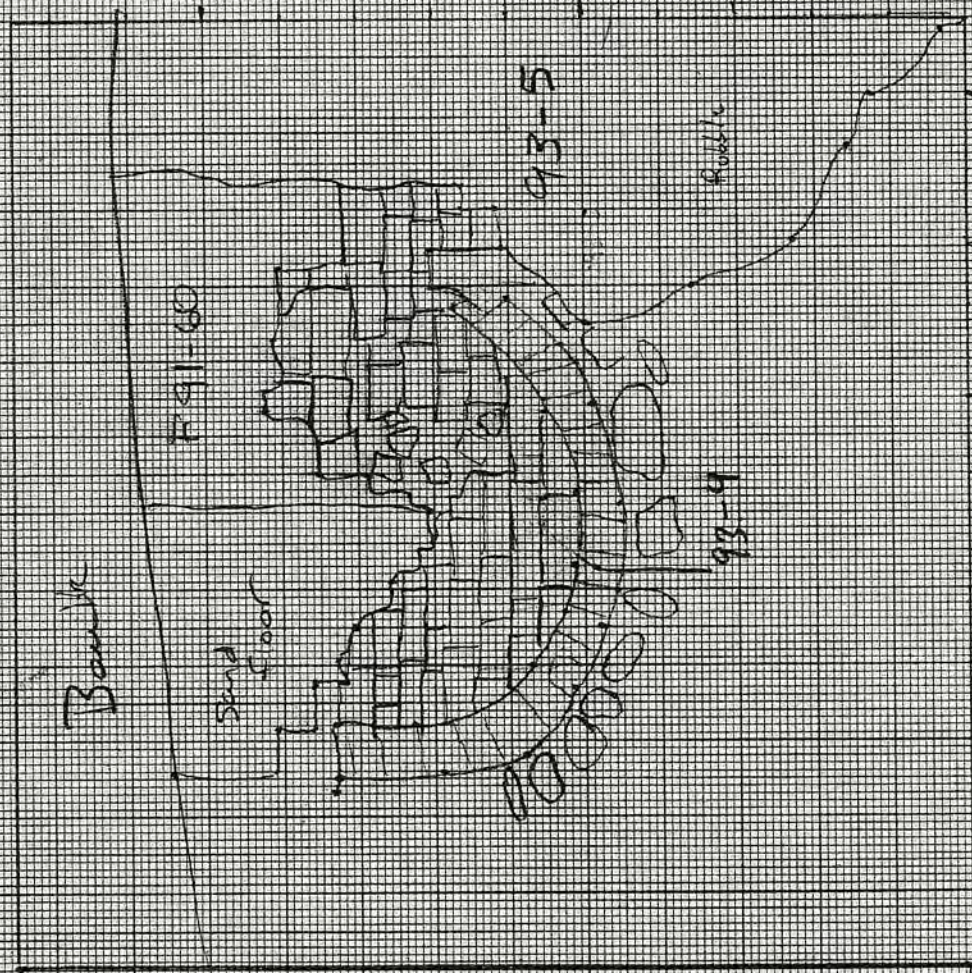

Feature Form

Site # 74HE388

Feature # 93-5

Block
Exact Prov. 162.5N 162.5/165 E

Type of Feature disarticulated stones surrounding F93-4

Association F93-4, 93-9

EU Numbers 8026, 9074

Dimensions Appx. 1m(N-S) x 2m(E-W) 10-30 cm deep

Excavation Notes: Include EU # used, portion excavated, soil conditions, artifacts recovered, other observations

EU# 8026 Removed large rocks and bricks (appx. 10 cobbles, 7 bricks) from surface of area front ^(part) light brown sandy soil (F# 93-9). Revealed small amounts of same soil underneath (rocks were resting in F# 93-9).

EU# 8074 - Removed cobbles and bricks (some whole, mostly broken) from atop F# 91-63 - a brick and charcoal flecked wash layer; fairly sandy. Some nails and other unidentified metal objects were found adhered (probably corroded to) bricks & cobbles. Some bricks and cobbles also →
Dated Started 6/16/93 Finished 6/16/93

Profiled _____ Plan Drawn 6.14.93 Photos _____

Samples Taken _____

Excavated by (All) CAW CLW

scale of top 1 cm
 Wily & Todd + C. Dig
 147e388

K&E 10 X 10 TO THE CENTIMETER 18 X 25 CM.
 KEUFFEL & ESSER CO. MADE IN U.S.A.

46 1510

of 2

PLAN Drawing of F93-H

ground level 1573m hd
 sheet 6-14-93

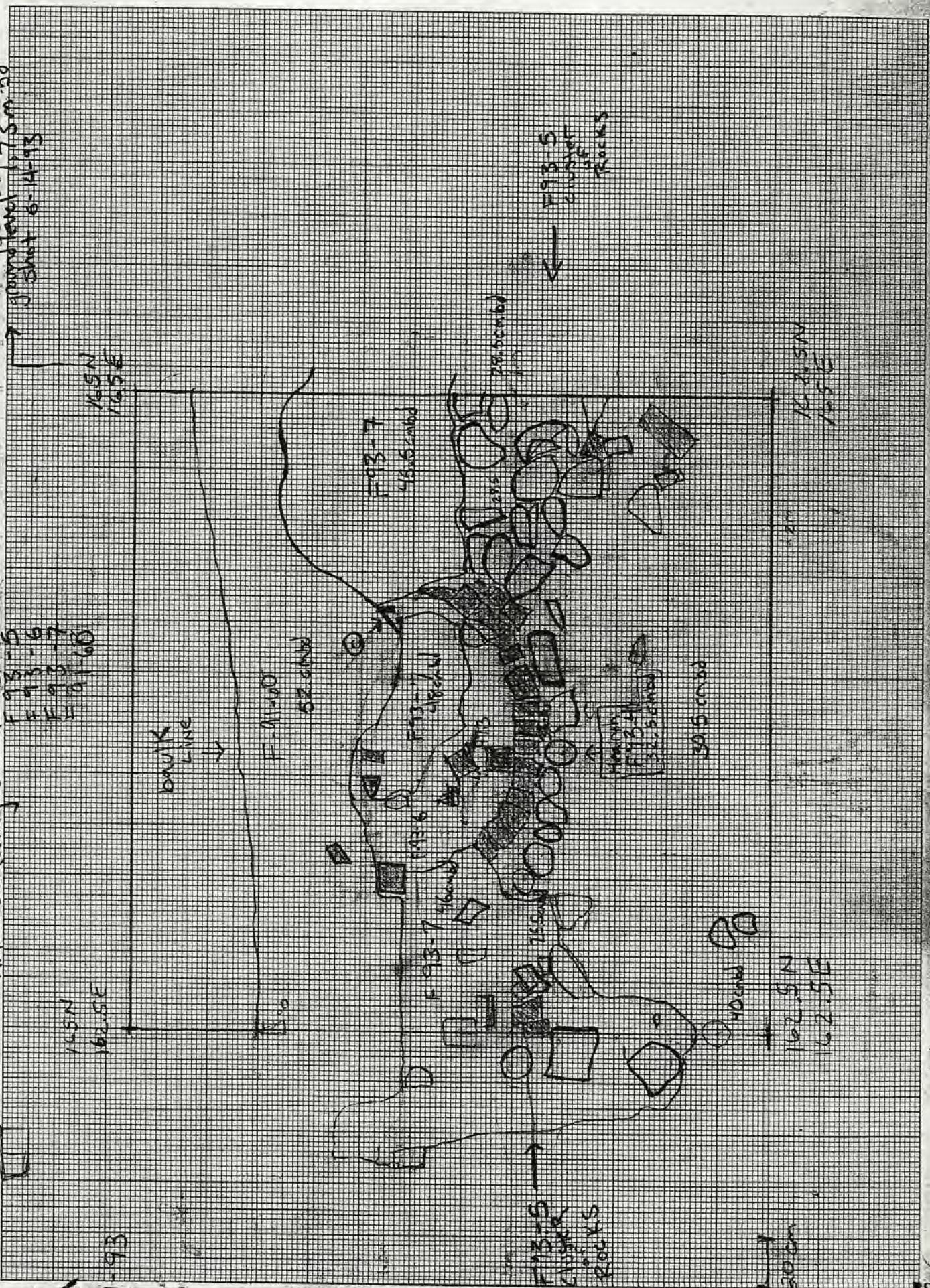

←

-11-93

Shade
 One

F93-5
 cluster
 of
 rocks

F93-5
 cluster
 of
 rocks

200 cm

Scale 2 to 1 cm

Carly + Joel + Chris
44 He 388

N
6-1-1983

KEY to PLAN Drawing of F93-4; F93-5; F93-6; F93-7; F93-8

■ - BRICKS

○ - ROCKS - outlined

F93-4 C Shaped hearth feature composed of brick and cobbles

F93-5 Disarticulated stones surrounding F93-4

F93-6 DARK brown sandy loam stain adjacent to F93-4

F93-7 irregular stain surrounding hearth composed mostly of brick rubble

F93-8 irregular brown organic feature surrounding hearth, heavily mottled with brick, charcoal and char.

⊙ - charred wood →

Curles Field School 6-23-93 44 HE 388

Katherns & Jeff
SW Quad: 162 SW 162 SE
1 mi E 2 mi
F 93-4
5

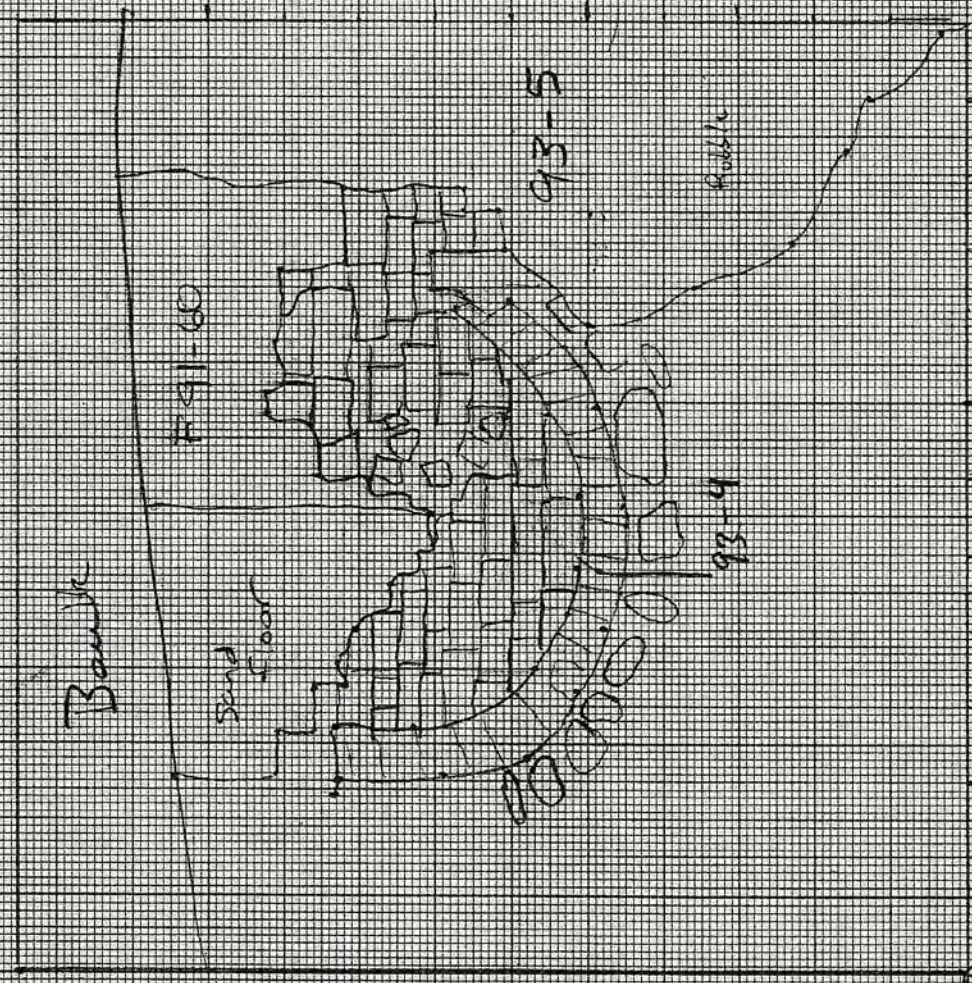

162 S W
162 S E

Corkle Field School - 6-23-93

Joel's Grand
SW quad 162.5 N 165 E
1 mm = 2 cm
F# 93-5 bedrock
91-63 fill
93-29 floor
93-30 trench (robbins)

* Brick and rock drawings in
NOTE F# 93-5 & F# 92-29 are not precisely accurate.

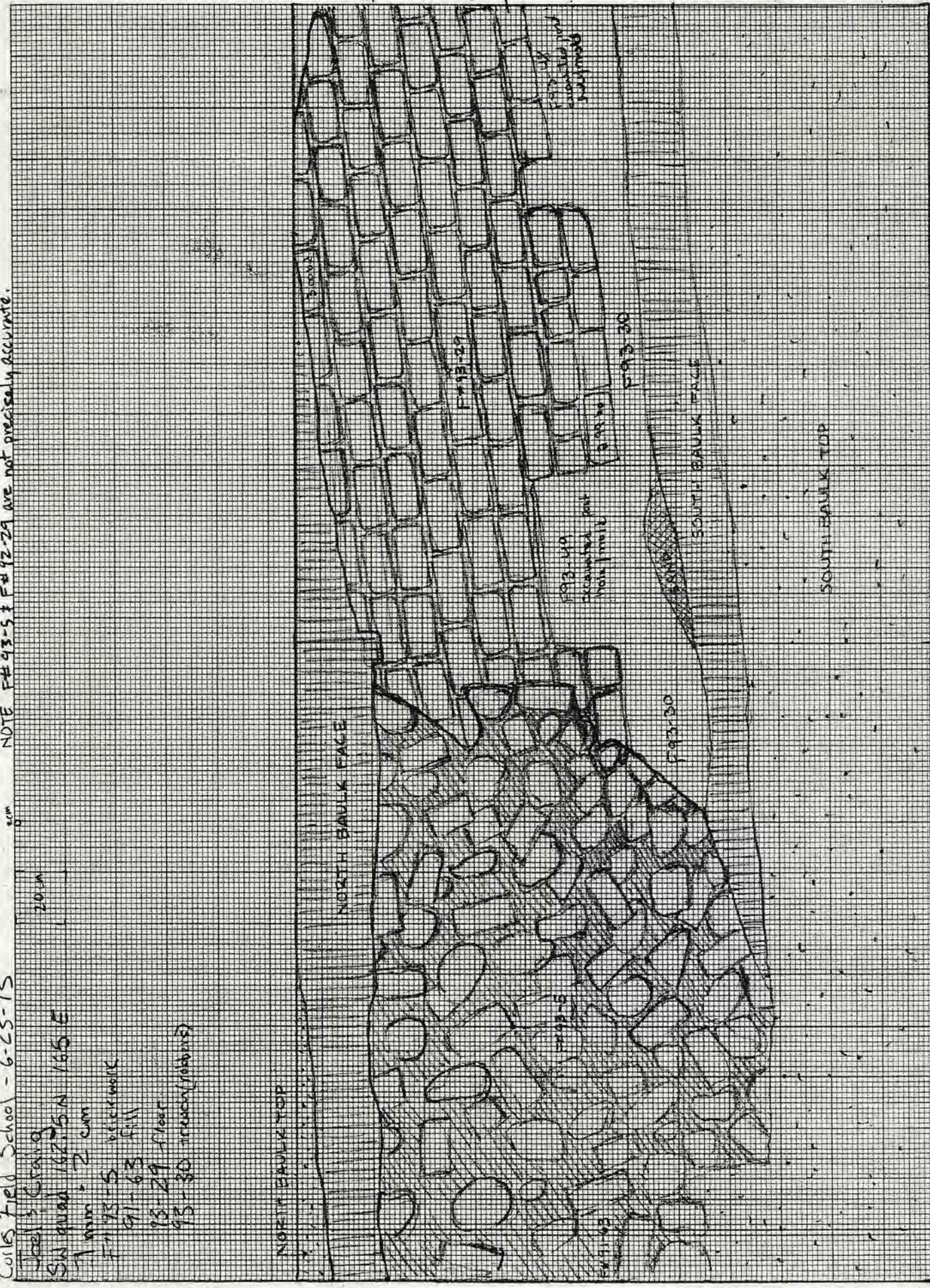

162.5 N 162.5 E

162.5 N 165 E

Datum depths from transit 1.19 b.d.

Feature Form

Site # 44HE388

Feature # 93-6

Block
~~Exact~~ Prov. 162.5 N 162.5 E

Type of Feature dark brown sandy loam stain adjacent to F93-4

Association F93-4

EU Numbers 8027, T93-3

Dimensions _____

Excavation Notes: Include EU # used, portion excavated, soil conditions, artifacts recovered, other observations

Cathy Poole removed by Cathy Poole in T93-3 in EU # 8027

See plan map for exact location, small localized feature.

Dated Started 6-16-93 Finished 6-17-93

Profiled _____ Plan Drawn 6-14-93 Photos _____

Samples Taken NO

Excavated by (All) CP



ale. d. tot 1 cm
rly + Jøet + C. 19
4He388

KE 10 X 10 TO THE CENTIMETER
KEUFFEL & ESSER CO. MADE IN U.S.A.

46 1510

1 of 2

ground level 1073 m - hd
Sheet 6-14-93

PLAN DRAWING OF F 93-41

F 93-5
F 93-6
F 93-7
F 91-60

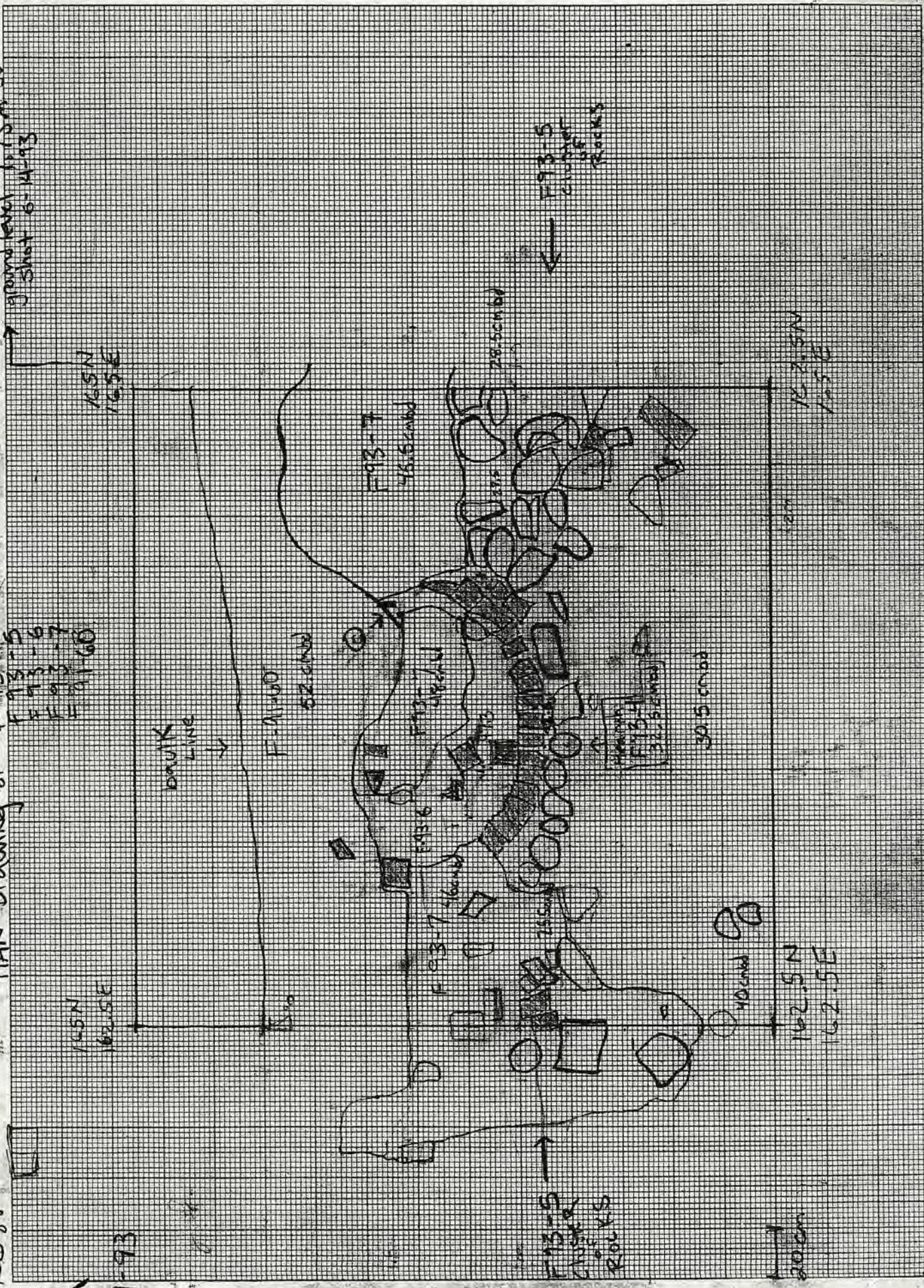

165N 165E

162.5N 162.5E

145N 162.5E

142.5N 162.5E

165N 165E

162.5N 162.5E

145N 162.5E

142.5N 162.5E

165N 165E

162.5N 162.5E

145N 162.5E

142.5N 162.5E

165N 165E

162.5N 162.5E

145N 162.5E

142.5N 162.5E

165N 165E

162.5N 162.5E

145N 162.5E

142.5N 162.5E

165N 165E

162.5N 162.5E

145N 162.5E

142.5N 162.5E

165N 165E

162.5N 162.5E

145N 162.5E

142.5N 162.5E

165N 165E

162.5N 162.5E

145N 162.5E

142.5N 162.5E

165N 165E

162.5N 162.5E

145N 162.5E

142.5N 162.5E

165N 165E

162.5N 162.5E

145N 162.5E

142.5N 162.5E

165N 165E

162.5N 162.5E

145N 162.5E

142.5N 162.5E

165N 165E

162.5N 162.5E

145N 162.5E

142.5N 162.5E

165N 165E

162.5N 162.5E

145N 162.5E

142.5N 162.5E

165N 165E

162.5N 162.5E

145N 162.5E

142.5N 162.5E

165N 165E

162.5N 162.5E

145N 162.5E

142.5N 162.5E

165N 165E

162.5N 162.5E

145N 162.5E

142.5N 162.5E

165N 165E

162.5N 162.5E

145N 162.5E

142.5N 162.5E

165N 165E

162.5N 162.5E

145N 162.5E

142.5N 162.5E

165N 165E

162.5N 162.5E

145N 162.5E

142.5N 162.5E

165N 165E

162.5N 162.5E

145N 162.5E

142.5N 162.5E

165N 165E

162.5N 162.5E

145N 162.5E

142.5N 162.5E

165N 165E

162.5N 162.5E

145N 162.5E

142.5N 162.5E

165N 165E

162.5N 162.5E

145N 162.5E

142.5N 162.5E

165N 165E

162.5N 162.5E

145N 162.5E

142.5N 162.5E

165N 165E

162.5N 162.5E

145N 162.5E

142.5N 162.5E

165N 165E

162.5N 162.5E

145N 162.5E

142.5N 162.5E

165N 165E

162.5N 162.5E

145N 162.5E

142.5N 162.5E

165N 165E

162.5N 162.5E

145N 162.5E

142.5N 162.5E

165N 165E

162.5N 162.5E

145N 162.5E

142.5N 162.5E

165N 165E

162.5N 162.5E

145N 162.5E

142.5N 162.5E

165N 165E

162.5N 162.5E

145N 162.5E

142.5N 162.5E

165N 165E

162.5N 162.5E

145N 162.5E

142.5N 162.5E

165N 165E

162.5N 162.5E

145N 162.5E

142.5N 162.5E

165N 165E

162.5N 162.5E

145N 162.5E

142.5N 162.5E

165N 165E

162.5N 162.5E

145N 162.5E

142.5N 162.5E

165N 165E

162.5N 162.5E

145N 162.5E

142.5N 162.5E

165N 165E

162.5N 162.5E

145N 162.5E

142.5N 162.5E

165N 165E

162.5N 162.5E

145N 162.5E

142.5N 162.5E

165N 165E

162.5N 162.5E

145N 162.5E

142.5N 162.5E

165N 165E

162.5N 162.5E

145N 162.5E

142.5N 162.5E

165N 165E

162.5N 162.5E

145N 162.5E

142.5N 162.5E

165N 165E

162.5N 162.5E

145N 162.5E

142.5N 162.5E

165N 165E

162.5N 162.5E

145N 162.5E

142.5N 162.5E

165N 165E

162.5N 162.5E

145N 162.5E

142.5N 162.5E

165N 165E

162.5N 162.5E

145N 162.5E

142.5N 162.5E

165N 165E

162.5N 162.5E

145N 162.5E

142.5N 162.5E

165N 165E

162.5N 162.5E

145N 162.5E

142.5N 162.5E

165N 165E

162.5N 162.5E

145N 162.5E

142.5N 162.5E

165N 165E

162.5N 162.5E

145N 162.5E

142.5N 162.5E

165N 165E

162.5N 162.5E

145N 162.5E

142.5N 162.5E

165N 165E

162.5N 162.5E

145N 162.5E

142.5N 162.5E

165N 165E

162.5N 162.5E

145N 162.5E

142.5N 162.5E

165N 165E

162.5N 162.5E

145N 162.5E

142.5N 162.5E

165N 165E

162.5N 162.5E

Scale 2 to 1 cm

Cont'd of Joel + Grainger
44 He 388

N
6-1-1913

KEY to PLAN DRAWING of F93-4; F93-5; F93-6; F93-7; F93-8

■ Bricks

○ Rocks - outlined

F93-4 C shaped hearth feature composed of brick and cobbles

F93-5 Disarticulated stones surrounding F93-4

F93-6 Dark brown sandy loam stain adjacent to F93-4

F93-7 Irregular stains surrounding hearth composed mostly of brick rubble

F93-8 Irregular brown organic feature surrounding hearth, heavily mottled with brick charcoal and char.

⊙ charred wood →

Feature Form

Site # 44HE388

Feature # 93-7

Block

Exact Prov. 162.5 N 162.5 / 160 E

(# probably same as 91-56)

Type of Feature irregular stain surrounding hearth composed of mostly brick rubble

Association 93-4, 93-5

EU Numbers 9045, 9056

Dimensions Appr. 1m N-S, 1m E-W

Excavation Notes: Include EU # used, portion excavated, soil conditions, artifacts recovered, other observations

F#93-7 contains silt/water deposit and destruction debris. Soil is dark and silty in some areas while light and sandy in others. Excavation of #93-7 exposed large amounts of cobbles and whole bricks - perhaps associated w/ F# 93-4. A few (appr. 5) nails and a brass straight pen were found. F#93-7 surrounds F# 93-5

- excavation consisted mainly of cleaning F#93-7 fill from in and around F#93-5 (disarticulated stones)

- continued -

Dated Started 6/18/93 Finished 6/21/93

Profiled _____ Plan Drawn 6.14.93 Photos _____

Samples Taken NO

Excavated by (All) CW JH SS CW

ale of tot 1 cm
rly + Joer + C. sig
474388

K+E 10 X 10 TO THE CENTIMETER 18 X 25 CM.
KEUFFEL & ESSER CO. MADE IN U.S.A.

46 1510

of 1 of 2

PLAN Drawing of F 93-H

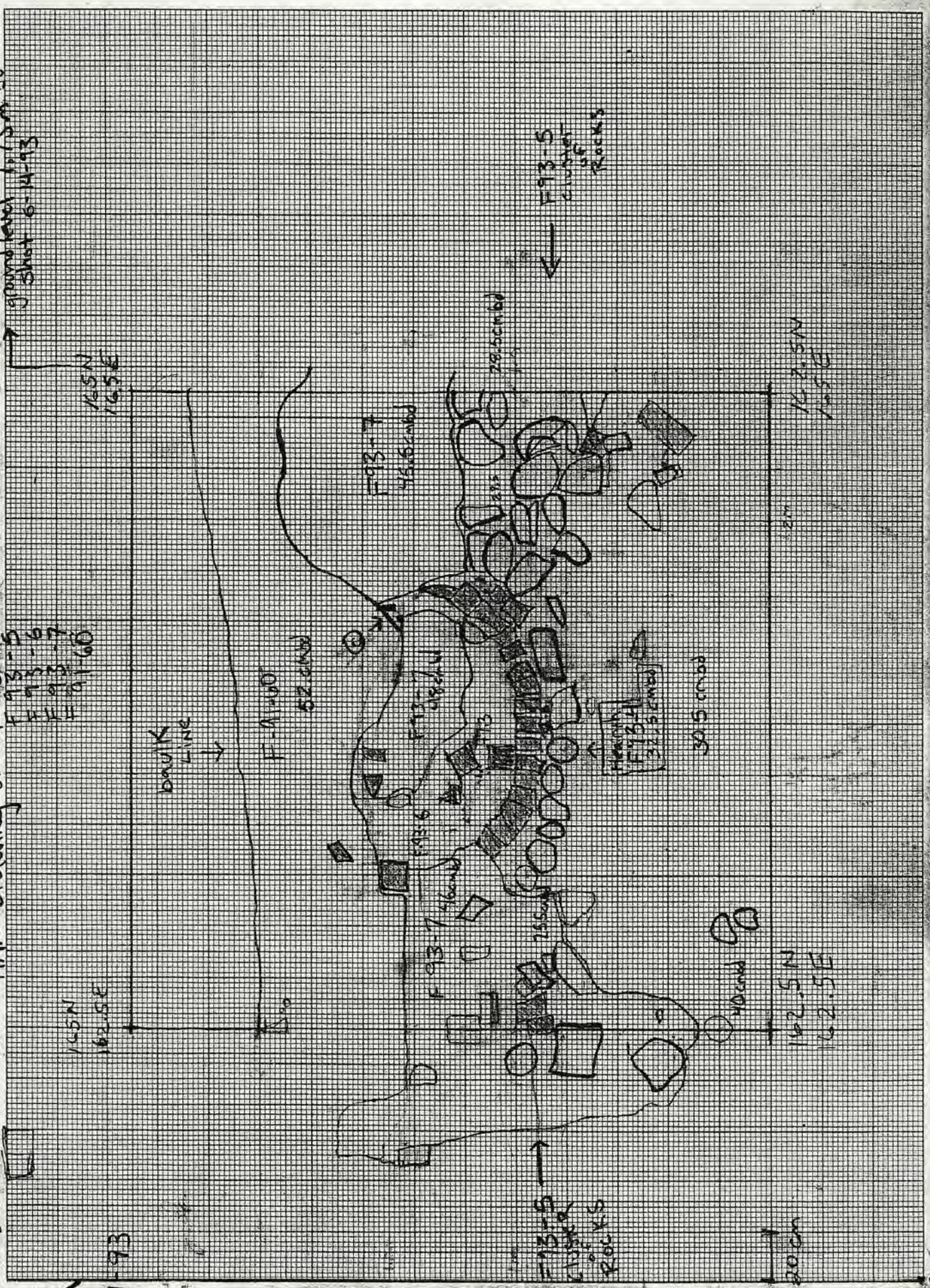

Scale 2 to 1 cm

Carly + Joel + Craig

44 HE 388

N

6-1-1913

KEY to Plan Drawing of F93-4; F93-5; F93-6; F93-7; F93-8

Bricks

○ - Rocks - outlined

F93-4 C Shaped hearth feature composed of brick and cobbles

F93-5 Disarticulated stones surrounding F93-4

F93-6 Dark brown sandy loam stain adjacent to F93-4

F93-7 Irregular stain surrounding hearth composed mostly of brick rubble

F93-8 Irregular brown organic feature surrounding hearth, mostly made of with brick charcoal and clay.

☉ - charred wood →

N 44He388

Sandy, moist, mucky

16.5N
16.5E
Ground line
1.75m BD station U-14-93

2 x 0.1 cm

Plan drawing

of F-93-10
91-60
93-9
93-5

Stoney aug
F-93-5

Bricks are
shaded

F93-5 disarticulated bones

F91-60 irregular brown organic

F93-9 - Irregular light brown
featuring possibly emburying

F93-10 - Burned bog or beam in
situ 95-9

Soil (possibly heavy) brick
Charcoal
mortar

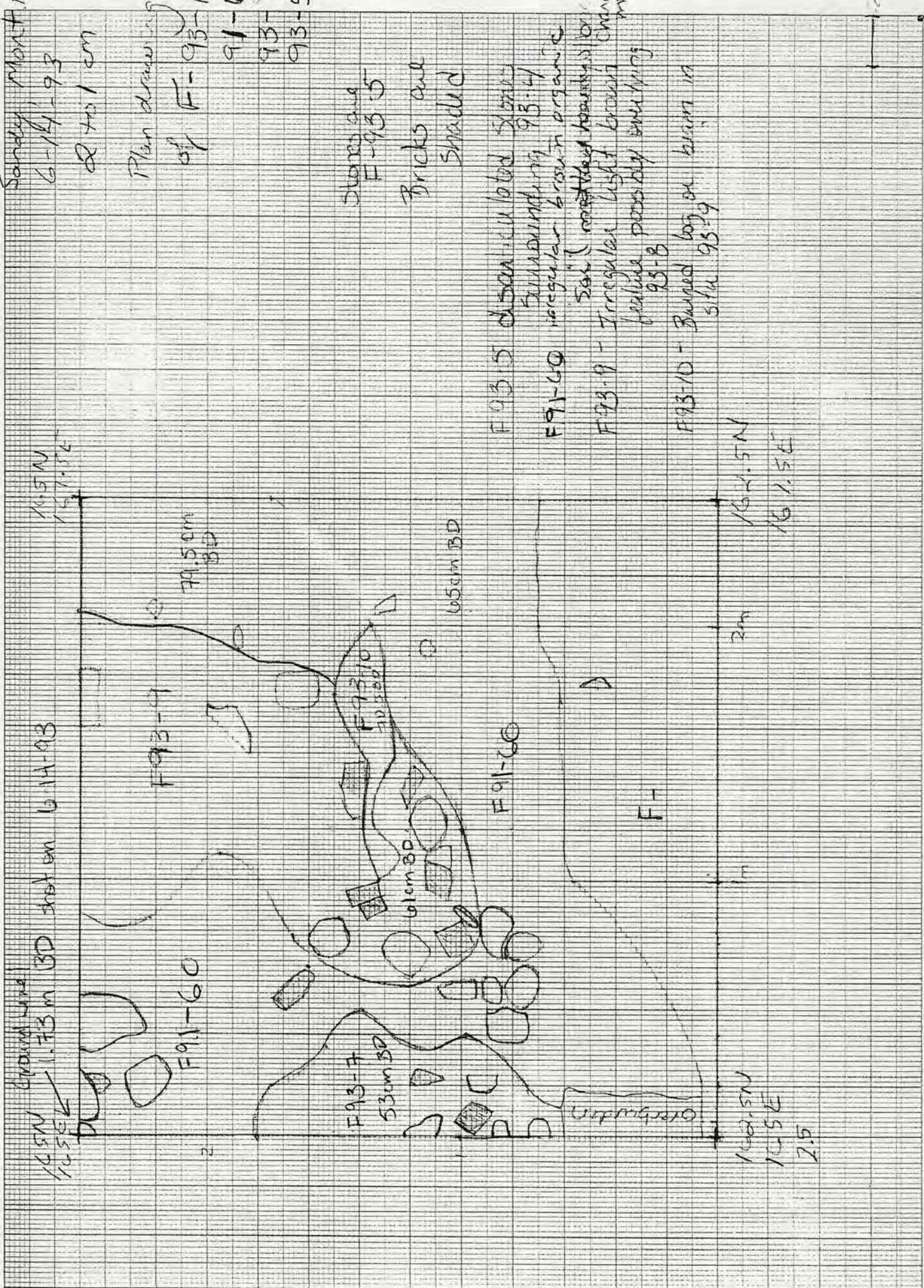

16.5N
16.5E
2.5

16.5N
16.5E

2m

79.5cm
BD

65cm BD

61cm BD

53cm BD

16.5N
16.5E

Feature Form

Site # 44HE388

Feature # 93-8

Exact Prov. 162.5 N 162.5/165 E

Type of Feature irregular non organic feature surrounding death area

Association REASSIGNED ORIGINAL FEATURE NUMBER

EU Numbers (8029 in block 162.5 N 167.5 E) 91-60

Dimensions _____

Excavation Notes: Include EU # used, portion excavated, soil conditions, artifacts recovered, other observations

paper work under all paper work under F91-60

Dated Started 6.16.93 Finished _____

Profiled _____ Plan Drawn 6.14.93 Photos _____

Samples Taken _____

Excavated by (All) _____

Curle's Field School 6-23-93 41 HE 388

Katherine & Jeff
SW Quad: 162 SW 162 SE
162 F 250
F 93.4
9

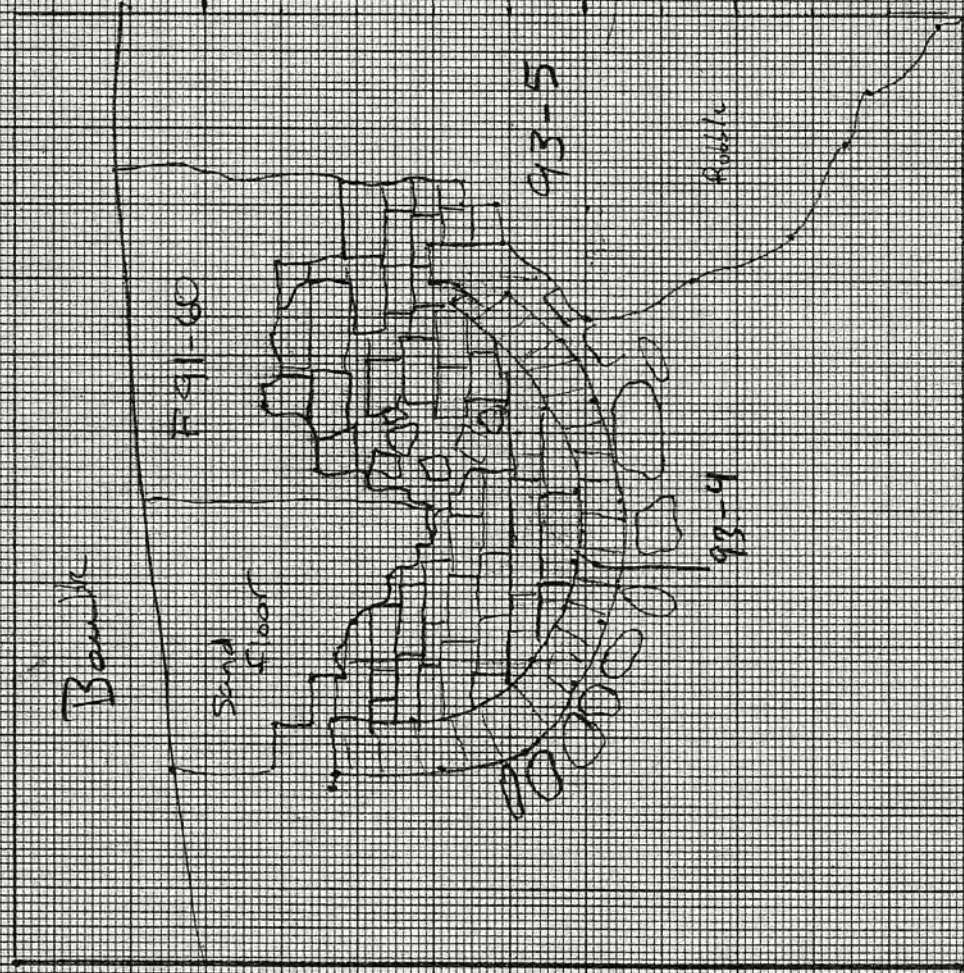

162 SW
162 SE

ale. 2 to 1 cm
ly + Joel + C. Rig
4He388

K&E 10 X 10 TO THE CENTI METER 18 X 25 CM.
KEUFFEL & ESSER CO. MADE IN U.S.A.

46 1510

pg 1 of 2

PLAN Drawing of F93-F1

Ground Level 17.3m hd
Shot 6-14-93

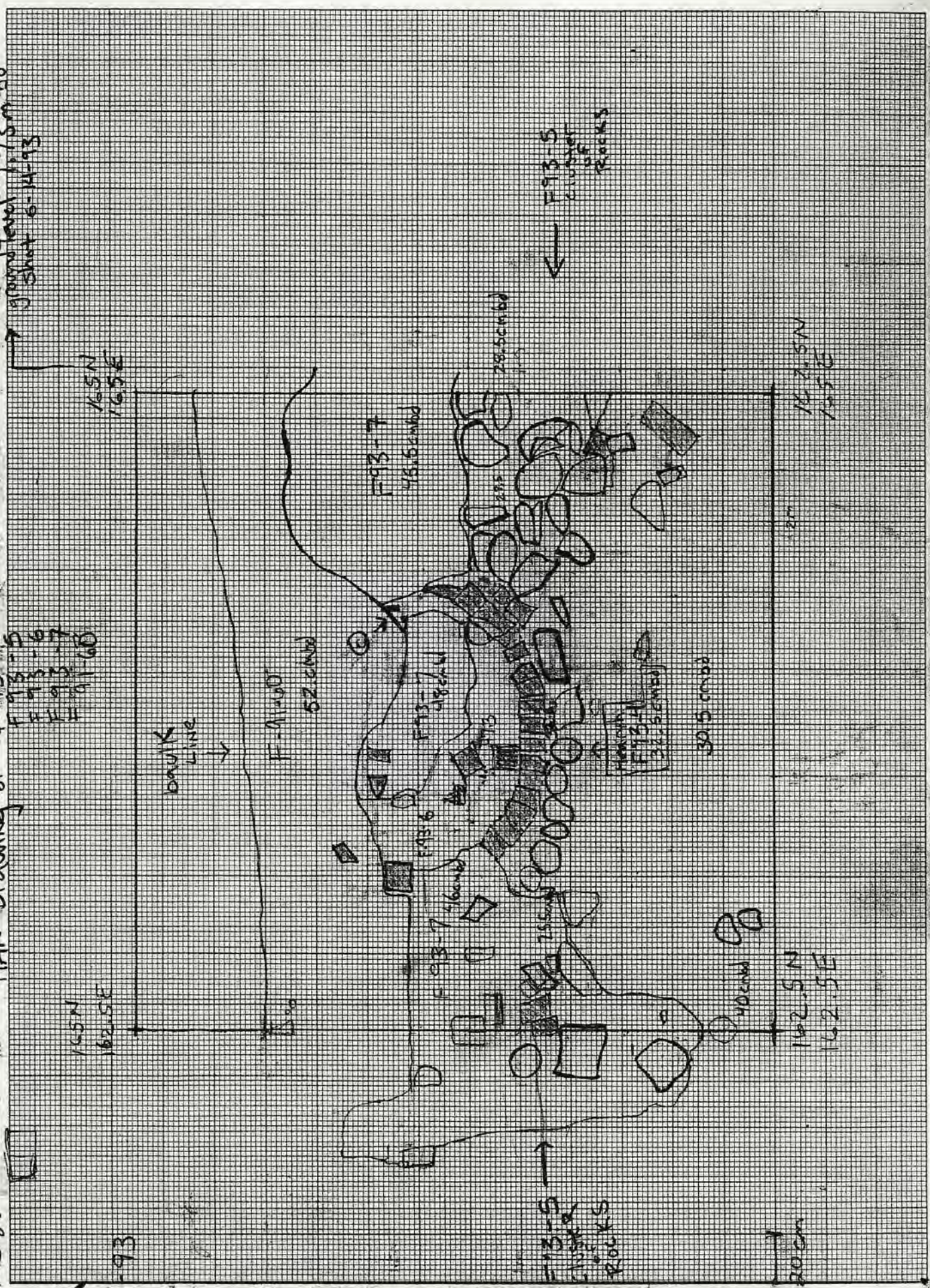

-11-93

20cm

Scale 2 to 1 cm
Carly + Joel + CPA 19
44 He 388
N
6-1-1973

KEY to Plan Drawing of F93-4, F93-5, F93-6, F93-7, F93-8

■ - BRICKS

○ - Rocks outlined

F93-4 C shaped hearth feature composed of brick and cobbles

F93-5 Disarticulated stones surrounding F93-4

F93-6 Dark brown sandy loam stain adjacent to F93-4

F93-7 Irregular stain surrounding hearth composed mostly of brick rubble

F93-8 Irregular brown organic feature surrounding hearth, mainly modeled with brick charcoal and char.

☉ - charred wood →

N 44He388

Sandy, moist mound

16.5m
16.5E
Circular mound
1.73m BD station U-14-93

14.5m
15.75E

2 x 101 cm

Plan drawing
of F-93-10
91-60
93-9
93-5

Stores are
F-93-5
Bricks are
shaded

F-93-5 disarticulated stone
surrounding 93-4
F-91-60 irregular brown organic
Soil ~~moist~~ heavily brick
F-93-9 - Irregular light brown
feature possibly emptying
93-8
F-93-10 - Burned log or branch in
situ 93-9

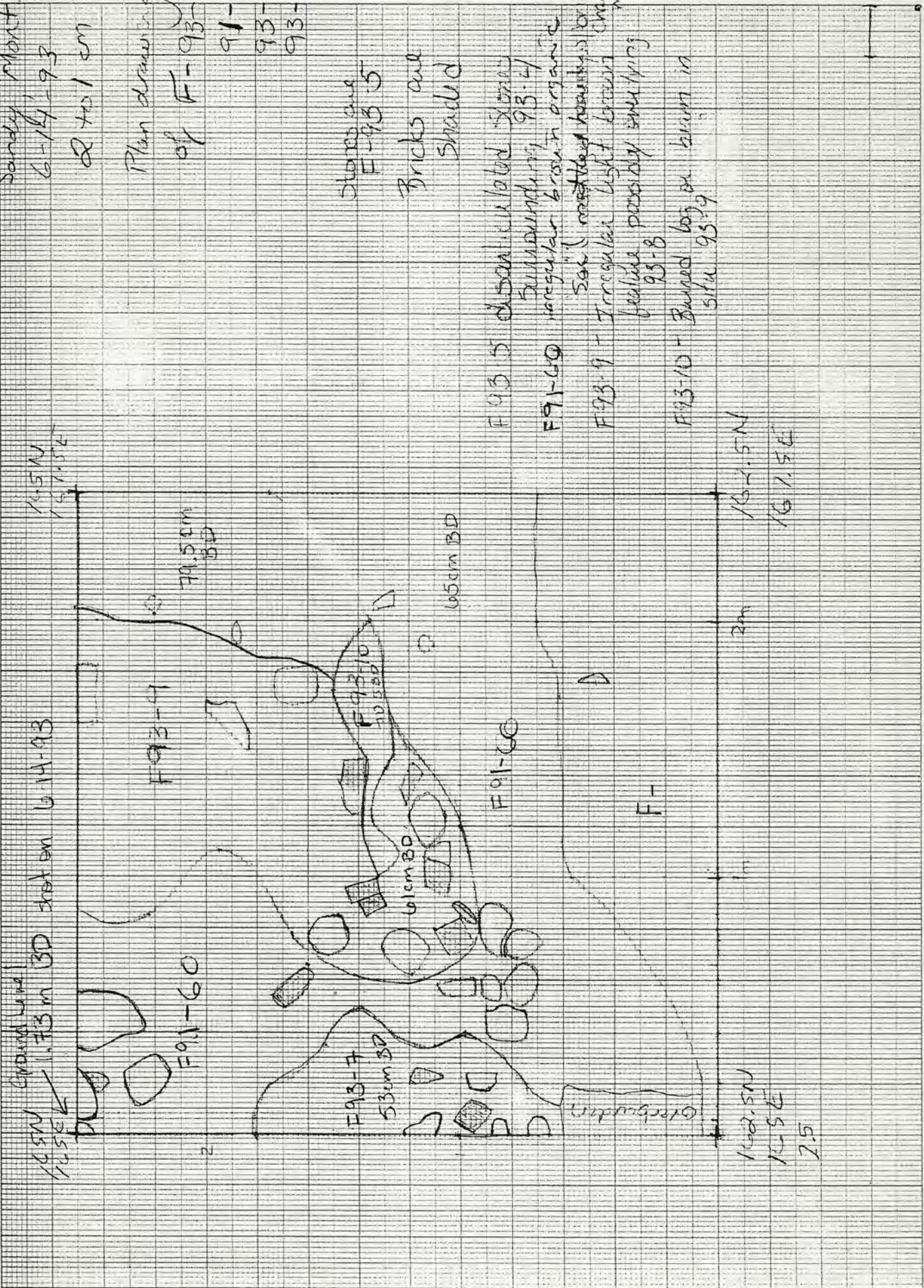

16.5m
16.5E
2.5

16.5m
16.5E