

Feature Form

Site # 44HE388

Feature # 93-45

Block

Exact Prov. 162.5 N 162.5E

Type of Feature "arch" fireplace and wall, west wall Harris House

Association under "C-shaped hearth" F93-4

EU Numbers _____

Dimensions _____

Excavation Notes: Include EU # used, portion excavated, soil conditions, artifacts recovered, other observations

Feature not excavated.

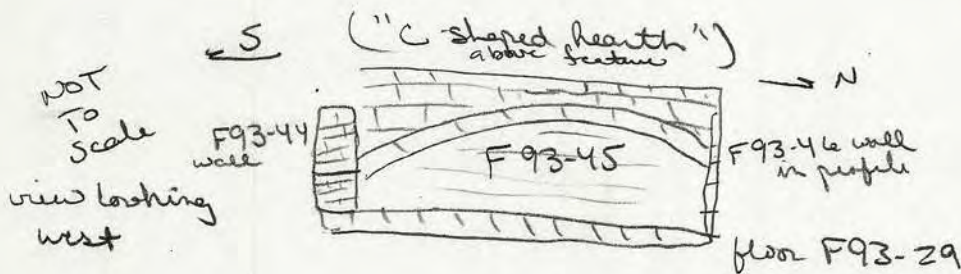

Dated Started N/A Finished N/A

Profiled N/A Plan Drawn N/A Photos 7-9-93

Samples Taken N/A

Excavated by (All) N/A

Feature Form

Site # 44HE388

Feature # 93-46

Block

Exact Prov. 162.5N 162.5-165 E

Type of Feature brick wall running E. from F93-45 approx. 1 meter

Association abuts F93-45

EU Numbers _____

Dimensions _____

Excavation Notes: Include EU # used, portion excavated, soil conditions, artifacts recovered, other observations

possible interior wall running from "arch" firebox wall under "C-shaped hearth" east approx 1 meter. In profile of vault. Not excavated.

Dated Started N/A Finished N/A

Profiled N/A Plan Drawn N/A Photos _____

Samples Taken N/A

Excavated by (All) N/A

Feature Form

Site # 44HE388

Feature # 93-47

Exact Prov. 164 W 169.10 E

Type of Feature unexcavated post hole in F93-30

Association F93-30 robbery trench

EU Numbers N/A

Dimensions unknown

Excavation Notes: Include EU # used, portion excavated, soil conditions, artifacts recovered, other observations

"post hole" theorized for this feature after it was determined that the Harpers House was of brick masonry / post construction. Feature lies in trench dug possibly in 1987. No EU given because feature was already gone.

Dated Started _____ Finished _____

Profiled _____ Plan Drawn _____ Photos _____

Samples Taken _____

Excavated by (All) _____

Feature Form

Site # 44 HE 388

Feature # 93-48

Exact Prov. 163.90 N 167.10 E

Type of Feature excavated post hole

Association in robbery trench F93-30

EU Numbers N/A

Dimensions unknown

Excavation Notes: Include EU # used, portion excavated, soil conditions, artifacts recovered, other observations

This feature was thought to be part of the robbery trench F93-30, but was later recognized as a post hole after excavation, no separate EU given because of this.

It is important to note that before the last 3-4 feet of fill was removed over floor of house that a gopher hole was seen running down to where this feature was, later found (feature was first thought to be gopher disturbance in robbery trench). This hole was not filled in and ran straight down from ground level (at pre-excavation time). It should be noted that no such destruction fill was in hole, suggesting that this post was in place after destruction and filling of house and rotted in place. Later, gophers keyed in on this soft, rubble-free fill to make their holes.

Dated Started 6-24-93 Finished 6-25-93 (as part of F93-30)

Profiled N/A Plan Drawn 7-9-93 Photos 7-9-93

Samples Taken ND

Excavated by (All) Jeff, Catherine

Coiles Field School - 6-23-93

Wood & Gravel
SW quad 162.5N 165 E
T.M.M. - 2 cm
F# 93-5 biter mark
91-63 FIN
93-29 floor
93-30 - ceiling (robbed)

Brick and rock drawings in NOTE F# 93-5 & F# 92-29 are not precisely accurate.

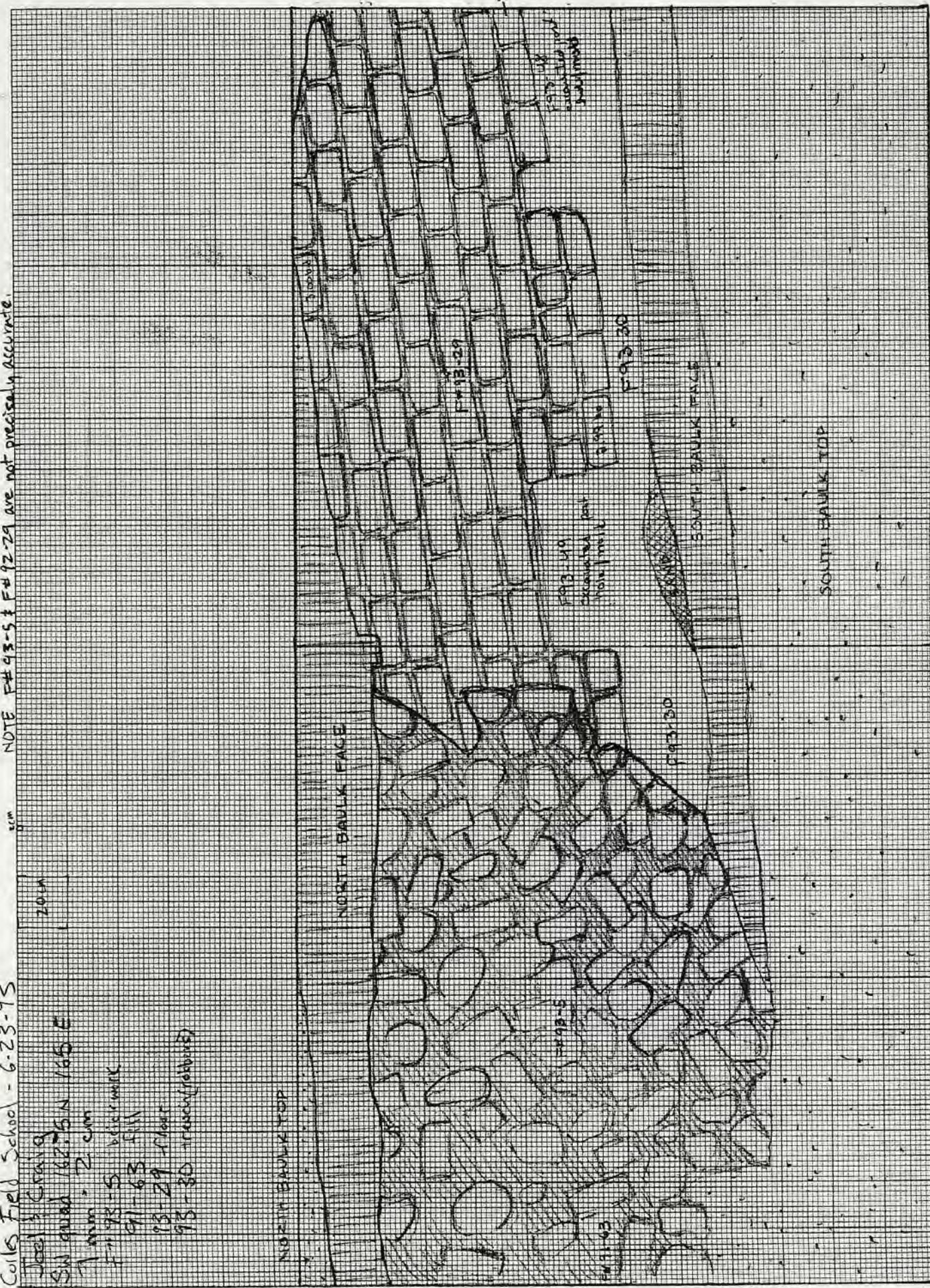

162.5N, 165 E Datum Depths from transit 1.19 b.d.

Feature Form

Site # 44HE388

Feature # 93-49

Exact Prov. 63.90N 115.30E

Type of Feature excavated post hole

Association in wooden trench F93-30

EU Numbers _____

Dimensions _____

Excavation Notes: Include EU # used, portion excavated, soil conditions, artifacts recovered, other observations

see feature form for 93-48 for further info.

Same conditions as F93-48, not seen until after excavation.

Gopher holes ran straight down into this feature as w/ F93-48, important difference however is that this gopher hole branched off a little ways down, indicating possibly that there were 2 parts in this feature, this is further backed up by the large size of the feature relative to F93-48

Dated Started 6-24-93 Finished 6-25-93

Profiled NA Plan Drawn 7-9-93 Photos 7-9-93

Samples Taken w/4

Excavated by (All) [Signature]

Coles Field School - 6-23-93

Joel & Craig
SW quad 162.5N 165 E
1/4 sec - 2 cum
F# 93-5
91-63 fill
93-29 - float
93-30 - rebar (robbers)

NOTE F# 93-5 & F# 92-29 are not precisely accurate.

20m

NORTH BULK TOP

NORTH BULK FACE

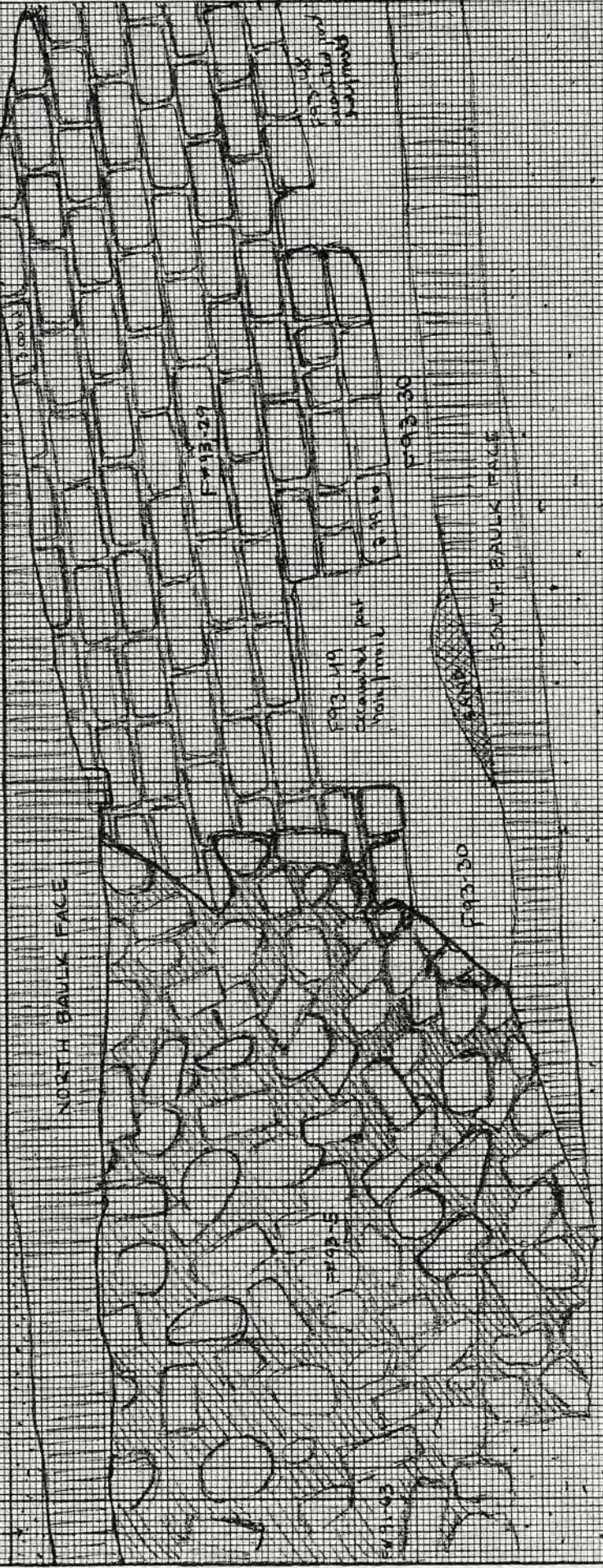

2.99 m

F# 93-30
occasional rebar
float

F# 93-30

F# 93-30

SOUTH BULK FACE

SOUTH BULK TOP

162.5N/167.5E

162.5N/165E

Datum Depths from transit 1.19 b.d.

Feature Form

Site # 44HE388

Feature # 93-50

Exact Prov. 163.5 N 165.8 E

Type of Feature post hole

Association west of F93-49, in floor 93-29, abuts wall 93-44 hole F93-51

EU Numbers _____

Dimensions _____

Excavation Notes: Include EU # used, portion excavated, soil conditions, artifacts recovered, other observations

the wall support not excavated probable wall support part of S. wall basis House, not excavated

Dated Started W/IT Finished N/A

Profiled _____ Plan Drawn 7-9-93 Photos 7-9-93

Samples Taken NO

Excavated by (All) N/A

Feature Form

Site # 44HE388

Feature # 93-51

Exact Prov. 163.4 N 166 E

Type of Feature post mold

Association in post hole F93-50

EU Numbers _____

Dimensions _____

Excavation Notes: Include EU # used, portion excavated, soil conditions, artifacts recovered, other observations

not excavated

Dated Started N/A Finished N/A

Profiled N/A Plan Drawn 7-9-93 Photos 7-9-93

Samples Taken NO

Excavated by (All) N/A

Feature Form

Site # 44HE388

Feature # 93-52

Exact Prov. 1639 N 165.5 E

Type of Feature probable hearth hood support post hole

Association in floor F93-29

EU Numbers _____

Dimensions _____

Excavation Notes: Include EU # used, portion excavated, soil conditions, artifacts recovered, other observations

nw @ 30 cm. from F93-50

not excavated

Dated Started N/A Finished N/A

Profiled N/A Plan Drawn 7-9-93 Photos 7-9-93

Samples Taken NO

Excavated by (All) N/A

Carle's Field School 7/9/93

165 N 165 E
1.93 Below Datum

168 S N 165 E
CRAB SOFL KATHERINE

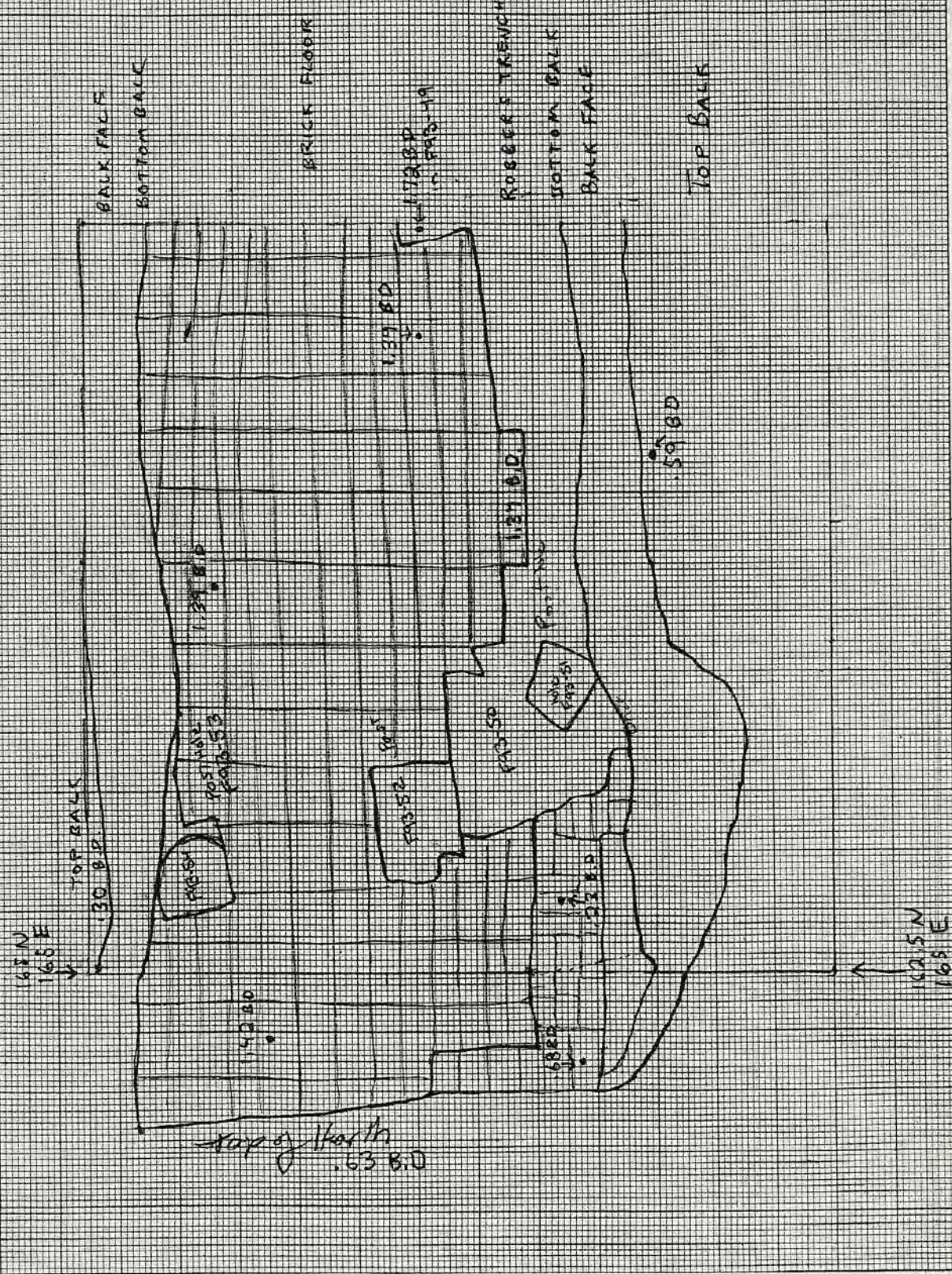

Feature Form

Site # 44HE388

Feature # 93-53

Exact Prov. 164.65N 165.20E

Type of Feature post hole, possible hearth hood support

Association in floor 93-29, at end of and abutting it on S. side of wall F93-46

EU Numbers _____

Dimensions _____

Excavation Notes: Include EU # used, portion excavated, soil conditions, artifacts recovered, other observations

excavated
no excavated

Dated Started N/A Finished N/A

Profiled N/A Plan Drawn 79-93 Photos 79-93

Samples Taken NO

Excavated by (All) N/A

Feature Form

Site # 44HE388

Feature # 93-54

Exact Prov. 164.9 W 165.15 E

Type of Feature post mold

Association in post hole F93-53

EU Numbers _____

Dimensions _____

Excavation Notes: Include EU # used, portion excavated, soil conditions, artifacts recovered, other observations

excavated NOT excavated

Dated Started N/A Finished N/A

Profiled N/A Plan Drawn 7-9-93 Photos 7-9-93

Samples Taken NO

Excavated by (All) N/A

Cyber Field School 7/9/93

4444A 388
F 93-42

168.5 N 165.5 E
ORIG. JOFL KATHERINE

165 N 165 E
1.93 Below Datum

148 N
168 E

107 BALS
130 B.D.

top of hearth
163 B.D.

142 B.D.

139 B.D.

137 B.D.

137 B.D.

132 B.D.

59 B.D.

142.5 N
165 E

BALK FACE
BOTTOM BALK

BRICK FLOOR

161.72 B.D.
IN P. 93-19

ROBBERS YENCH
BOTTOM BALK
BALK FACE

TOP BALK

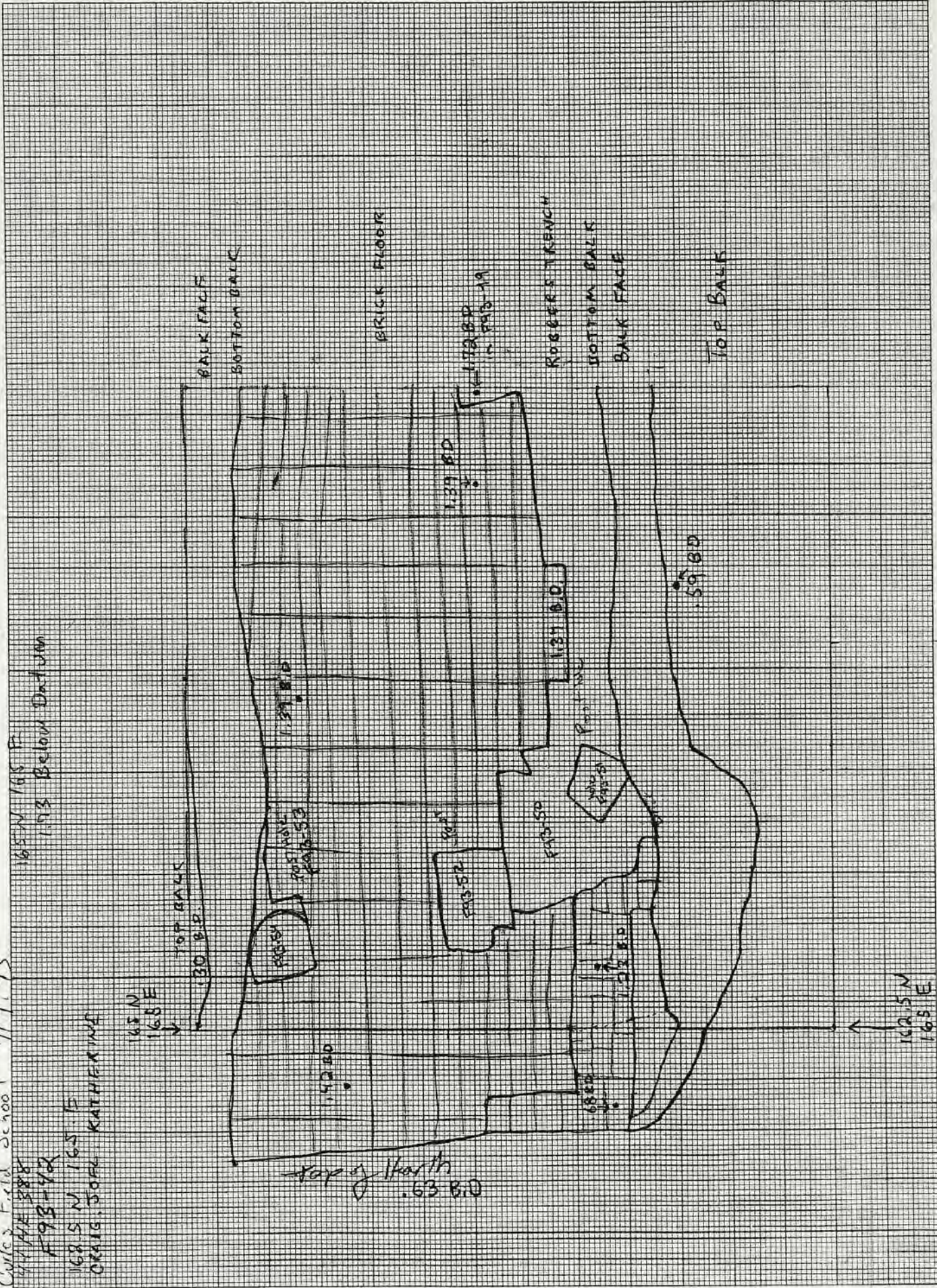

FEATURE RECORD

(attach all drawings)

FEAT # 93-55

SITE # Curles
44 HE 388

TYPE OF FEATURE Builders Trench mixed with possible robbers trench from North wall of Harris House (F 93-38).

PROVENIENCE(S) Trench 93-1

FEATURES OVERLYING: 93-34 93-58 91-34 91-33

FEATURES UNDERLYING: 93-38 93-39 _____

RELATED FEATURES: _____

Date Drawn: 7/8/93 Date Started: 6/23/93 Finished: 7/8/93

Description of Feature, INCLUDING Soil description. Dimensions of Feature. Observations and notes on excavation.

Originally begun under the name F93-34 before that was assigned to the grey wash lenses which cover 93-55.

93-55 was visible in floor of T 93-1, when first profile drawn, as a darker line going across Trench floor. Apparently 93-55 was covered by a thin layer of what is now F93-34.

Digging revealed 5 courses of bricks in place in wall ⁽⁹³⁻³⁸⁾. Dirt was a slightly-darker-than-sub soil that was still yellowish with few artifacts. Soil sandy with lots of stones, brick pieces and charcoal in it.

A few stone flakes and a couple ferrous metal objects found
SEE Profiles of Trench wall and small profile of wall 93-38

EU's in this Feature: 8076 _____

Recorded by T. Cuddy Excavated By T. Cuddy M.M.

ALL DRAWINGS MUST HAVE ELEVATIONS!

Feature Form

Site # 44HE388

Feature # 93-55

Exact Prov. T93-1

Type of Feature hidden trench mixed w/ possible other trench outside
N. wall (F93-38) Harris House and slumped over wall fall F93-39

Association in T93-1

EU Numbers 8076

Dimensions _____

Excavation Notes: Include EU # used, portion excavated, soil conditions, artifacts recovered, other observations

Dated Started _____ Finished _____

Profiled _____ Plan Drawn _____ Photos _____

Samples Taken _____

Excavated by (All) _____

44 HE 000
6/22/93 46 1510
Tom Cuddy

PAGE 1 OF 2
TRENCH 93-1

Station d.p.H. 137.64 at 1675N 1675E

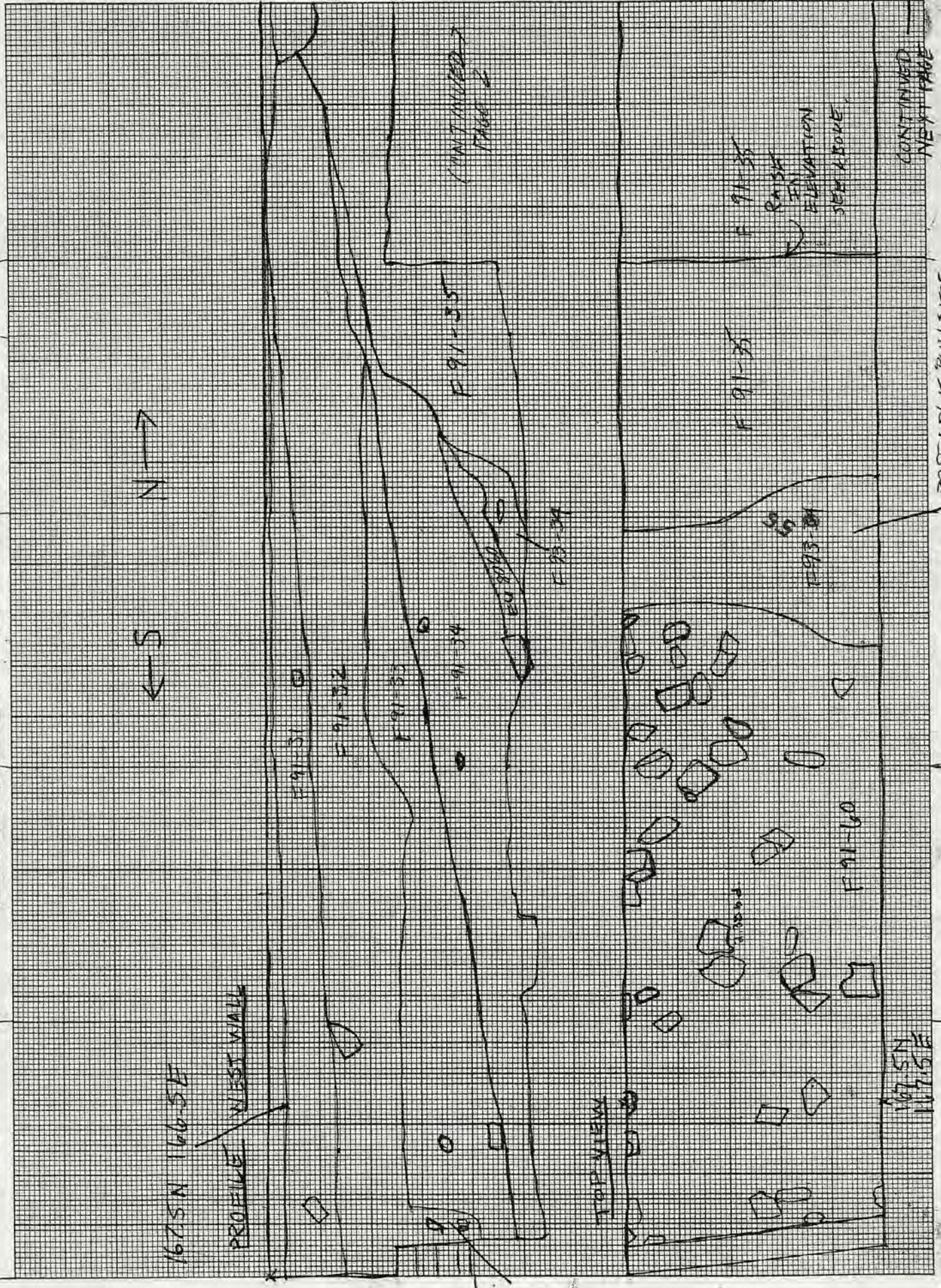

EU 2017

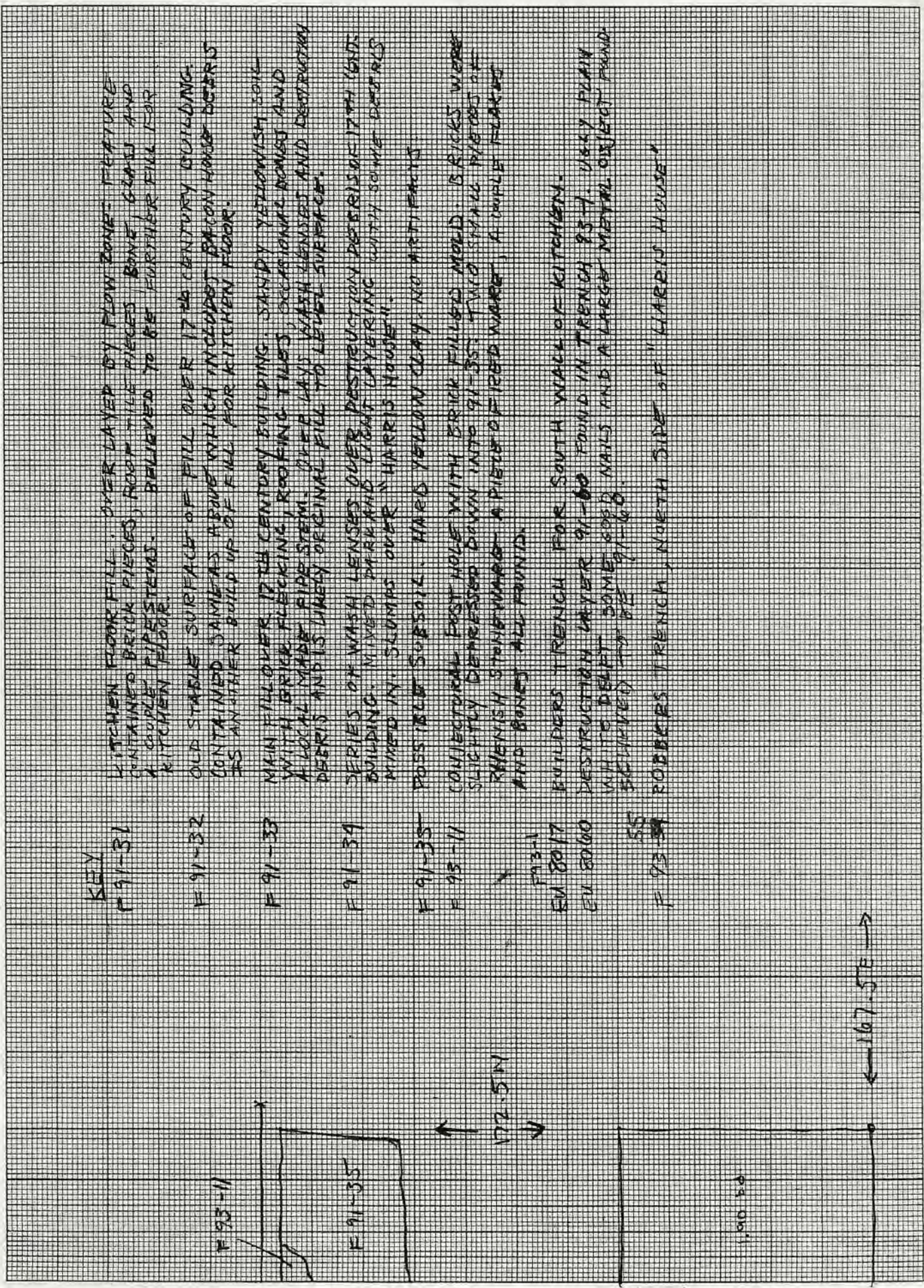

KEY
F 91-31

F 91-32

F 91-33

F 91-34

F 91-35

F 93-11

F 93-11

EV 8017

EV 8000

55

F 93-11

LITCHEN FLOOR FILL. OVER LAYED BY FLOW CONE FEATURE CONTAINED BRICK PIECES, ROOF TILE PIECES, BONE, GLASS AND A COUPLE PIPE STEMS. BELIEVED TO BE FURTHER FILL FOR KITCHEN FLOOR.

OLD STABLE SURFACE OF FILL OVER 17th CENTURY BUILDING. CONTAINED SANGERS ABOVE WHICH INCLUDES BACON HANG DOORS AS ANOTHER BUILD UP OF FILL FOR KITCHEN FLOOR.

MAIN FILL OVER 17th CENTURY BUILDING. SANDY YELLOWISH SOIL WITH BRICK FLECKING, ROOFING TILES, OCCASIONAL NAILS AND A LOCAL MADE PIPE STEM. OFF FILL WITH LENSES AND DEBRIS AND IS LIKELY ORIGINAL FILL TO LEVEL SURFACE.

SERIES OF WASH LENSES OVER DESTRUCTION DEBRIS OF 17th CND BUILDING. MIXED DARK AND LIGHT LAYERING WITH SOME DEBRIS MIXED IN. SLUMPS OVER 'HARRIS HOUSE'.

POSSIBLE SUBSOIL. HARD YELLOW CLAY. NO ARTIFACTS

CONJECTURAL FISH HOLE WITH BRICK FILLED MOUND. BRICKS WERE SLIGHTLY DEFORMED DOWN INTO 91-35 FILL WITH SMALL PIECES OF RHENISH STONEWARE. A PIECE OF RED WARE, A WHOLE FLAKE AND BONES ALL FOUND.

BUILDERS TRENCH FOR SOUTH WALL OF KITCHEN.

DESTRUCTION LAYER 91-60 FOUND IN TRENCH 93-1. VERY FLAT WITH DEPTH SOME 500 NAILS AND A LARGE METAL OBJECT FOUND BELIEVED TO BE 91-60.

ROBBERS TRENCH, NORTH SIDE OF 'HARRIS HOUSE'

1 SQUARE = 2 CM.

datum points taken from transit 1.19

44 HLF 580
7/2/93 46 1510
Tony CUDDY

K+E 10 X 10 TO THE CENTIMETER 18 X 25 CM
KEUFFEL & ESSER CO. MADE IN U.S.A.

TRENCH 93-1

EXTENSION OF WEST WALL PROFILE

1675N
1665E

20 CM BLOW LINE

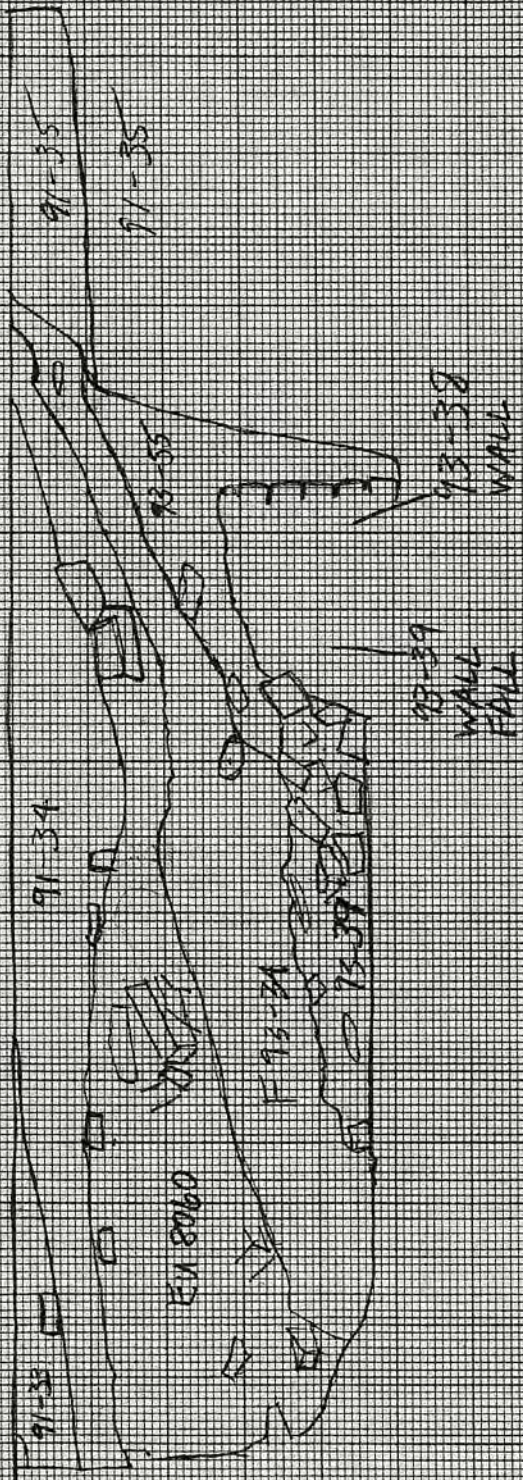

EN 8060

F 93-21

46 1510

7/8/93

TRENCH 93-1 PLAN DRAWING

TOM CUDDY

1 SQUARE = 2 CM

T.M.L.V.V.O.

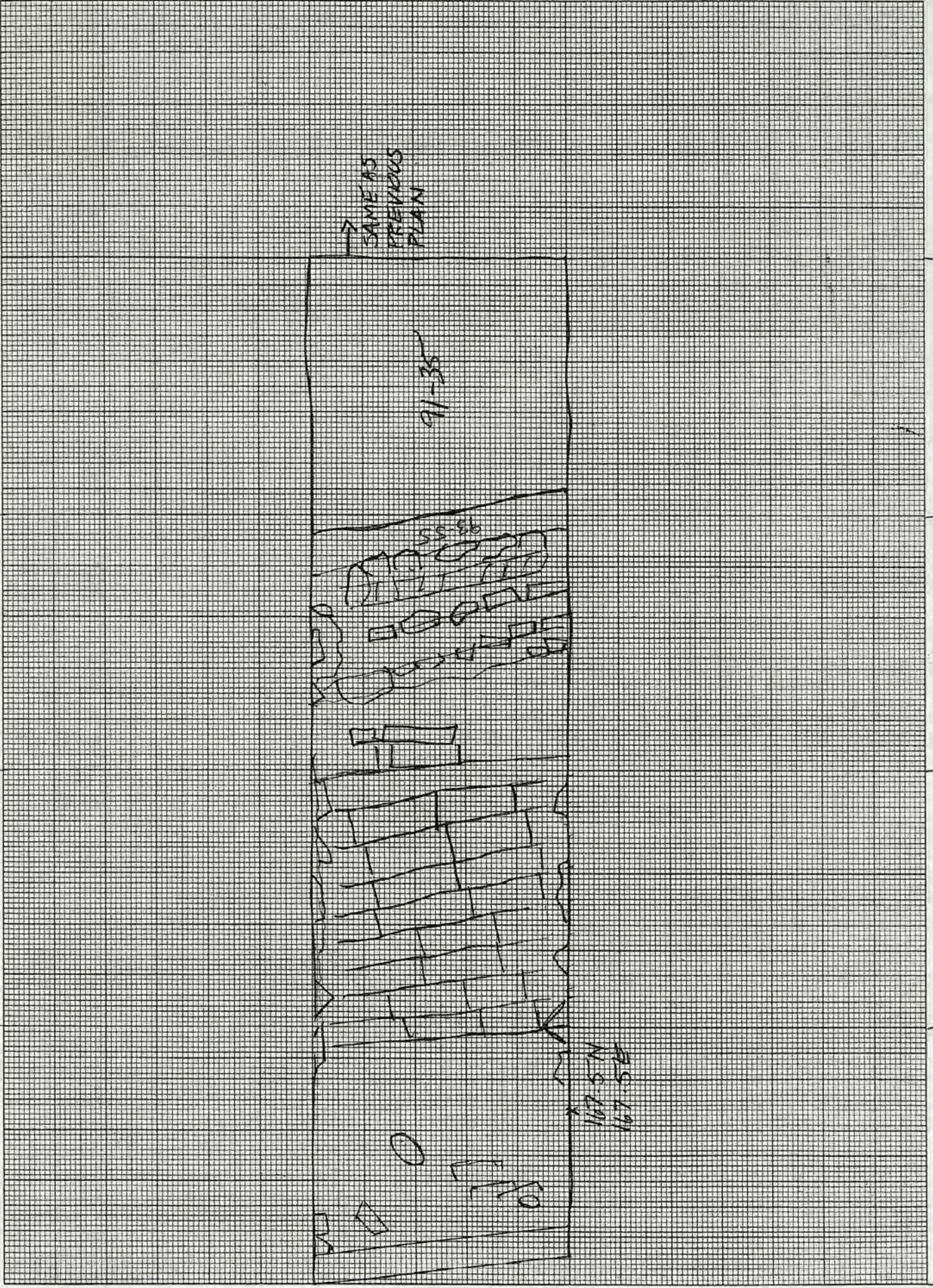

FEATURE RECORD

(attach all drawings)

FEAT # 93-56

SITE # Curles
44 HE 388

TYPE OF FEATURE Destruction layer

PROVENIENCE(S) T-93-1

FEATURES OVERLYING: 91-34 91-33 91-32 91-31

FEATURES UNDERLYING: 93-34 93-39 93-38

RELATED FEATURES: ^{Maybe} 91-60

Date Drawn: 7/8/93 Date Started: 6/23/93 Finished: 7/8/93

Description of Feature, INCLUDING Soil description. Dimensions of Feature. Observations and notes on excavation.

EU 8086 - Removal of "Harris House" destruction layer from T 93-1. Possibly associated with 91-43.

↑ This excavation revealed the obvious layer now labeled 93-56.

93-56 labeled as EU 8060 on profile after first part excavated. See lower half profile of T 93-1 to see layering.

Layer 93-56 is brick rubble, some large pieces, with mortar and gets much fatter close to the south end of trench. Bricks at southern end are piled in loose grey soil resembling ashes and it is thought there may have been a fireplace there.

EU's in this Feature: 8060 8086

Recorded by T.C. Excavated By T.C. M.M.

ALL DRAWINGS MUST HAVE ELEVATIONS!

44 ME 300
7/8/93 46 1510
Tom Cuddy

TRENCH 93-

EXTENSION OF WEST WALL PROFILE

1675N
1665E

80 CM BELOW LINE

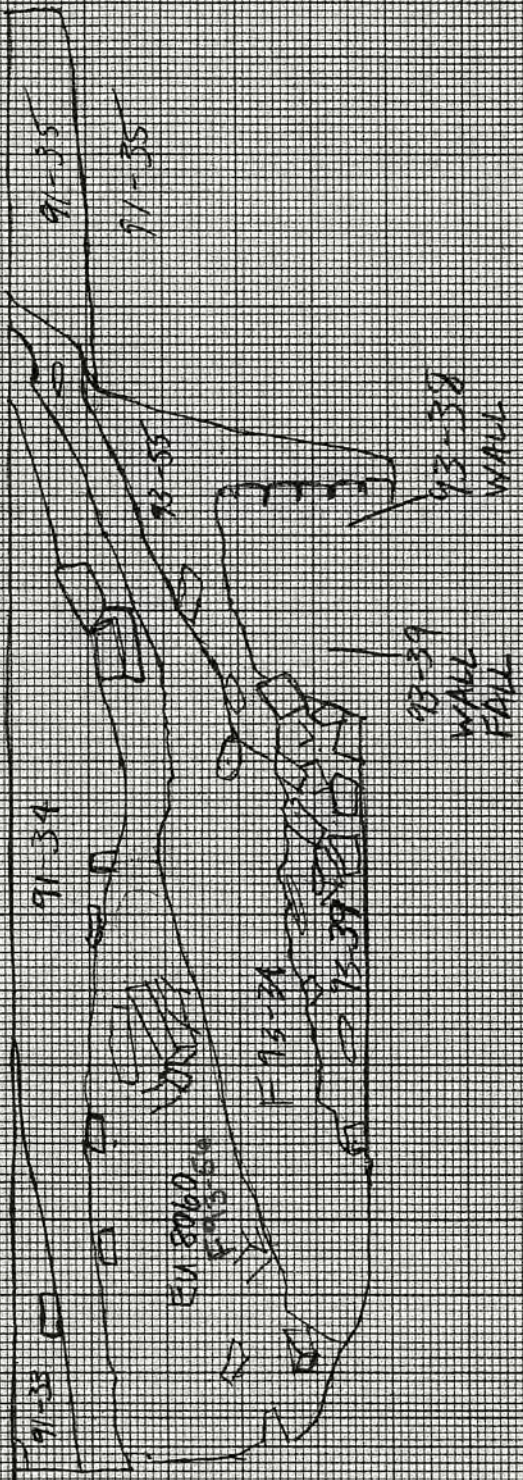

6/22/93

Tom CUDDY

TRENCH 93-1

PAGE 1 OF 2

bottom depth 1.27 m at 167.5N 167.5E

EM 8017

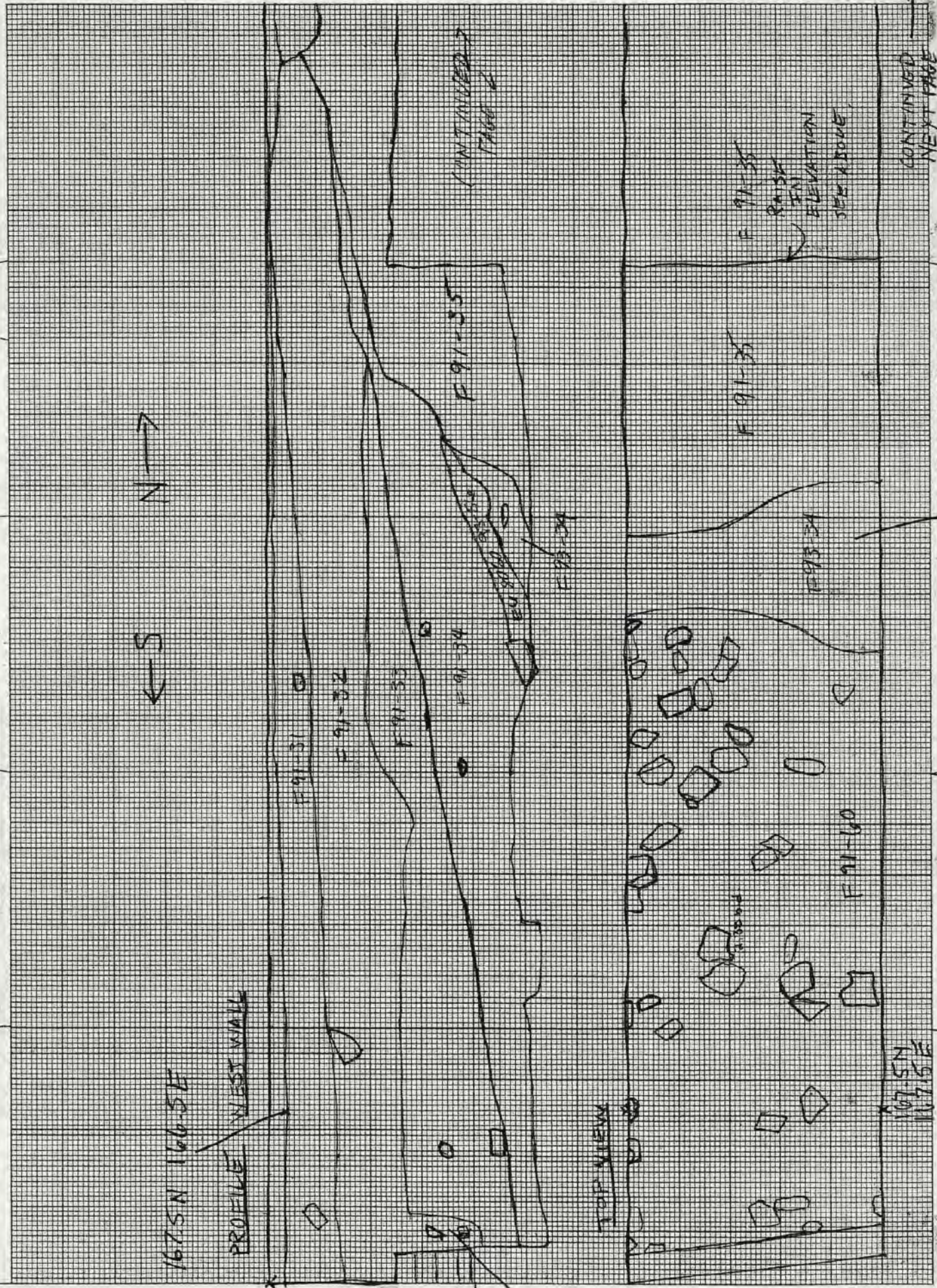

KEY

- F 91-31 KITCHEN FLOOR FILL, OVER LAYED BY FLOW BONE FEATURE CONTAINING BRICK PIECES, ROOF TILE PIECES, BONE GRASS AND A COUPLE PIPE SYSTEMS. BELIEVED TO BE FURTHER FILL FOR KITCHEN FLOOR.
- F 91-32 OLD STABLE SURFACE OF FILL OVER 17th CENTURY BUILDING. CONTAINED DAMAGED AREAS ABOVE WHICH INCLUDE BACON HOUSE BEARS AS ANOTHER BUILD UP OF FILL FOR KITCHEN FLOOR.
- F 91-33 MAIN FILL OVER 17th CENTURY BUILDING. SANDY YELLOWISH SOIL WITH BRICK FLECKING, ROOFING TILES, OCCASIONAL BONES AND A LOCAL MADE FIRE STEM. OVER LAYS WASH LENSES AND DEBRIS AND IS LIKELY ORIGINAL FILL TO LEVEL SURFACE.
- F 91-34 SERIES OF WASH LENSES OVER DESTRUCTION DEBRIS OF 17th CENT BUILDING. MIXED DARK AND LIGHT LAYERING WITH SOME DETAILS MIXED IN. SLUMPS OVER "HARRIS HOUSE".
- F 91-35 POSSIBLE SUBSOIL. HARD YELLOW CLAY. NO ARTIFACTS.
- F 93-11 CONJECTURAL EAST HOLE WITH BRICK FILLED MOLD. BRICKS WERE SLIGHTLY DEFORMED DOWN INTO 91-35. FOUND SMALL PIECES OF REFINISH STANDING. A PIECE OF FIBER WARE, A WOLF PLATE AND BONES ALL FOUND.
- EV 8017 BUILDERS TRENCH FOR SOUTH WALL OF KITCHEN.
- EV 8000 DESTRUCTION LAYER 91-00 FOUND IN TRENCH 93-1. 1641 PLAN WHITE DELFT SOME GOOD NAILS AND A LARGE METAL OBJECT FOUND BELIEVED TO BE 91-00.
- F 93-34 ROBBERS TRENCH, NORTH SIDE OF "HARRIS HOUSE"

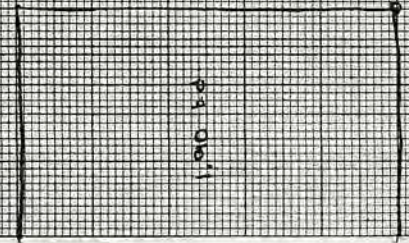
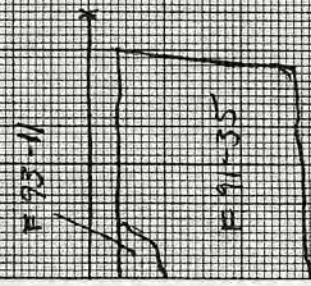

Return Apollo table from Transit 1.19

1 SQUARE = 2 CM.

* was first listed as F93-17, changed 7-13-93 ms

Feature Form

Site # 44HE388

Feature # 93-57

Exact Prov. 166.7 N 165 E

Type of Feature ^{2nd} bulldoz trench under window trench 93-1, under EU # 8021

Association F 93-1, F-60

EU Numbers 8046

Dimensions 7.5 cm deep

Excavation Notes: Include EU # used, portion excavated, soil conditions, artifacts recovered, other observations

Very sandy, very dense medium-brown loam. Only flecking in fill was small amount of brick. 1 pipestem (ball clay) frag found. Top and bottom of trench coincide w/ top and bottom of lowest course of footing in S. wall of kitchen (F-60). Some charcoal pos. found at bottom of trench.

Dated Started 6/18/93 Finished 6/21/93

Profiled _____ Plan Drawn _____ Photos _____

Samples Taken _____

Excavated by (All) G. LABUDE

- Form 2-93