

Feature Form

Site # 44 HE 388

Feature # 93-12

Block Prov. 170 N 170 E

Type of Feature yard midden, E + SE of Randolph Ditch, no definite guidelines

Association _____

EU Numbers 9039, 9042, 9045, 9050

Dimensions _____

Excavation Notes: Include EU # used, portion excavated, soil conditions, artifacts recovered, other observations - 9039 - HARD CRUSTY DARK BROWN TO LIGHT BROWN ORGANIC - ANOTHER "HOLLOW" SOUNDING PACKED, HARD SOIL BELOW.

BONE TOOTHBRUSH, BRASS CASING, PORCELAIN SHARD, MANY NAILS, PIPE STEM, GLAZED BRICK, 1 FLAT METAL CIRCLE W CENTER HOLE, ^{SMALL} PANE GLASS, ROOF TILES, 2- OLIVE GREEN BOTTLE GLASS, 2 SPIKES, 1 SMALL FOUL-WISHBONE, 1 BULLET, 2 EARTHEN WARE SHARDS - (GERMAN?) - SEVERAL UNIDENTIFIED METAL? OBJECTS, 1 LOCAL DARK-GLAZE, (BLUE/GREY)

Dated Started 06/20/94 Finished 06/21/94

Profiled _____ Plan Drawn _____ Photos _____

Samples Taken NO

Excavated by (All) M. Clayton

Feature Form
Continuation Sheet

Site 44HE388

Feature 93-39

Provenience several

Page 1 of 1

North wall fall of the Thomas Harris House
uncovered in Provenience Blocks

Left mostly intact in Block 167.5N 167.5E
~~removed from~~ cleared, photographed, left in place

removed from blocks 167.5 N 160 E / 167.5 N
162.5 E.

SCALE

1:2cm

KE 10 X 10 TO THE CENTIMETER KEUFFEL & ESSER CO. MADE IN U.S.A.

46 1510



44 HE 388

CHRIS GOSE & DAVID BELL

JULY 13, 1994

F94-30 (Pst)

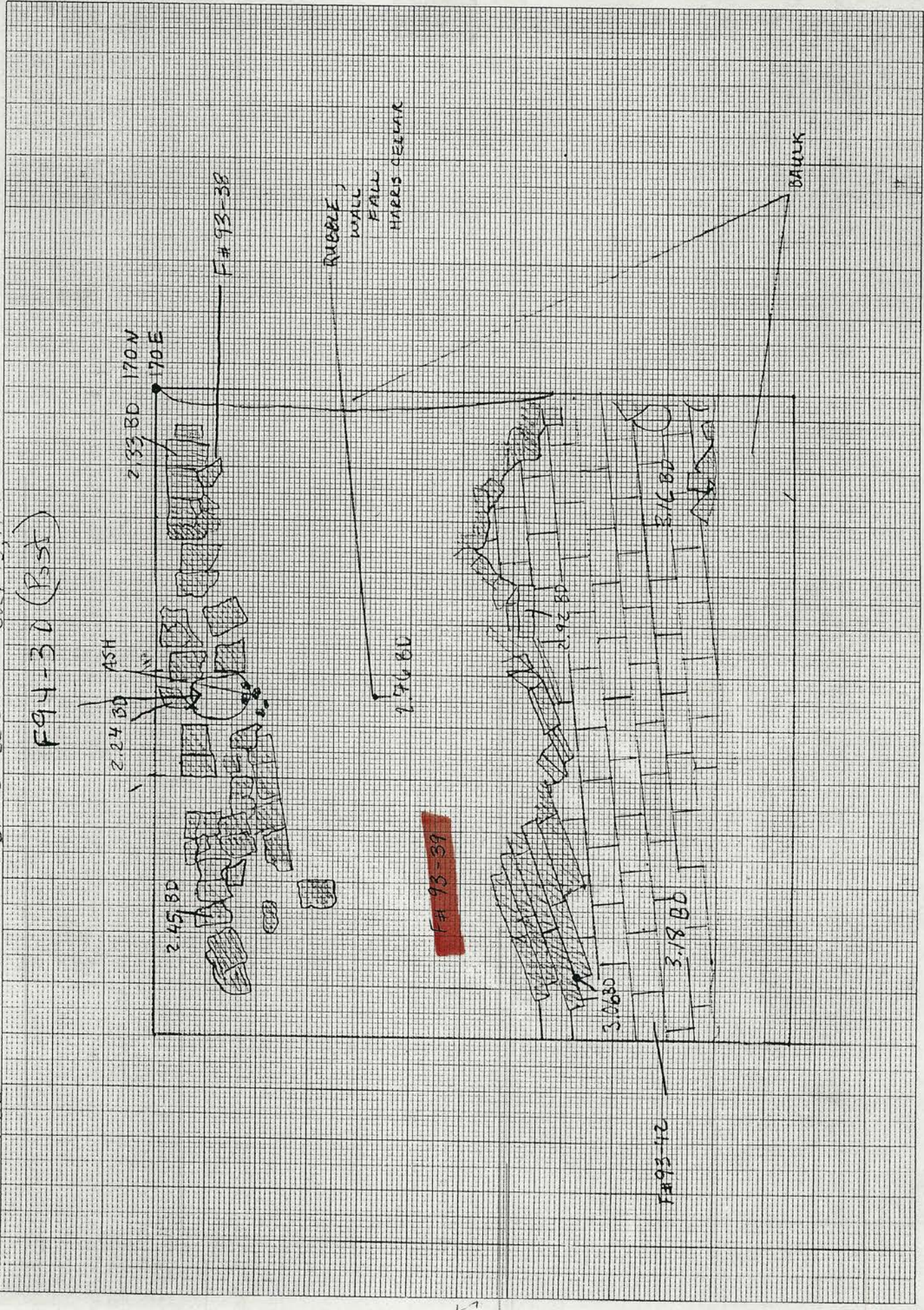

2.33 BD 170N
170E

2.24 BD ASH

2.45 BD

2.76 BD

2.92 BD

3.06 BD

3.18 BD

F#93-42

3.16 BD

F# 93-38

RUBBLE,
WALL
FALL
HARRIS CELLAR

BAULK

F# 93-39

P

Feature Form
Continuation Sheet

Site 44 HE388

Feature 93-38

Provenience Several

Page 1 of 1

Extract.

North wall of Harris house found in
blocks 167.5 N / 160, 162.5, and
167.5 E. Left in place.

1:4cm

K&E 10 X 10 TO THE CENTIMETER KEUFFEL & ESSER CO. MADE IN U.S.A.

46 1510



44 HE 388

HR. D8. DB. M

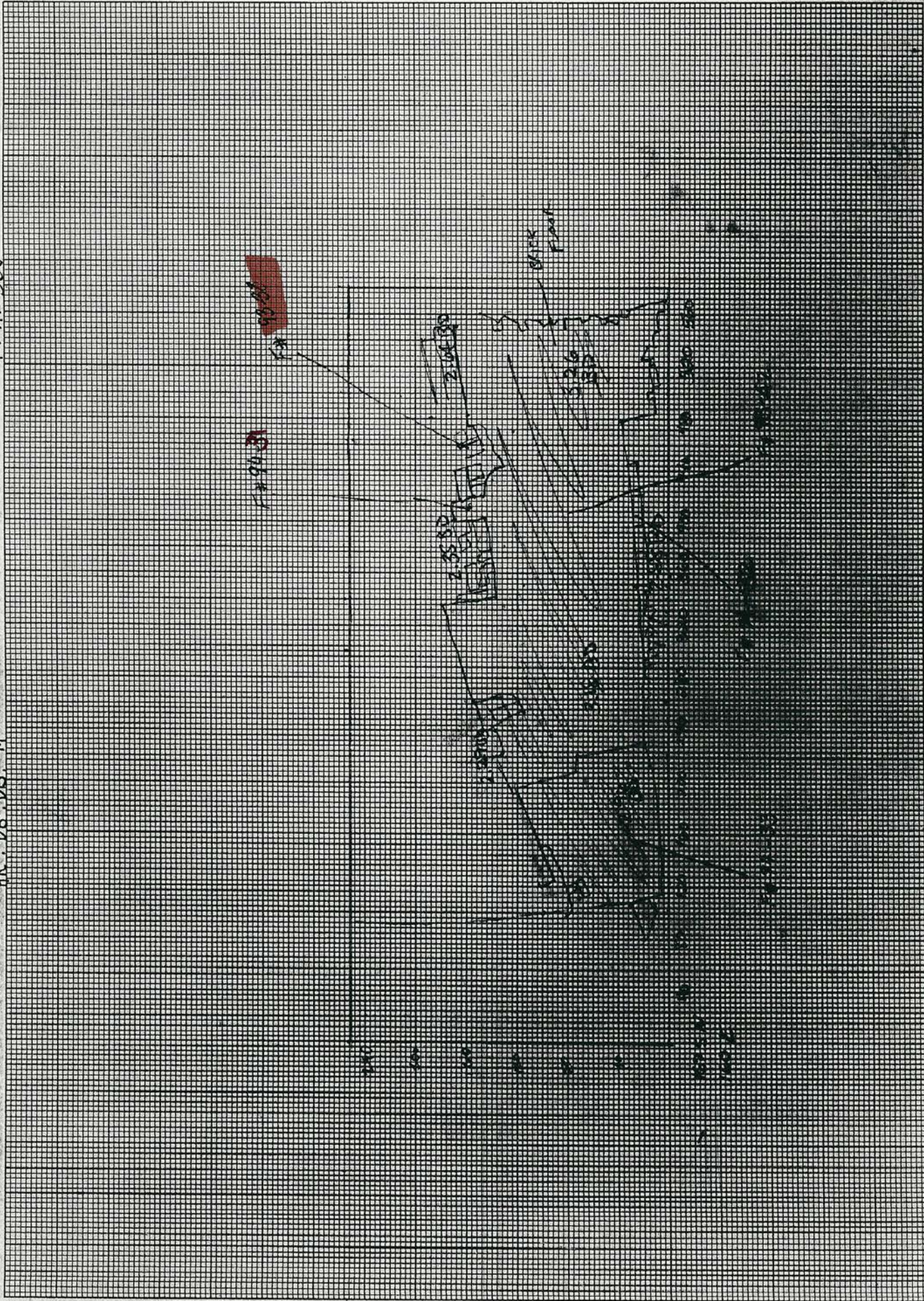

SCALE

1:2cm

K&E 10 X 10 TO THE CENTIMETER KEUFFEL & ESSER CO. MADE IN U.S.A.

46 1510



44 HE 398 CHRIS GOSE & DAVID BELL JULY 13, 1994

F94-30 (Post)

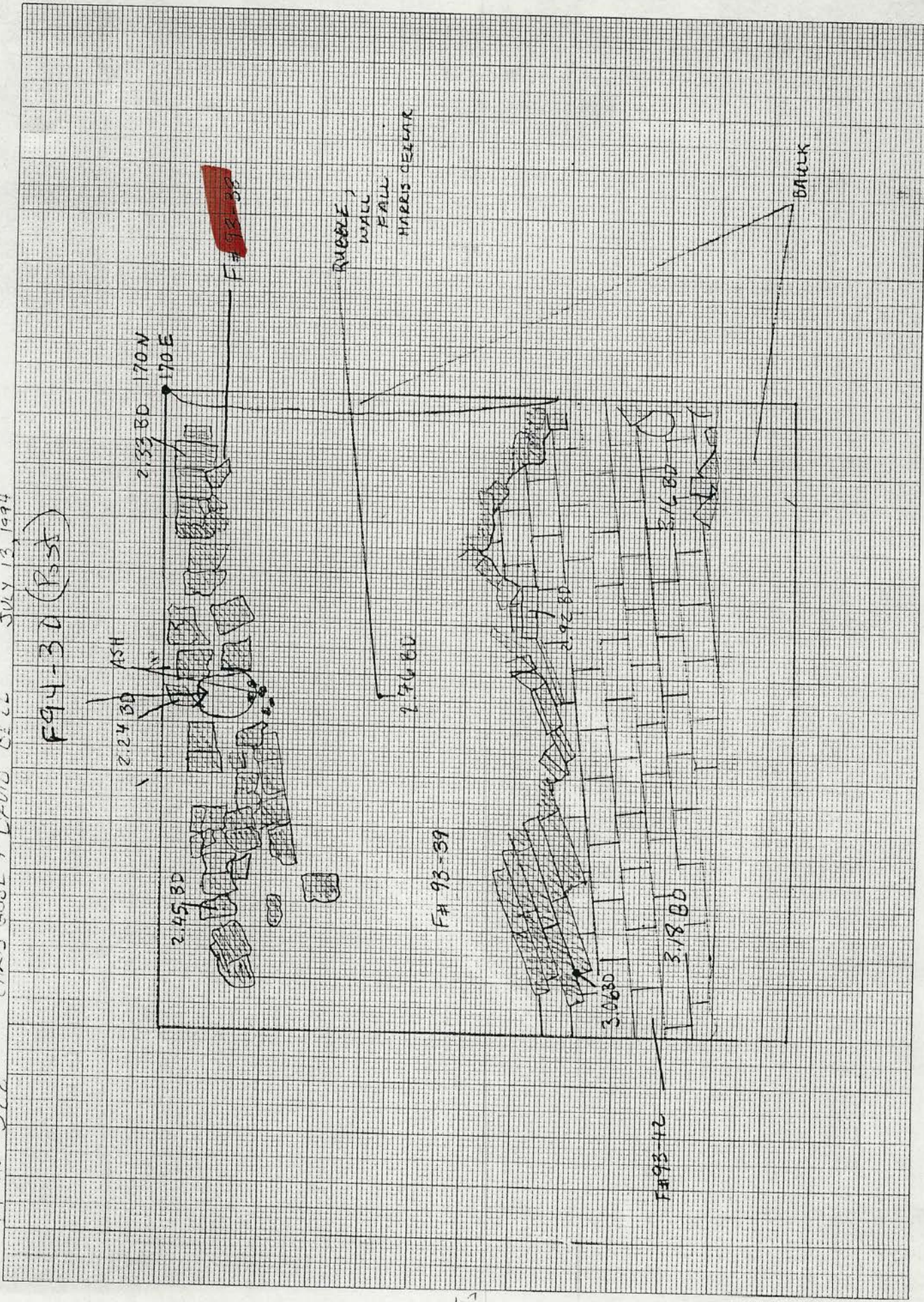

F# 93-32

RUBBLE WALL FALL HARRIS CELLAR

BACK

F# 93-39

F# 93-42

5

Feature Form

Continuation Sheet

44H5388

Site 93

Feature 93-42

Provenience Several

Page 1 of 1

Inadvertently used as feature number for Harris cellar floor in 1994 field school season. Should have been F#93-29
Back floor of Harris cellar. Uncovered in blocks (in tact) 167.5 N 167.5, 167.5 N
160 E, and 172.5 E. 167.5 N 162.5 E and ~~165 N~~
162.5 N

Note:

F93-42 used as
Floor # should be
93-29

Carly Worman
Lelia Miller

Cores 44 H.E.388

July 19, 1994 Scale 1:10cm

non-ferrous objects

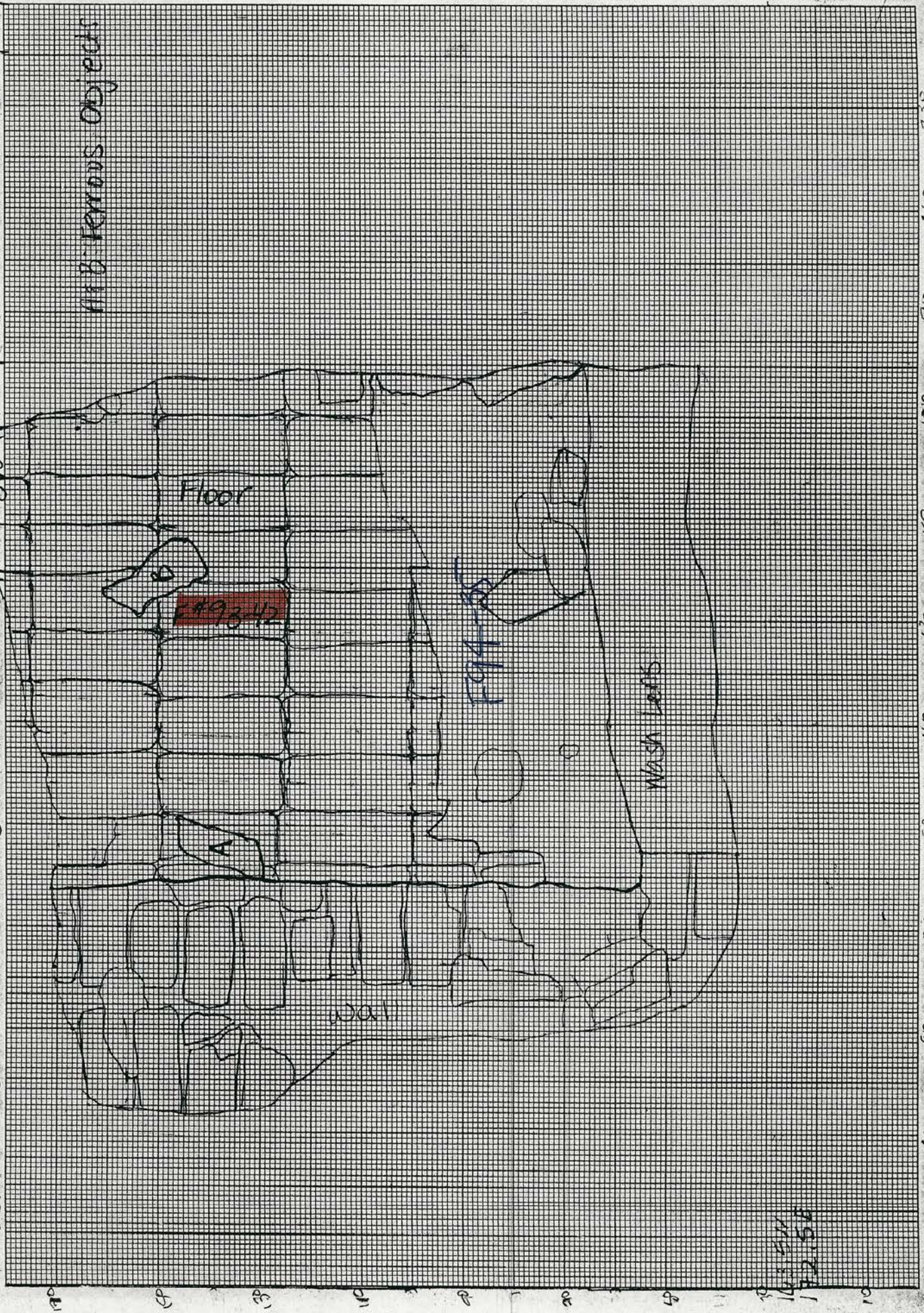

Southwest Corner Harris Cellar F# 93-42 (Floor) 107.5N 170E

1:4cm

K-E 10 X 10 TO THE CENTIMETER KEUFFEL & ESSER CO. MADE IN U.S.A.

46 1510

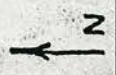

44 HE 388

HR. DB. DB. M

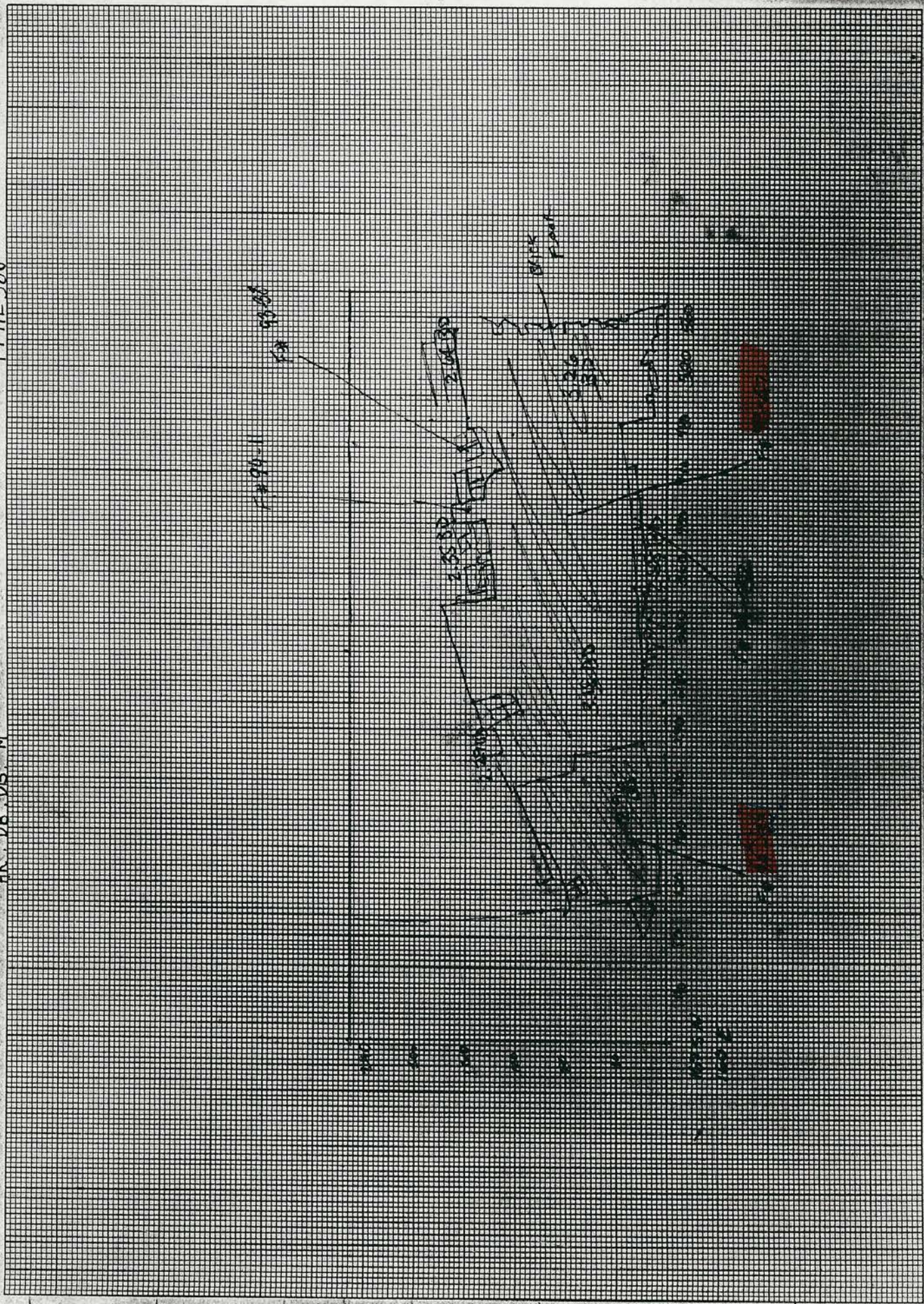

SCALE

1:2cm

K&E 10 X 10 TO THE CENTIMETER 18 X 25 CM KEUFFEL & ESSER CO. MADE IN U.S.A.

46 1510



44 HE 389

CHRIS GOSI + DAVID BELL

JULY 13 1994

F94-30 (Rest)

