

Form 1 of 2

# Feature Form

Site # 44HE388

Feature # 94-28

Exact Prov. 167.5 N 162.5 E  
167.5 N 160 E

Type of Feature Brick rubble from destruction of Harris cellar

Association \_\_\_\_\_

EU Numbers 9075 9082

Dimensions \_\_\_\_\_

Excavation Notes: Include EU # used, portion excavated, soil conditions, artifacts recovered, other observations

*Harris rubble on the cellar floor was approximately 30cm deep. Some of the bricks were still in laid form running parallel w/ each other. Others were laying in random order. There were also quite a few nails laying directly on the brick floor. There were layers of sand in between some of the bricks, suggesting that after the rubble fell it laid open for quite a while (wash lensing).*

Dated Started 7-5-94 Finished 7-13-94

Profiled YES Plan Drawn YES Photos YES

Samples Taken NO

Excavated by (All) Chris, Dave

Form 2 of 2

# Feature Form

Site # 44HE388

Feature # 94-28

Exact Prov. 167.5 N 162.5 E 165 E 165N  
165E

Type of Feature Brick rubble destruction of Hamsellar

Association \_\_\_\_\_

EU Numbers 9082, 9075, 9080, 9087

Dimensions \_\_\_\_\_

Excavation Notes: Include EU # used, portion excavated, soil conditions, artifacts recovered, other observations

Rubble was close to a meter thick. Much of the soil mixture had a heavy ash content. We filled three artifact bags - the vast majority of items were hand wrought nails. Also included were pipe stems - local or European, Robin's Egg Blue tin enamel, a few animal bones, sturgeon scales, some unidentified metal pieces.

full sized buckets

(120)

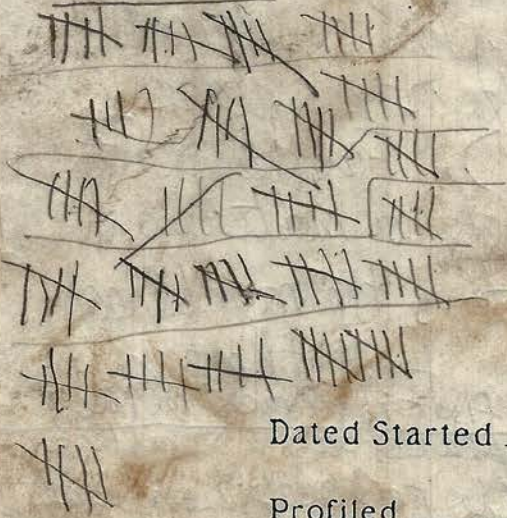

Dated Started 7-11-94 Finished 7/21/94

Profiled \_\_\_\_\_ Plan Drawn \_\_\_\_\_ Photos \_\_\_\_\_

Samples Taken \_\_\_\_\_

Excavated by (All) Disha, Dale

(approx 97 cm wide; the walls on each side of the door are 2 bricks thick)

case bottle glass. In the northern half of prov. square 167.5 N, 160 E, we revealed a doorway to the Harris house. In the strip where this apparently existed, the soil was rich with ash. We also pulled the door's lock plate from this spot. (pockets of marine clay, a wedge, and

Some brick rubble was mortared and it is believed that this was a result of chimney fall. Apparently, there was a chimney in prov. square 167.5 N 165/167.5 E. It is possible that this chimney fell west into prov. square 162.5 E.

However, another feature which manifested in this section (167.5 N 162.5 E) is a low short wall running east-west along the south edge of the square.

(4 bricks high, approx 150 cm long). Further south (162.5/165 N, 162.5 E) there exists a matching wall. If this feature was a hearth, the mortared brick could have reflected chimney fall that had been connected to this hearth.

The floor is terraced in line with this wall. The other features which appeared as a result of the rubble's removal are the north wall (brick nauged) of the Harris house (2) the Harris floor; and (3) a floor further west (prov. square 167.5 N 160 E) which is elevated. This floor is 12.5 cm higher than the level east of it. The bricks sit on top of dirt; there is no other brick layer beneath it.

Dale Bishop  
Brick Rubble  
05/29/94

Slope = 3:1

41WE387

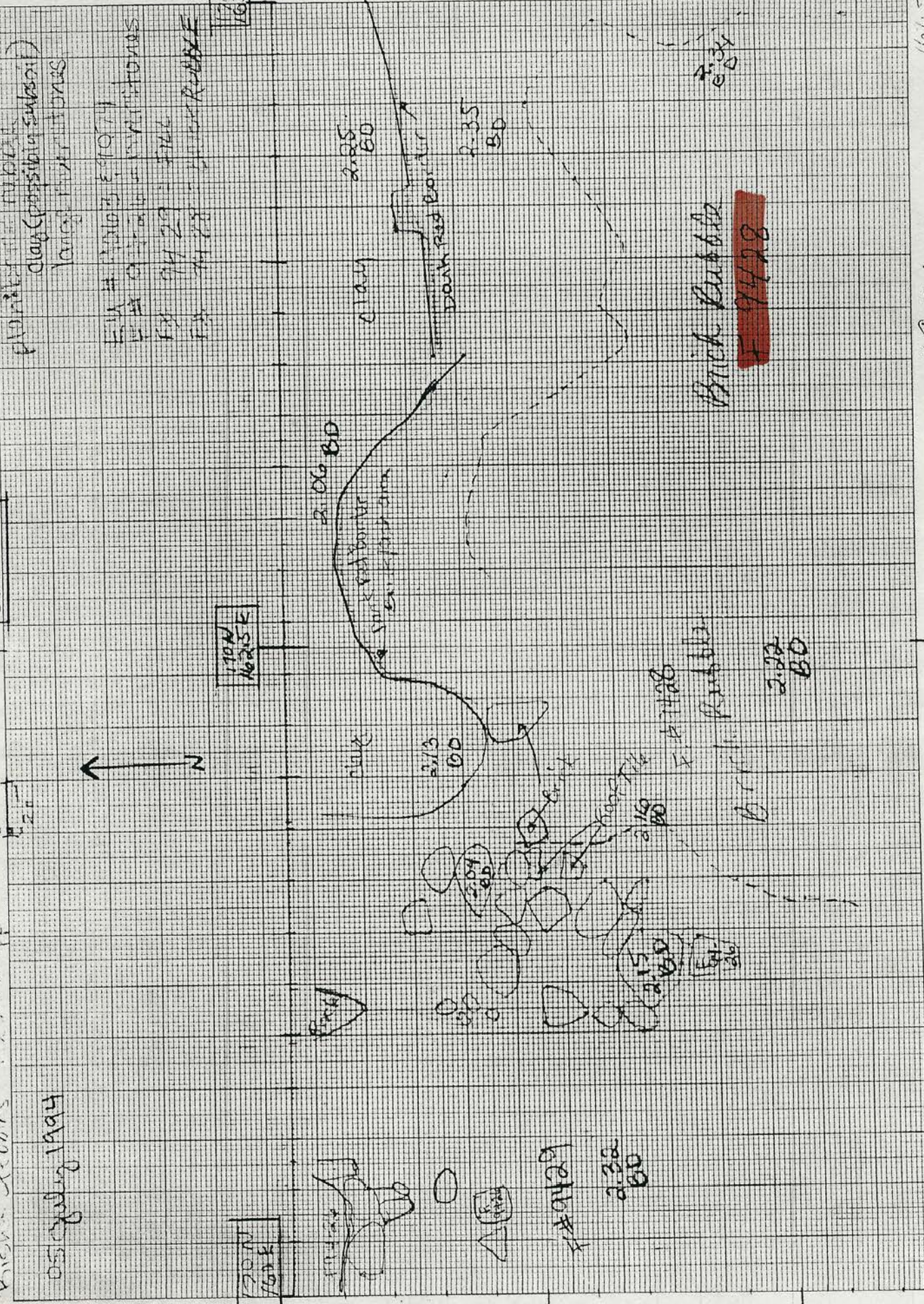

Feature Form

Site # 44HE388

Feature # 94-E9

Exact Prov. 167.5N 140E

Type of Feature sand wash lenses + 2 discrete ash lenses

Association of Karns rubble F94-28 F94-24 Baum's Ditch? under F94-17

EU Numbers 9078, 9088

Dimensions \_\_\_\_\_

Excavation Notes: Include EU # used, portion excavated, soil conditions, artifacts recovered, other observations

This fill had several layers. On top was a very sandy layer that was extremely variegated and very soft. Towards the bottom of the layer there were pockets of grey soil with lots of ash. They were similar to what was in the next layer but were not high spots. The next layer down was greasy ash fill. The top two layers were full of artifacts - a stoneware bowl, pipe stems (local + ball clay), lots of nails +

Dated Started 7/7/94 Finished 7/13/94

Profiled no Plan Drawn no Photos yes

Samples Taken no

Excavated by (All) Ted & Kathy

roofing tiles, some westward, tin-  
enamelled. The next layer down was  
a medium brown with charcoal +  
brick flecks and was a little bit  
harder to dig. Beneath that was  
more sandy wash lens. There were  
very few artifacts in these 2 layers.  
Beneath that was subsoil.

Excavated by (All)  
Samples Taken  
Plan Drawn  
Photos  
Dated Started  
Finished

CURLES

46 1510

UH HE 388

SUMMER '94

JULY 15, 1994

MC

NORTH PROFILE - BROWN'S TRENCH  
167.5 N - 100 E / 167.5 N - 162.5 E

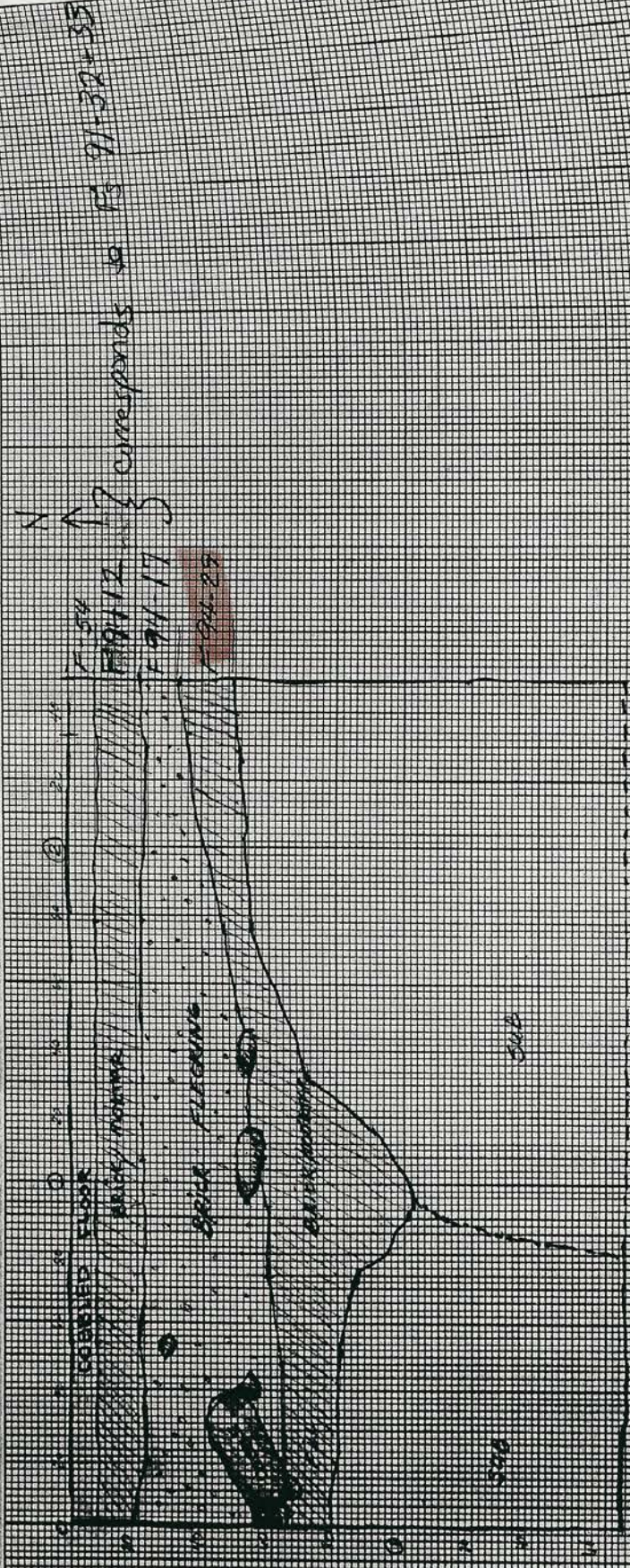

K&E 10 X 10 TO THE CENTIMETER 18 X 25 CM  
KEUFFEL & ESSER CO. MADE IN U.S.A.

CURLES

451510

WHEE388  
SUMMER '94

JULY 15, 1994  
MC

EAST PROFILE - BARON'S TRENCH  
107.5 N - 160 E

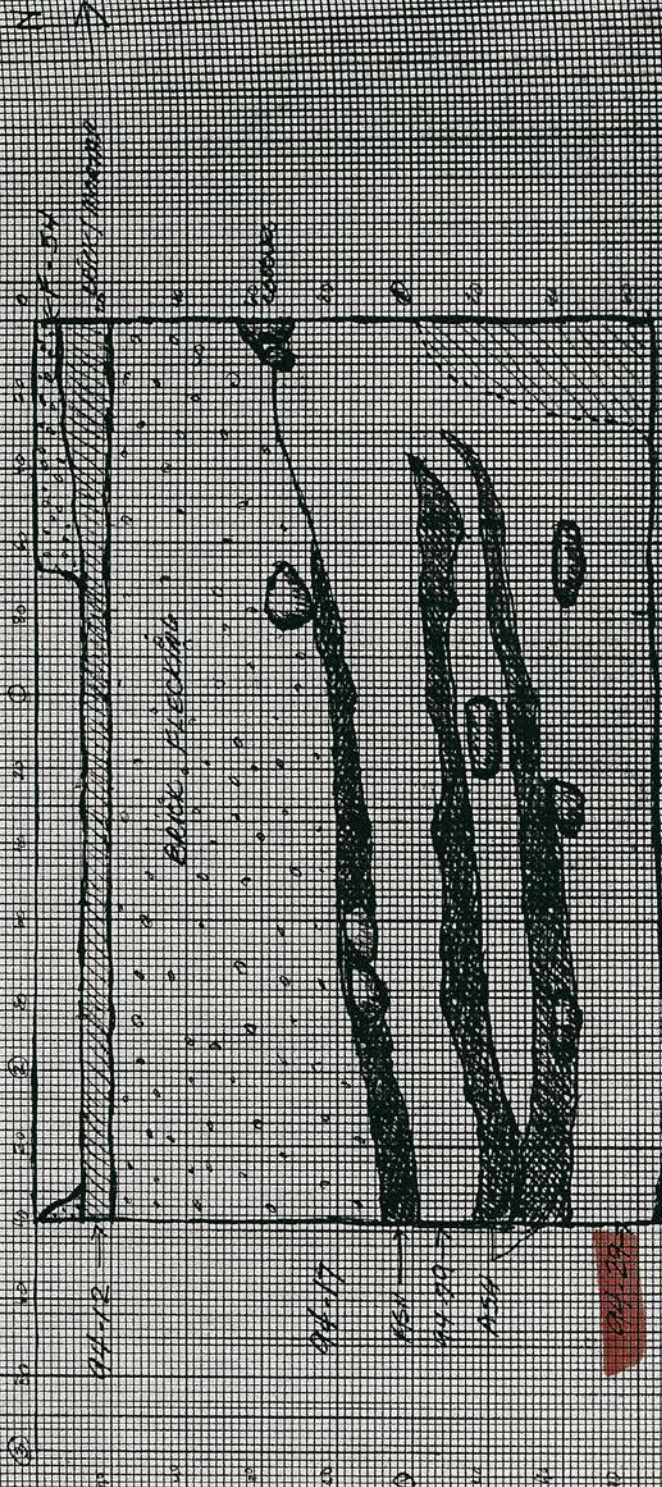



46 1510

18 X 25 CM KEUFFEL & ESSER CO. MADE IN U.S.A.

Dale & Snop  
Buck's floors  
05/29 July 1994

Scale = 2:1

41 KE 222

FLORIDA  
clay (possible subsoil)  
large FLUTATIONS  
EU # 9403 E91074  
F # 9428 E911074  
F # 9429 E911074  
F # 9428 - HOUSE RUMBLE  
701  
165 E

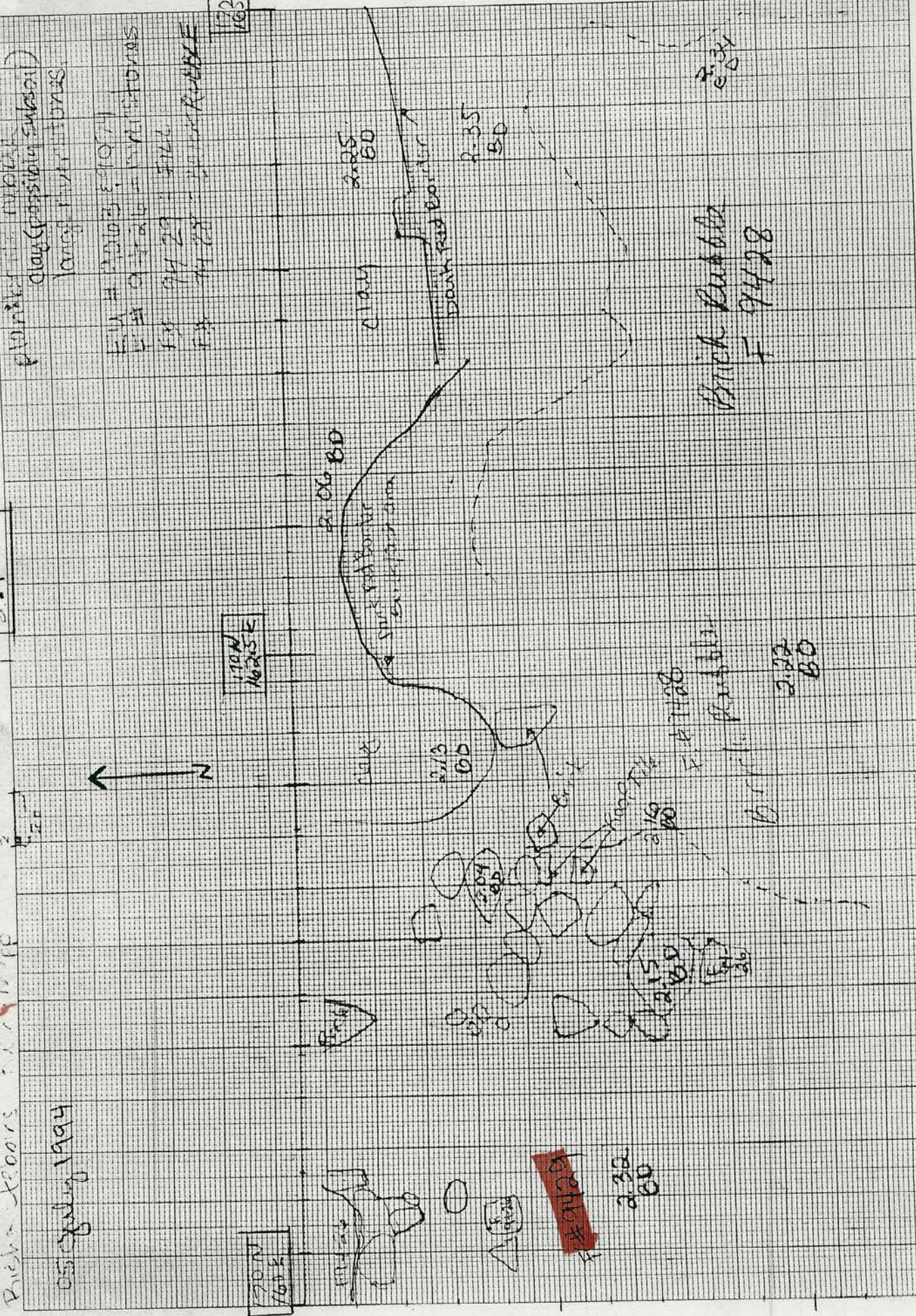

FU#9074

161.5 N

161.5 N

Feature Form

Site # 44HE388

Feature # 94-36

Exact Prov. 169.75N 168.3 E

Type of Feature post hole or post mold in north wall Ham's note

Association \_\_\_\_\_

EU Numbers 9089

Dimensions \_\_\_\_\_

Excavation Notes: Include EU # used, portion excavated, soil conditions, artifacts recovered, other observations

Soil layers probably aren't accurate hole was exposed since beginning of excavation of 167.5 N 167.5 E. Soil is from upper layers of excavation. Post hold completely encased in brick. Artifacts included are one nail found near top and one bone near bottom. Hole is approx 82cm deep by 18cm wide - can excavate no further.

Dated Started 7-15-94 Finished 7-15-94

Profiled yes Plan Drawn \_\_\_\_\_ Photos \_\_\_\_\_

Samples Taken no

Excavated by (All) Daniel Bell

scale  
: 1cm

K+E 10 X 10 TO THE CENTIMETER  
KEUFFEL & ESSER CO. MADE IN U.S.A.

46 1510

44HE388

Kelly Stenman

July 15, 1994

F#94-30

N ↑

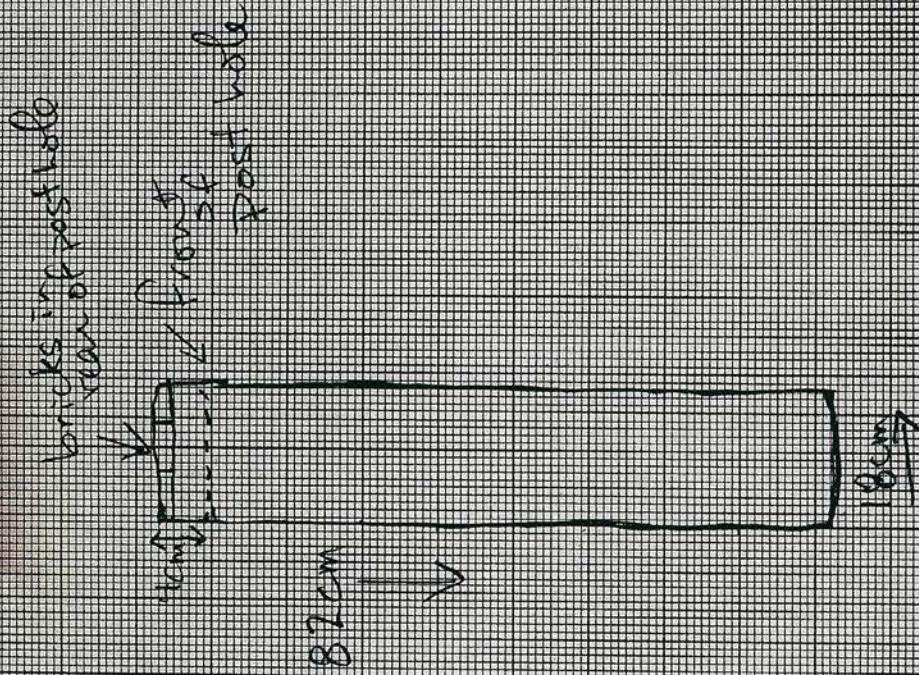



44 HE 388

JULY 13, 1994

CHRIS GOSE & DAVID BELL

F94-30 (Psst)



170N  
170E

F# 93-38

RUBBLE  
WALL  
HARRIS CELLAR

DRAIN

2.92 BD

F# 93-39

3.06 BD

3.18 BD

3.16 BD

2.45 BD

2.24 BD

2.33 BD

ASH

F# 93-42

Feature Form

Site # 44HE388

Feature # 94-33

Exact Prov. 167.5 N  
160 E

Type of Feature Raised brick section of Harris Floor (cellar)

Association \_\_\_\_\_

EU Numbers \_\_\_\_\_

Dimensions \_\_\_\_\_

Excavation Notes: Include EU # used, portion excavated, soil conditions, artifacts recovered, other observations

1 brick thick brick platform set on dirt 12.5 cm. higher than rest of brick floor. Platform appears to be slightly skewed from the rest of the floor.

Dated Started \_\_\_\_\_ Finished \_\_\_\_\_

Profiled \_\_\_\_\_ Plan Drawn 7/22/94 Photos \_\_\_\_\_

Samples Taken \_\_\_\_\_

Excavated by (All) \_\_\_\_\_

1:4cm

K+E 10 X 10 TO THE CENTIMETER KEUFFEL & ESSER CO. MADE IN U.S.A.

46 1510

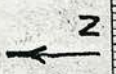

July 22, 1994

44 HE 388

Curtis

HR. DB. DS. M

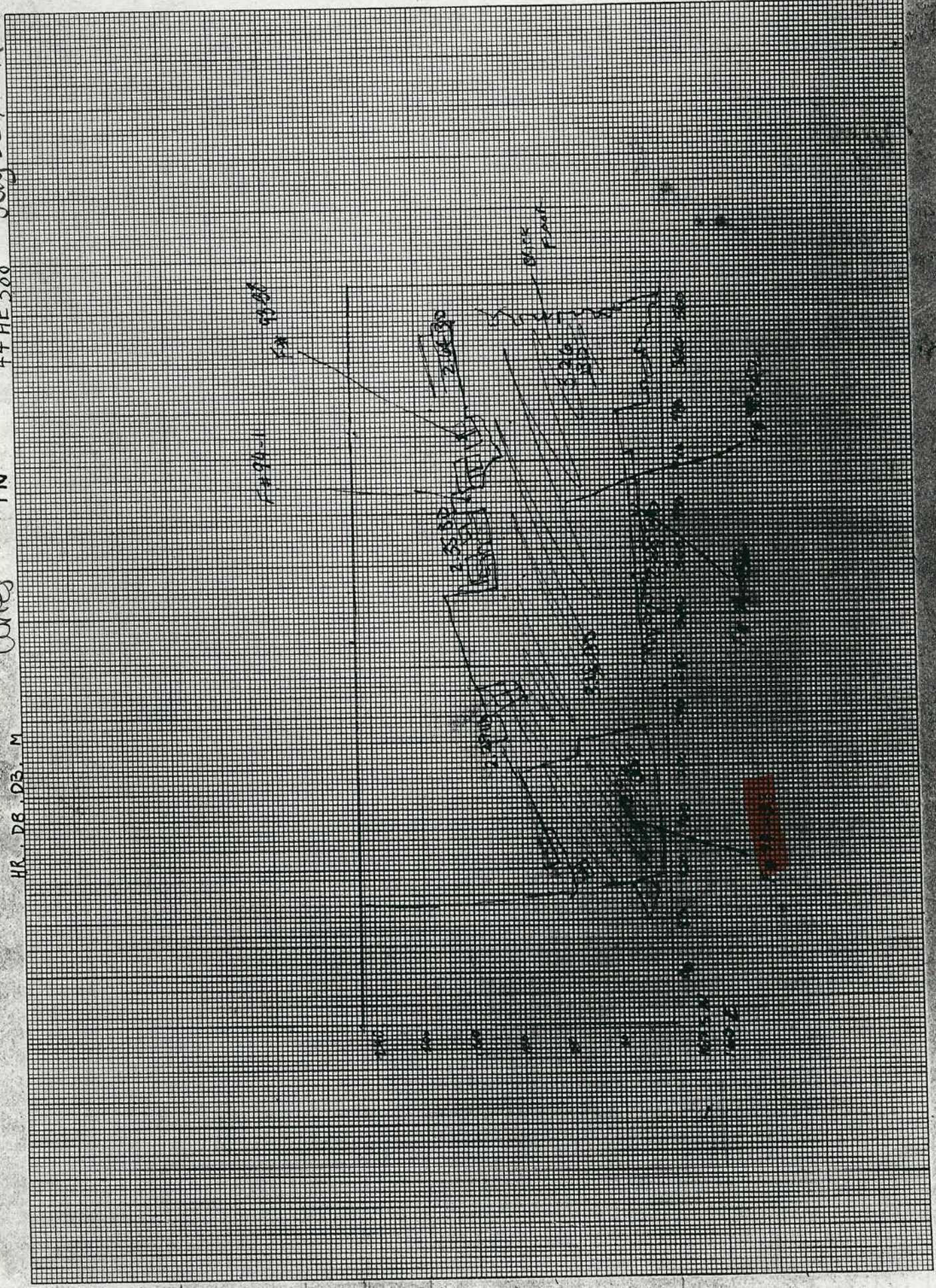

C

Feature Form

Site # 4-HE388

Feature # 94-35

Exact Prov. 1625 N 170 E

Type of Feature East wall of Humns house.

Association \_\_\_\_\_

EU Numbers \_\_\_\_\_

Dimensions \_\_\_\_\_

Excavation Notes: Include EU # used, portion excavated, soil conditions, artifacts recovered, other observations

Rubble filled linear stain parallel to flow

Dated Started \_\_\_\_\_ Finished \_\_\_\_\_

Profiled \_\_\_\_\_ Plan Drawn \_\_\_\_\_ Photos \_\_\_\_\_

Samples Taken \_\_\_\_\_

Excavated by (All) \_\_\_\_\_

K&E 10 X 10 TO THE CENTIMETER KEUFFEL & ESSER CO. MADE IN U.S.A.

46 1510

Carly Worman  
Lettmiller

Curves 44 HE388

July 19 1994

Scale 1:10 cm

All ferrous objects

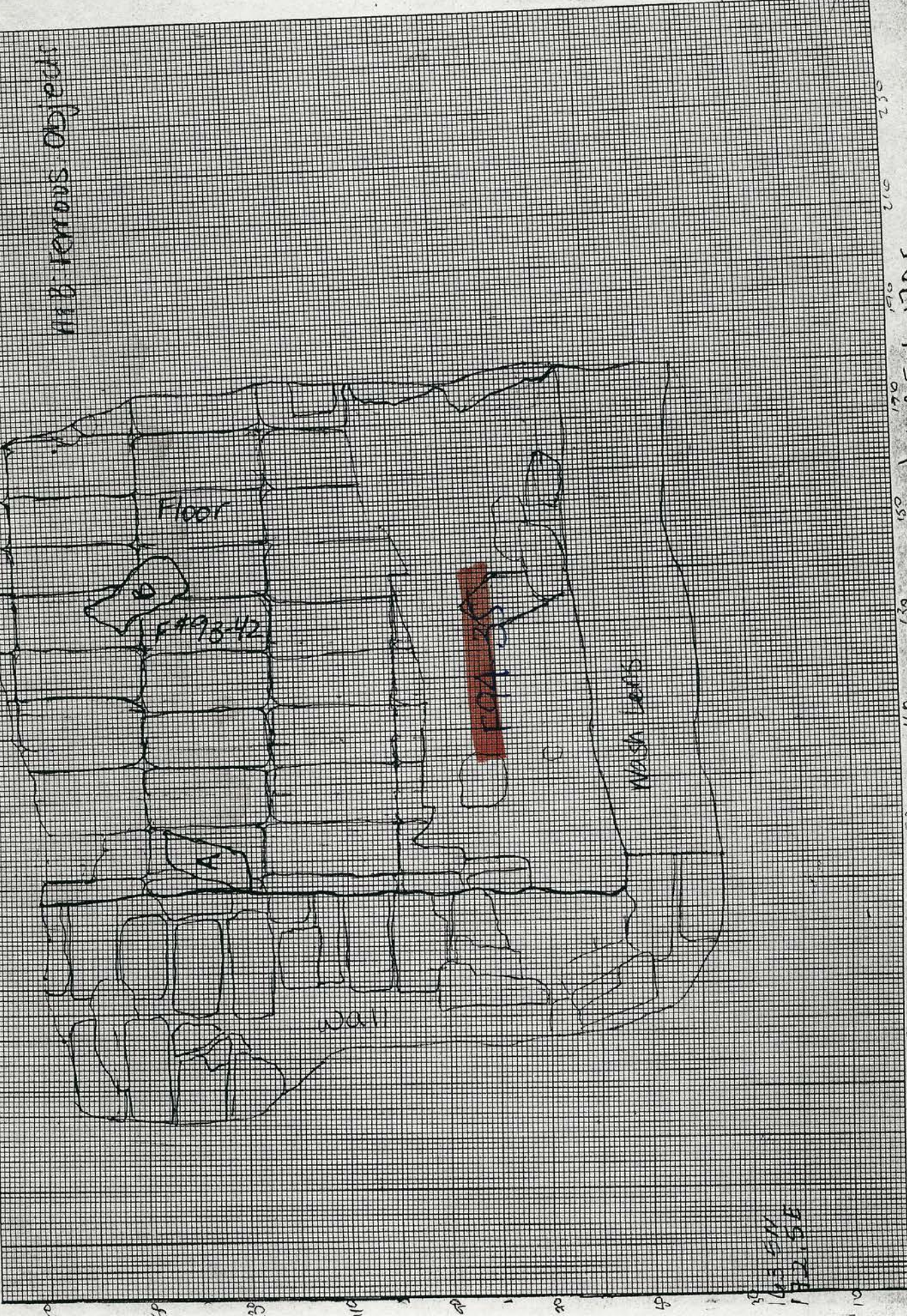

103.5N  
172.5E

F# 93-42 (Floor) 162.5N 170E

Southwest Corner Harris Galloway



Feature Form

Site # 44HE38E

Feature # 49 (tag)

<sup>Exact</sup>  
Block Prov. 170 N 171 SE

Type of Feature "dog wallow" under E. porch of Randolph hitcher

Association porch remains 94-2

EU Numbers S. bisection - 9016

Dimensions \_\_\_\_\_

Excavation Notes: Include EU # used, portion excavated, soil conditions, artifacts recovered, other observations

small shallow pit chock full mortar, + broken bricks  
Northern half bisected in a previous yr. Could find no  
paper pertaining to this bisection.

1994 - removed South bisection

Dated Started unknown Finished \_\_\_\_\_

Profiled \_\_\_\_\_ Plan Drawn \_\_\_\_\_ Photos \_\_\_\_\_

Samples Taken \_\_\_\_\_

Excavated by (All) \_\_\_\_\_

K+E 10 X 10 TO THE CENTIMETER KEUFFEL & ESSER CO. MADE IN U.S.A.

PLAN MAP OF RANDOLPH KITCHEN PORCH AREA (EAST)

F-91-16  
F-94-2  
F-59  
F-49

46 1510

6-13-94

DAVID BELL & HOUSTON ROGERS

Scale 1" = 2cm

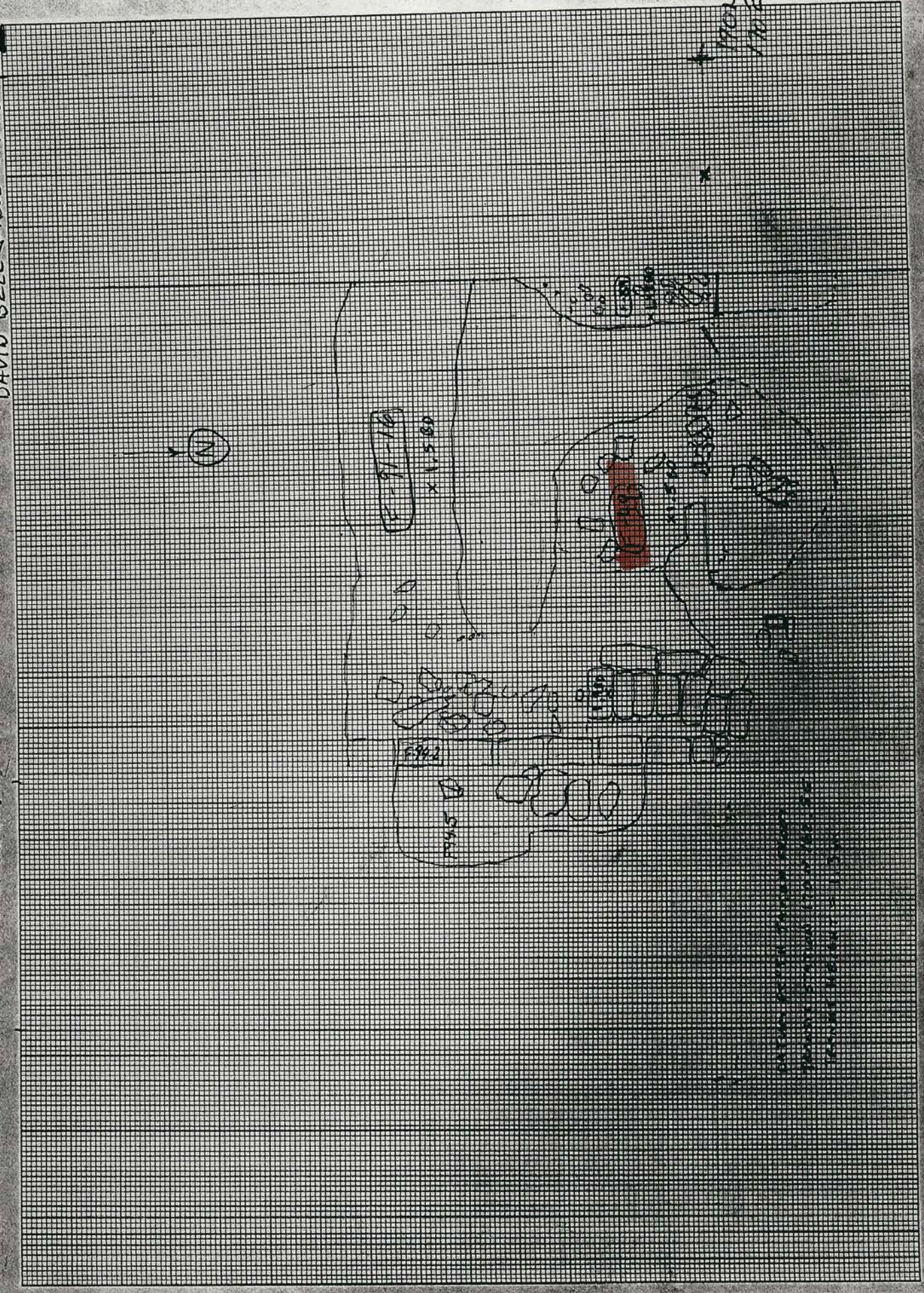

Feature Form  
Continuation Sheet

Site 44HE388

Feature 54

Provenience Several  
~~167.5 N 162.5 E~~

Page 1 of 1

Cobble floor inside kitchen, main room.  
Removed from blocks 167.5 N 162.5 E,  
167.5 N 162.5 E. Concentrated cobbles &  
gravel in medium brown loam.

EU#s - 9017, 9021, 9027

K&E 10 X 10 TO THE CENTIMETER 18 X 25 CM  
KEUFFEL & ESSER CO. MADE IN U.S.A.

CURLES

EAST PROFILE - BROWN'S TRENCH  
107.5 N - 160E

461510

Y4HE388  
SUMMER 94

JULY 15, 1994  
MC

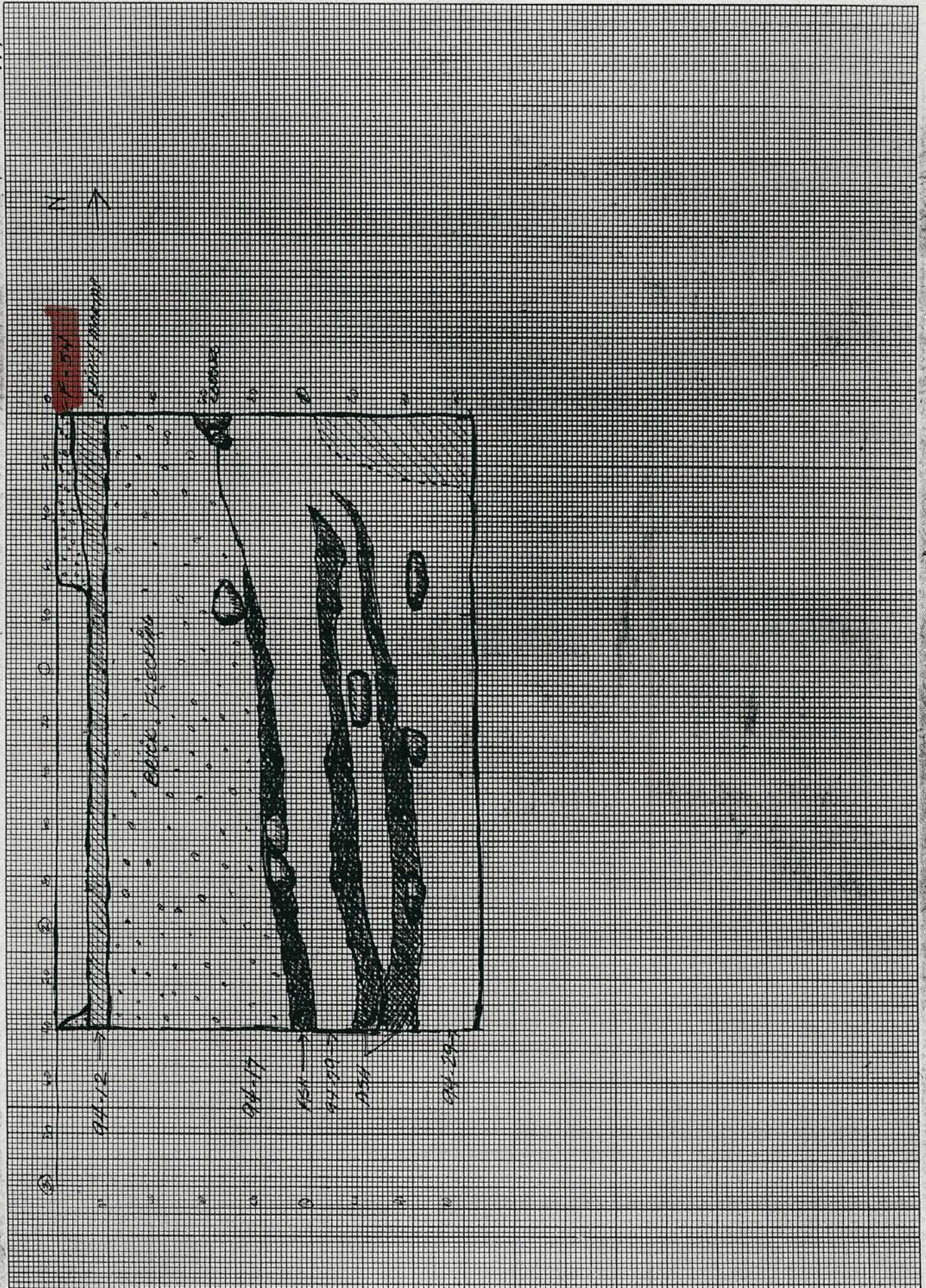

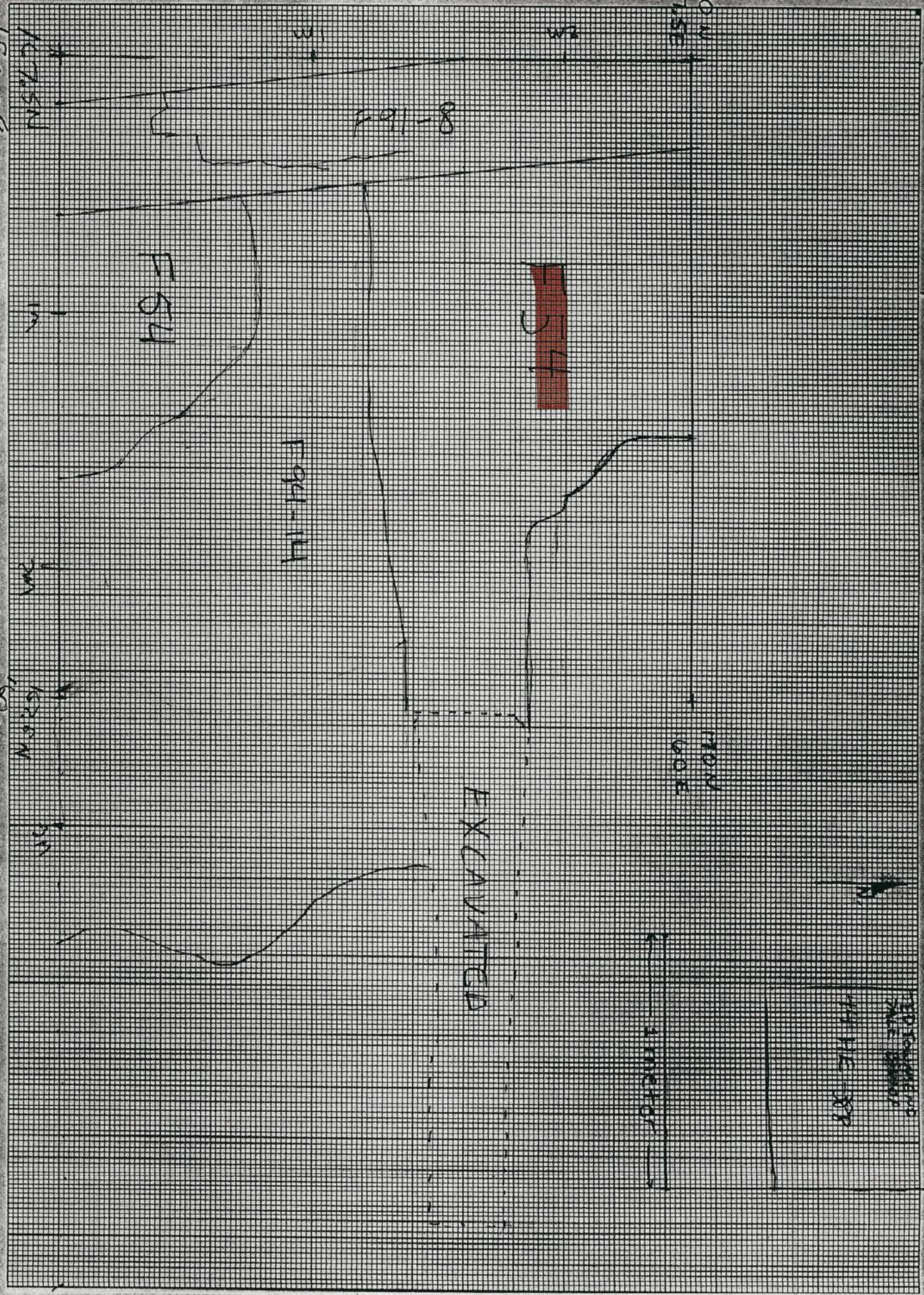

46 1510

K&E 10 X 10 TO THE CENTIMETER KEUFFEL & ESSER CO. MADE IN U.S.A.

K&E 10 X 10 TO THE CENTIMETER KEUFFEL & ESSER CO. MADE IN U.S.A.

CURLES

46 1510

HH HE 388

SUMMER '94

JULY 15, 1994

MC

NORTH PROFILE - BROWN'S TRENCH 167.5 N - 168 E / 162.5 N - 162.5 E

